



G



R



O



W

YOUR ADVENTURE

NACTA CONFERENCE, IOWA STATE UNIVERSITY

JUNE 12-15, 2018

THANK YOU TO OUR SPONSORS

Gold Sponsor

DowDupont
CHS Foundation
ISU College of Agriculture and Life Sciences

Silver Sponsor

USDA Teaching Section

Bronze Sponsor

Farm Credit Services of America
ISU Department of Agricultural Education and Studies
ISU Department of Animal Science
ISU Department of Horticulture
Land O'Lakes, Inc.

Poster Sponsor

ISU Department of Agronomy
Monsanto, Co.

Banquet Sponsor

ISU Department of Economics

Break Sponsor

ISU Department of Agricultural & Biosystems Engineering
ISU Department of Genetics, Development & Cell Biology

TABLE OF CONTENTS

NACTA 2018

1-2

SPEAKERS

Welcome.....1
Keynote.....2
Blue Ribbon.....2

3-5

COMMITTEES

NACTA Officers & Directors.....3
Committee Chairs & Liasons.....4
Local Organizing.....5

6

SCHEDULE AT-A-GLANCE

June 12-16, 2018

7

TUESDAY

Detailed Schedule.....7
ISU Campus Scavenger Hunt.....7

8-14

WEDNESDAY

Detailed Schedule.....8
Oral Presentations.....9-14
ISU Alumni Reception.....14
Dinner at Reiman Gardens.....14

15-22

THURSDAY

Detailed Schedule.....15-16
Oral Presentations.....17-19
Workshops.....20-21
Tours.....22

23-27

FRIDAY

Detailed Schedule.....23-24
Oral Presentations.....25-27

27

SATURDAY

Detailed Schedule

28-36

POSTERS

Poster Layout Map.....28
Poster Session 1 (Wed.).....29-32
Poster Session 2 (Fri.).....33-36
NACTA 2019.....36

37-41

MAPS

Scheman and Hotels.....37
Scheman and Dublin Bay.....37
Scheman Interior.....38
Scheman Parking.....39
Reiman Gardens.....40
Gateway Hotel.....41

WELCOME



Joe Colletti, Interim Dean
Iowa State University College of
Agriculture & Life Sciences

Welcome to the 64th annual NACTA conference! We are pleased to welcome you to Ames, Iowa, for this important gathering. Thank you for your scholarly contributions to advancing our critically important education programs and to the professional development of your fellow agricultural educators.

“Grow Your Adventure” is your conference theme and it’s our promise to students enrolling in the College of Agriculture and Life Sciences at Iowa State University. Iowa State’s agricultural education and research programs are world-renowned, ranked in the top 4 percent among 301 agricultural and forestry programs worldwide by QS World University Rankings. And our agricultural engineering programs lately have been enjoying the view from atop U.S. News & World Report’s rankings.

Students are our top priority. Our faculty work every day to spark interest both in the classroom and through meaningful experiences outside the classroom. The result: We graduate leaders and innovators — civic-minded, globally oriented, scientifically grounded and well-prepared to tackle society’s biggest challenges.

That’s what we do at Iowa State and what you do at your home institution. All of us enable students to explore exciting, make-a-difference careers. We broaden students’ perspectives by introducing them to new experiences, ideas, people and cultures.

The commitment shows. In the past 12 years, our college undergraduate enrollment has increased 88 percent, including 5 straight years of record enrollments. The College of Agriculture and Life Sciences leads the rest of Iowa State’s campus in many retention and graduation rate categories. Our new placement rate for recent graduates exceeds 99 percent — an historical first. About 65 percent of our new grads begin their careers in Iowa — a perennial pride point for us and another reason we point to the state’s investment in higher education truly as an investment in the state’s future.

My thanks goes to our hard-working conference organizing committee chaired by Ann Marie VanDerZanden. Last fall we were pleased to celebrate with Dr. VanDerZanden on her USDA National Excellence in Teaching Award. Her honor was our ninth recipient of these national and regional teaching honors in the past 11 years.

Welcome to Iowa State and enjoy the conference! Enjoy your adventure!

A handwritten signature in black ink that reads "Joe P. Colletti". The signature is written in a cursive, slightly stylized font.

Joe Colletti
Interim Endowed Dean
College of Agriculture and Life Sciences
Iowa State University

KEYNOTE SPEAKER



Scott Siepker, Iowa Nice Guy

Scott Siepker is an actor, writer, producer, and filmmaker. Scott started off as a stage actor at Iowa State University, where he received his bachelor degree in psychology. Scott has gone on to co-found the film company, Iowa Filmmakers, which has been responsible for the Iowa Nice series of hit videos that included a two season run on ESPN's College Football Daily. Though Scott is best known for his work as the Iowa Nice Guy, he is a versatile, veteran actor of stage and screen, drama and comedy.

BLUE RIBBON SPEAKER



Rick Parker

You Still Teach?

Dr. R. O. (Rick) Parker earned his undergraduate degree from Brigham Young University in Utah, a Ph.D. in Reproductive Physiology from Iowa State University, and completed post-doctoral work at the University of Alberta, Edmonton, and the University of Wyoming, Laramie. He is currently the Journal Editor for NACTA (North American Colleges and Teachers of Agriculture), the president of the National Agricultural Institute, and a part-time instructor for the College of Southern Idaho (CSI). He is the past director for AgrowKnowledge, the National Center for Agriscience

and Technology Education, a project funded by the National Science Foundation. As a former division director (1985–2004) at CSI, he worked in agriculture, information technology, drafting, and electronics, and taught computer, agriculture, and writing classes. In 1992, he received an Honorary State FFA Degree from Idaho and then in 2005 he received an Honorary American FFA Degree at the 78th National FFA Convention. From 2005 to 2008 he served as a board member of The National Council for Agricultural Education (The Council). He is the 2008 recipient of the NACTA Distinguished Educator Award, and the 2010 recipient of the NACTA Murray Brown Leadership Award. Dr. Parker has authored several Cengage titles (Plant & Soil Science, Aquaculture Science, Equine Science, Introduction to Plant Science, Introduction to Food Science & Food Systems, and others). Also, he created and edited a series of agricultural textbooks called "Just the Facts."

He and his wife of 49 years, Marilyn, are a team. Since 1999, their team work has included the Secretary/Treasurer and the Journal Editor for NACTA. They live in Rupert, Idaho. Rick and Marilyn the parents of eight children and grandparents of 27.

NACTA **OFFICERS & DIRECTORS**

President

Mark Russell
Purdue University

President-Elect

Ann Marie VanDerZanden
Iowa State University

Immediate Past President

Tracy Dougher
Montana State University

Secretary/Treasurer

Marilyn Parker

Journal Editor

Rick Parker

Historian

Kevin Donnelly
Kansas State University

Membership Director

Tracy Dougher
Montana State University

NACTA Judging Conference Director

Lyle Westrom
University of Minnesota - Crookston

Canadian Regional Director

Frank Robinson
University of Alberta

Central Regional Director

Tom Paulson
Morningside College

Eastern Regional Director

John Ewing
Pennsylvania State University

Eastern Regional Director-Elect

Daniel Foster
Pennsylvania State University

Western Regional Director

Ingelia White
Windward Community College

Western Regional Director-Elect

Ed Franklin
University of Arizona

Southern Regional Director

Nick Fuhrman
University of Georgia

NACTA CHAIRS & LIASONS

Journal Committee/ Editorial Board

Rick Parker

Journal Awards Committee

Crystal Allen
University of Illinois

Membership & Public Relations Committee

Tracy Dougher
Montana State University

Educational Issues and Teaching Improvement

Brian Pearson
University of Florida

Teacher Recognition Committee

Wendy Warner
North Carolina State University

International Committee and Committee Co-Chair

Chair, Laura White
New Mexico State University

Co-Chair, Kelly Newlon
Ohio State University

Experiential Learning Committee Co-Chairs

Co-Chair, Dana Ladner
Kansas Department of Agriculture

Co-Chair, Tracy Rutherford
Texas A&M University

Nominating/Distinguished Educator/Foundation Advisory Committee

Tracy Dougher
Montana State University

Murray Brown Leadership Award Committee

Ann Marie VanDerZanden
Iowa State University

Delta Tau Alpha Liaison

Elizabeth Walker
Missouri State University

NACTA Foundation Chair

Jeff Hattey
Ohio State University

APLU/CRERR/APS Liaison

Tracy Hoover
Pennsylvania State University

NARRU Liaison

Dale J. Gallenberg
University Wisconsin, River Falls

CAPICU Liaison

Ed Brokaw
Abilene Christian University

2019 Program Chair and Host Site Committee

Rick Parker
College of Southern Idaho - Twin Falls

LOCAL CONFERENCE ORGANIZING COMMITTEE



Ann Marie VanDerZanden

Office of the Senior Vice President & Provost
Years in NACTA: 22 years



Erik Christian

Department of Agronomy
Years in NACTA: 5 years



Christopher Currey

Department of Horticulture
Years in NACTA: 5 years



Cindy Haynes

Department of Horticulture
Years in NACTA: 11 years



Mike Retallick

Department of Agriculture Education & Studies
Years in NACTA: 16 years



Jodi Sterle

Department of Animal Science
Years in NACTA: 5 years

SCHEDULE AT A GLANCE

Tuesday, June 12, 2018

- Noon - 4:00pm NACTA Executive Committee Meeting, *Boardroom 080*
Noon - 7:00pm Registration, *Scheman First Floor Lobby*
6:00 - 6:30pm Welcome Reception for First Time Attendees, *Scheman Outdoor Plaza*
6:30 - 8:30pm Welcome Reception for Everyone, *Scheman Outdoor Plaza*

Wednesday, June 13, 2018

- 7:00 - 8:00am Breakfast, *220-240*
8:30 - 10:00am Welcome and Keynote Speaker, *Benton Auditorium*
10:15am - 12:00pm Poster Session 1, *Second Floor Lobby*
12:00 - 1:00pm Lunch, *220-240*
1:00 - 2:30pm Oral Presentations, *150-154, 175-179, 250-252, 260-262, 275*
2:30 - 3:00pm Break, *First Floor Lobby*
3:00 - 4:30pm Oral Presentations, *150-154, 175-179, 250-252, 260-262, 275*
5:30 - 6:15pm Iowa State University Alumni Reception, *Reiman Gardens*
6:15 - 9:15pm Dinner at *Reiman Gardens*

Thursday, June 14, 2018

- 7:00 - 8:30am Breakfast, *220-240*
7:30 - 8:30am Committee Meetings, *250-252, 260-262, 275*
8:45 - 10:00am Oral Presentations, *150-154, 175-179, 250-252, 260-262, 275*
10:00 - 10:15am Midmorning Break, *First Floor Lobby*
10:15am - 12:00pm Workshops, *150-154, 175-179, 250-252, 260-262, 275, 299*
11:45am - 12:30pm Boxed Lunch, *First Floor Lobby*
12:15 - 12:30pm Tour Departure, *Lot F, Between CY Stephens and Fisher*
5:30pm Dinner on Your Own
6:00 - 8:00pm Graduate Student Reception, *Dublin Bay Irish Pub & Grill*

Friday, June 15, 2018

- 7:00 - 8:30am Breakfast, *220-240*
7:30 - 8:30am Committee Meetings, *175-179, 250-252, 260-262, 275*
9:00 - 10:00am Blue Ribbon Presentation, *Benton Auditorium*
10:15am - 12:00pm Poster Session 2, *Second Floor Lobby*
12:00 - 1:45pm Lunch & Business Meeting, *220-240*
2:00 - 4:15pm Oral Presentations, *175-179, 250-252, 260-262, 275*
5:30 - 6:30pm Social Hour, *Gateway Hotel and Conference Center, Prairie Ballroom*
6:30 - 8:30pm Awards Banquet & Closing Ceremony, *Gateway Hotel and Conference Center, Prairie Ballroom*

Saturday, June 16, 2018

- 9:00am - 12:00pm NACTA Executive Committee Meeting, *Boardroom 080*

TUESDAY, JUNE 12

ALL TUESDAY SESSIONS TAKE PLACE AT THE SCHEMAN BUILDING

NACTA Executive Committee Meeting

Noon - 4:00pm

Scheman Boardroom 080

Conference Registration

Noon - 7:00pm

Scheman First Floor Lobby

Scavenger Hunt

Iowa State University Campus (Shuttles pick up at Lot F. Refer to the map on page 39)

Welcome Reception for First Time Attendees

6:00 - 6:30pm

Scheman Outdoor Plaza

All first time NACTA conference attendees are welcome to come early to the reception and meet with NACTA officers to learn more about the organization and how the conference works.

Welcome Reception for Everyone

6:30 - 8:30pm

Scheman Outdoor Plaza

The Welcome Reception is the kick-off event for the conference. It is a casual evening to gather with our colleagues, reconnect with old friends, and meet new conference attendees. On behalf of the conference organizing committee, we hope you will join us for an **All Iowa** themed evening. And of course- there will be corn!

ISU CAMPUS SCAVENGER HUNT: SELFIE STYLE

Explore sites on the ISU Campus and discover fun facts and history about ISU. Complete the scavenger hunt for a chance to win prizes at the conference. More details at the registration desk. Prizes will be awarded at the Awards Banquet on Friday evening. Participants must be present to win.

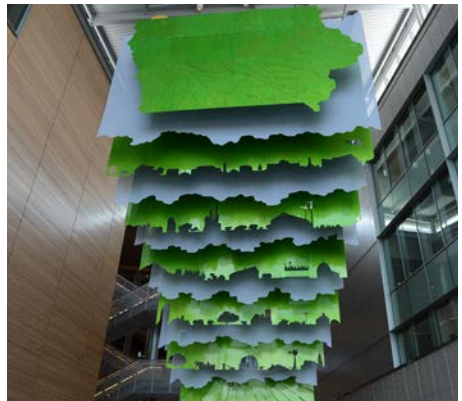

Floating World, Ralph Helmick, Iowa State University

WEDNESDAY, JUNE 13

ALL WEDNESDAY SESSIONS TAKE PLACE AT THE SCHEMAN BUILDING

Breakfast

7:00 - 8:00am

Scheman 220-240

Welcome to NACTA and Keynote Address

8:30 - 10:00am

Benton Auditorium

Welcome

Joe Colletti, Interim Dean

Iowa State University College of Agriculture & Life Sciences

Keynote Speaker

Scott Siepker, Iowa Nice Guy

Poster Session 1 (pages 29-32)

10:15am - 12:00pm

Scheman Second Floor Lobby

Posters have been assigned a location number. This information can be found on **pages 29-32**. All posters should be set up by Wednesday 8:30am and remain up until 2pm on Friday. Any posters remaining after 2pm, can be collected at the first floor registration desk. *Please be available at your poster on your assigned date/time.*

Lunch

12:00 - 1:00pm

Scheman 220-240

Oral Presentations (pages 9-11)

1:00 - 2:30pm

Scheman 150-154, 175-179, 250-252, 260-262, 275

During this time there are five concurrent sessions. You are welcome to move from one session to another, just remember to please exit/enter quietly in order to respect the presenters and fellow attendees.

Break

2:30 - 3:00pm

Scheman First Floor Lobby

Oral Presentations (pages 12-14)

3:00 - 4:30pm

Scheman 150-154, 175-179, 250-252, 260-262, 275

ORAL PRESENTATIONS (PM)

During this time there are five concurrent sessions. You are welcome to move from one session to another, just remember to please exit/enter quietly in order to respect the presenters and fellow attendees.

SCHOLARSHIP OF TEACHING AND LEARNING (SoTL)

SCHEMAN 150-154

1:00PM - 2:30PM

<u>TIME</u>	<u>ABSTRACT</u>	<u>TITLE</u>	<u>AUTHOR/AFFILIATIONS</u>
1:00pm	2018-0019	Impact of Teacher Attire on Students' Views of Teacher Credibility and Homophily	Catherine W. Shoulders Lesley Smith <i>University of Arkansas</i>
1:15pm	2018-0064	Bridging the Gap: A Survey of Student Perception	M. J. Anderson, S. F. Kelley, M. M. Beverly, and K. J. Stutts <i>Sam Houston State University</i>
1:30pm	2018-0105	Panel Discussion as an Effective Instructional Strategy Influencing Student Perceptions	Lauren Lewis Cline, Haley Rosson, Penny Pennington Weeks, and William Weeks <i>Oklahoma State University</i>
1:45pm	2018-0128	A Longitudinal Study Examining Student Evaluation Scores and a Faculty Development Program	Blake C. Colclasure, Sarah E. LaRose, T. Grady Roberts, Elaine R. Turner, and Allen F. Wysocki, <i>University of Florida</i>
2:00pm	2018-0150	Perceptions of Learning in Food and Agricultural Chemistry	E. Walker and S. Lancaster <i>Missouri State University</i>
2:15pm	2018-0177	Student Subjective Opinions of Great Teachers - A Q-Methodology Study	Carley Snider, Joenelle Futrell, and Marshall A. Baker <i>Oklahoma State University</i>

INNOVATIVE TEACHING

SCHEMAN 175-179

1:00PM - 2:30PM

<u>TIME</u>	<u>ABSTRACT</u>	<u>TITLE</u>	<u>AUTHOR/AFFILIATIONS</u>
1:00pm	2018-0123	Use of 3D Simulation Models to Enhance Student Learning in a Food Science Class	Ranjith Ramanathan, Navam Hettiarachchy, Deb VanOverbeke, and Dan Stein, <i>Oklahoma State University</i>
1:15pm	2018-0071	Is the Virtual Grass Greener? Video Game Simulation Use as a Teaching Tool	Kelly Lange, Rachna Tewari, and Joey Mehlhorn <i>Texas Tech University</i>
1:30pm	2018-0108	Blending: Utilizing Multiple Live and On-Demand Platforms for Purposeful Professional Development in Global Learning in Agriculture (#GLAG18)	Melanie Miller Foster and Daniel Foster <i>Penn State University</i>
1:45pm	2018-0114	How Does the Use of a Smartphone-Based Technology in Teaching Influence Learning Outcomes?	Vikram Koundinya, Feiran Chen, Peter Livingston, Kevin Erb, and Janice Kepka <i>University of California, Davis</i>

ORAL PRESENTATIONS (PM)

INNOVATIVE TEACHING AND SoTL (CONTINUED)

SCHEMAN 175-179

1:00PM - 2:30PM

<u>TIME</u>	<u>ABSTRACT</u>	<u>TITLE</u>	<u>AUTHOR/AFFILIATIONS</u>
2:00pm	2018-0053	Social Media and Faculty Development: Examining How Faculty use Social Media to Share an International Professional Development Experience	Lisa Lundy, Tiffany Rogers, Nicole Stedman, Kim Dooley, Amy Harder, James Lindner, Grady Roberts, Christopher Stripling, and Robert Strong, Jr. <i>University of Florida</i>
2:15pm	2018-0218	Can We Meet the Needs of the iGeneration?: Exploring Effective Technology Integration Needs of Educators	OP McCubbins, Will Bird, and John Ricketts <i>Tennessee Technological University</i>

SoTL AND INNOVATIVE TEACHING

SCHEMAN 250-252

1:00PM - 2:30PM

<u>TIME</u>	<u>ABSTRACT</u>	<u>TITLE</u>	<u>AUTHOR/AFFILIATIONS</u>
1:00pm	2018-0023	Preparing a University Agriscience Teaching Methods Class to Design, Deliver, and Assess a Preservice Climate Science Teaching Activity	Peter Skelton and Tom Dormody <i>New Mexico State University</i>
1:15pm	2018-0030	Motivations to Teach and Plans to Continue Teaching for High School Agriculture Teachers in [STATE]	Normala Ismail and Greg Miller <i>Iowa State University</i>
1:30pm	2018-0109	Cultivating Digital Leadership in Pre-Service Teachers: #psuaged18	Tiffany Morey and Daniel Foster <i>Penn State University</i>
1:45pm	2018-0043	Teachers' Perceptions of UAVs in School-Based Agricultural Education	Summer E. Beery and Thomas H. Paulsen <i>Morningside College</i>
2:00pm	2018-0229	An Innovative Agricultural Science Education at a Non-Land-Grant University	Krish Jayachandran, Mahadev Bhat, Kateel Shetty, Amir Khoddamzadeh, and Eric Betancourt <i>Florida International University</i>
2:15pm	2018-0242	I See Myself When I Serve Others: Service Learning to Develop Mechanics Skills In Teachers	Jason McKibben, Ashley Yopp, and Emily Perdue <i>West Virginia University</i>

COMMUNICATING THE VALUE OF SCIENCE

SCHEMAN 260-262

1:00PM - 2:30PM

<u>TIME</u>	<u>ABSTRACT</u>	<u>TITLE</u>	<u>AUTHOR/AFFILIATIONS</u>
1:00pm	2018-0005	Preparing Graduate Students in Agriculture and Natural Resources to Communicate about Science and Research	Lisa K. Lundy <i>University of Florida</i>

ORAL PRESENTATIONS (PM)

COMMUNICATING THE VALUE OF SCIENCE (CONTINUED)

SCHEMAN ROOM 260-262

1:00PM - 2:30PM

<u>TIME</u>	<u>ABSTRACT</u>	<u>TITLE</u>	<u>AUTHOR/AFFILIATIONS</u>
1:15pm	2018-0010	Increasing Scientific Literacy through Inquiry-Based Professional Development	Nathan W. Conner, Bryan A. Reiling, Matt Kreifels, Christopher T. Stripling <i>University of Nebraska-Lincoln</i>
1:30pm	2018-0040	Developing and Teaching an Exploring STEM in Agriculture Course	Rick Parker <i>College of Southern Idaho</i>
1:45pm	2018-0041	Creating Collaborative Partnerships between Industry and Universities to Solve Complex Agricultural Problems	Catherine W. Shoulders, Valerie N. Bayes, Brian E. Myers, Robert Terry, Jr., Debra Spielmaker, and Monica Pastor <i>University of Arkansas</i>
2:00pm	2018-0061	Growing Future Agriscientists: Investigating the Barriers Limiting Agriscience Research at the Secondary Level	Eric Koehlmoos and Gaea Hock <i>Kansas State University</i>
2:15pm	2018-0062	Developing the Next Generation of Water Advocates	Gaea Hock, Katelyn Bohnenblust, and Zachary Callaghan <i>Kansas State University</i>

SCHOLARSHIP OF TEACHING AND LEARNING (SoTL)

SCHEMAN 275

1:00PM - 2:30PM

<u>TIME</u>	<u>ABSTRACT</u>	<u>TITLE</u>	<u>AUTHOR/AFFILIATIONS</u>
1:00pm	2018-0058	One Year Later: Lessons Learned from a Year in West Africa	Haley Q. Clement and Josh Stewart <i>Oregon State University</i>
1:15pm	2018-0060	From the Classroom to the Cocoa Farm: Preparing Recent Graduates for a Year in West Africa	Haley Q. Clement and Josh Stewart <i>Oregon State University</i>
1:30pm	2018-0098	Impacts of Short-Term Agricultural Study Abroad Programs	Michelle Santiago and A. George Bittel <i>Murray State University</i>
1:45pm	2018-0161	Undergraduates' Perceived Personal and Social Responsibilities of Global Citizenship	Katelin Kitchens, Hannah Graben, and Gary Wingenbach <i>Texas A&M University</i>
2:00pm	2018-0135	Students' Self-Perceived Teamwork Skills Growth from Study Abroad	Sierra Salinas, Benjamin Johnson, Eric Minor, and Gary Wingenbach <i>Texas A&M University</i>
2:15pm	2018-0162	Influenced Decisions: Study Abroad Effects on Students' Decision-Making Skills	Braden Deupree, Kelli Gartman, Gary Wingenbach, Tobin Redwine, and Tracy Rutherford <i>Texas A&M University</i>

ORAL PRESENTATIONS (PM)

SCHOLARSHIP OF TEACHING AND LEARNING (SoTL)

SCHEMAN 150-154

3:00PM - 4:30PM

<u>TIME</u>	<u>ABSTRACT</u>	<u>TITLE</u>	<u>AUTHOR/AFFILIATIONS</u>
3:00pm	2018-0011	Use of In-Class, Group, Question Sets to Improve Self-Direction and Critical Thinking for Students Enrolled in a College of Agriculture	Christina H. Esquivel and Theresa Pesi Murphrey <i>Texas A&M University</i>
3:15pm	2018-0029	Skill and Attribute Demands of Agricultural Employers: A Best-Worst Scaling Approach	Michael Barrowclough, Michelle Kibler, and Josh McWilliams <i>Illinois State University</i>
3:30pm	2018-0036	How Learning Outcomes, Perception and Assessment Compare	Brian Whitaker <i>The University of Findlay</i>
3:45pm	2018-0057	Using Data to Improve Academic Programs and Student Success	Clint Ary, Jason Roberts, Joey Mehlhorn, and Scott Parrott <i>University of Tennessee at Martin</i>
4:00pm	2018-0210	Significant Learning in an Agricultural Integrated Marketing Communications Course	Lori Costello and Tracy Rutherford <i>Texas A&M University</i>
4:15pm	2018-0121	Comparing Critical Thinking Conceptualization of Faculty In and Outside Colleges of Agriculture	Jennifer Strong and Barry Boyd <i>Texas A&M University</i>

INNOVATIVE TEACHING

SCHEMAN 175-179

3:00PM - 4:30PM

<u>TIME</u>	<u>ABSTRACT</u>	<u>TITLE</u>	<u>AUTHOR/AFFILIATIONS</u>
3:00pm	2018-0233	Technology-Enhanced Faculty Development in Controlled Environment Animal Production	Ann D. Christy, Lingying Zhao, Emily Buck, Xinlei Wang, Lingjuan Wang Li, Richard Stowell, Ralph C. Noble, Kelly Zering, Edgar Oviedo, Angela Green, Crystal Powers, and Mulumebet Worku <i>The Ohio State University</i>
3:15pm	2018-0075	Facilitating Faculty Development for Classroom Excellence	D.L. VanOverbeke, K.R. Hickman, J. Ramsey, D. Stein, R. Ramanathan, and P. Weckler <i>Oklahoma State University</i>
3:30pm	2018-0048	Teaching Deserves Recognition Too! Documenting and Gaining Recognition for Teaching Effectiveness	Wendy Warner and Nick Fuhrman <i>North Carolina State University</i>
3:45pm	2018-0142	Development of a 3-Day Animal Science Mini-Internship Program	Frank Robinson and Emily Gregory <i>University of Alberta</i>
4:00pm	2018-0145	Active Learning Strategies Impact Curiosity in an Introductory Animal Science Course	MaryGrace Erickson, Dan Guberman, Hao Zhu, and Elizabeth Karcher <i>Purdue University</i>
4:15pm	2018-0186	True Grit: Describing the Grit Score of Students in an Introductory Agriculture Course	Anna K. Pratt, Bishal Thapa, Kasee L. Smith, and Jeremy Falk <i>University of Idaho</i>

ORAL PRESENTATIONS (PM)

INNOVATIVE TEACHING AND SoTL

SCHEMAN 250-252

3:00PM - 4:30PM

<u>TIME</u>	<u>ABSTRACT</u>	<u>TITLE</u>	<u>AUTHOR/AFFILIATIONS</u>
3:00pm	2018-0199	If You Bring Them, Will They Come? The Faculty Role in On-Campus High School Events	Anna K. Pratt, Bishal Thapa, Kasee L. Smith, and Jeremy Falk <i>University of Idaho</i>
3:15pm	2018-0127	Factors Influencing Choice of Major in the College of Agriculture and Life Sciences at Iowa State University	Amy Powell, Greg Miller and Jodi Sterle <i>Iowa State University</i>
3:30pm	2018-0094	Continual Study of Factors Influencing Freshmen's Decision to Major in Agriculture	Amy Jo Jones, Tracie Egger, and Dennis Buckmaster <i>Purdue University</i>
3:45pm	2018-0206	A Survey of Introductory Soil Science Courses in the United States	Nicolas A. Jelinski, Colby J. Moorberg, Michel D. Ransom, and James C. Bell <i>University of Minnesota</i>
4:00pm	2018-0208	Growing Students' Mindset: A Lesson to Analyze Perceptions About Organic Food	Kevin J. Donnelly, J. Anita Dille, and Kim J. Kerschen <i>Kansas State University</i>
4:15pm	2018-0039	Risk Tolerance and Cheap Talk in the College Classroom	Maria A. Boerngen and Emmalee Hortenstine <i>Illinois State University</i>

COMMUNICATING THE VALUE OF SCIENCE

SCHEMAN 260-262

3:00PM - 4:30PM

<u>TIME</u>	<u>ABSTRACT</u>	<u>TITLE</u>	<u>AUTHOR/AFFILIATIONS</u>
3:00pm	2018-0063	Increasing Impact via News Feed: A Model for Research to Practice	Brian E. Myers, Catherine W. Shoulders, and Marshall A. Baker <i>University of Florida</i>
3:15pm	2018-0068	Scientific Communication: Using RLMs to Enhance Communication Education in Agriculture	Holli R. Leggette, Theresa Pesl Murphrey, and Shannon Norris <i>Texas A&M University</i>
3:30pm	2018-0088	An Evaluation of Science Communication Workshops for [State] Extension Agents	Taylor K. Ruth, Joy N. Rumble, Lisa K. Lundy, Ricky W. Telg, and Angie B. Lindsey <i>University of Florida</i>
3:45pm	2018-0117	Pre-Service Students' Beliefs about Teaching STEM in Agricultural Education	Richie Roberts, Antoine J. Alston, and Chasity Warren English <i>North Carolina A&T State University</i>
4:00pm	2018-0137	Framework for Thinking Critically about Science in the Media	Jason Riis and Brandon McFadden <i>Wharton School/University of Pennsylvania</i>
4:15pm	2018-0180	Assessing the Science Literacy in Agriculture of Secondary Agricultural Education Students in Oklahoma - An Exploratory Study	Marshall A. Baker, Christopher Eck, and Mason Jones <i>Oklahoma State University</i>

ORAL PRESENTATIONS (PM)

INNOVATIVE TEACHING AND SoTL

SCHEMAN 275

3:00PM - 4:30PM

<u>TIME</u>	<u>ABSTRACT</u>	<u>TITLE</u>	<u>AUTHOR/AFFILIATIONS</u>
3:00pm	2018-0119	Empowering Preservice Agricultural Education Students in STEM through a Service-Learning Project	Richie Roberts, Chasity Warren English, and Antoine J. Alston <i>North Carolina A&T State University</i>
3:15pm	2018-0097	People, Plants, and Puppies: Developing Service Learning Opportunities Across the Curriculum	Clint Ary, Will Bird, Sandy Mehlhorn, Jason Roberts, and Joey Mehlhorn <i>University of Tennessee at Martin</i>
3:30pm	2018-0224	Integrating Service Learning into a Companion Animal Science Course Designed for Pre-Veterinary Science Majors	Florah N. Mhlanga <i>Lipscomb University</i>
3:45pm	2018-0013	Walk the Walk: A Sustainability Program for Agricultural Partnerships	Rebecca A. Kurnick, Shannon K. Arnold, and Dustin K. Perry <i>Montana State University</i>
4:00pm	2018-0016	Secondary Agricultural Instructors and Students' Adoption of Sustainable Practices	Craig A. Kohn <i>Michigan State University</i>
4:15pm	2018-0045	Curriculum Design to Grow Intercultural Competencies as Learning Outcomes	Lisa Lambert Snodgrass and Mark Russell <i>Purdue University</i>

Iowa State University Alumni Reception

5:30 - 6:15pm

Reiman Gardens

Dinner at Reiman Gardens

6:15 - 9:15pm

Reiman Gardens

After dinner, explore the beautiful and colorful Reiman Gardens filled with unique plants, flowers and butterflies. This 17-acre attraction also features a Children's Garden and the Christina Reiman Butterfly Wing, which is home to nearly 1,000 exotic and native butterflies living in tropical lush foliage, a reflecting pool and cascading waterfall.

Also check out the Wind, Waves & Light Sculpture Exhibit. This exhibit features 13 kinetic sculptures designed to explore space, time and the dynamic relationship of objects in motion. This exhibit is created by George Sherwood, an award-winning American sculptor.



Wind, Waves & Light, Reiman Gardens

THURSDAY, JUNE 14

ALL THURSDAY SESSIONS START AT THE SCHEMAN BUILDING AND TOURS RETURN TO SCHEMAN (WEAR YOUR SCHOOL COLORS TODAY!)

Breakfast

7:00 - 8:30am

Scheman 220-240

Committee Meetings

7:30 - 8:30am

Educational Issues and Teaching Improvement Committee

Committee Chair, Brian Pearson, University of Florida

Scheman 250-252

The Educational Issues and Teaching Improvement Committee (a) solicits and responds to member needs regarding programs and activities for instructional improvement; (b) identifies, develops, sponsors, and conducts specific teaching and learning related activities such as Blue Ribbon presentations, round-tables, symposia, and workshops at the annual conferences; and (c) provides recommendations and assistance to the editor regarding the publishing of materials.

International Committee

Committee Chairs, Laura White, New Mexico State University and Kelly Newlon, Ohio State University

Scheman 260-262

The International Committee: (a) disseminates items of interest to NACTA members concerning international agriculture; (b) encourages publication of articles on international agriculture in the NACTA Journal; and (c) serves as liaison between NACTA and other organizations involved in international agriculture.

Membership and Public Relations Committee

Committee Chair, Tracy Dougher, Montana State University

Scheman 275

The Membership and Public Relations Committee: (a) provides recommendations to the executive committee regarding membership policies and procedures; (b) conducts membership recruitment activities; and (c) conducts public relation activities.

Oral Presentations (pages 17-19)

8:45 - 10:00am

Scheman 150-154, 175-179, 250-252, 260-262, 275

During this time there are five concurrent sessions. You are welcome to move from one session to another, just remember to please exit/enter quietly in order to respect the presenters and fellow attendees.

Break

10:00 - 10:15am

Scheman First Floor Lobby

Workshops (pages 20-21)

10:15am - 12:00pm

Scheman 150-154, 175-179, 250-252, 260-262, 275, 299

THURSDAY, JUNE 14

Boxed Lunches

11:45am - 12:30pm

Scheman First Floor Lobby

Show your ticket, grab your lunch, and then head to Lot F to board your bus or van for the tours. Refer to page 39 to view a map on how to get there.

Tour Departure

12:15 - 12:30pm

Lot F

Several tours are full. Confirmation of the tour you selected was sent via the registration email confirmation, and is included on your nametag, in your registration packet. See page 22 for tour descriptions. Any questions, please come to the registration desk. All tours **require** closed-toed shoes.

The Des Moines is Des Place and Iowa's Industries tours are both about 45 minutes from Ames. As a result, both of these tours should be back to Ames about 6:30pm (depending on traffic). The other tours are scheduled to return to the Scheman building by 5:30pm.

Dinner on your own

5:30pm

Ames has a diverse selection of local restaurants and a great variety of regional and national options, all conveniently located just minutes from campus. From sports pubs to cafes, locally crafted beers and wine to fine coffee, international cuisine to local ingredients, Ames has a taste and a place for you. Visit our website ThinkAmes.com or scan this QR code to see a full list of restaurants around the area.



Graduate Student Reception

6:00 - 8:00pm

Dublin Bay Irish Pub & Grill

Graduate students- come join your student colleagues for an informal gathering hosted by members of the NACTA Executive Committee. Meet at Dublin Bay Irish Pub and Grill located just south of the Scheman building. NACTA will provide the appetizers! Dublin Bay is a full-service pub and offers Irish cuisine ranging from sandwiches, soups and salads, to full dinners and Irish fayre. **Refer to page 37 to view a map on how to get there.**



Dublin Bay Irish Pub & Grill

ORAL PRESENTATIONS (AM)

During this time there are five concurrent sessions. You are welcome to move from one session to another, just remember to please exit/enter quietly in order to respect the presenters and fellow attendees.

SCHOLARSHIP OF TEACHING AND LEARNING (SoTL)

SCHEMAN 150-154

8:45AM - 10:00AM

<u>TIME</u>	<u>ABSTRACT</u>	<u>TITLE</u>	<u>AUTHOR/AFFILIATIONS</u>
8:45am	2018-0081	Effects of Note-Taking Pairs on Students' Reading Retention of Scientific and Popular Press Articles	Christen Burgett, Joshua Mitchell, and Jennifer Bundy <i>Iowa State University</i>
9:00am	2018-0104	An Allelopathy Experiment: A Simple and Inexpensive Hands-On Learning Experience	Tyler Simpson, Yu-Chun Chiu, Jessica Blythe, and Kang-Mo Kua <i>West Virginia University</i>
9:15am	2018-0163	The Effects of Participation in Undergraduate Research on Soft Skills and Career Plans	Alyssa Oates, Laura White, and Ashley Hansen <i>New Mexico State University</i>
9:30am	2018-0188	Using Speed Rounds to Balance Classroom Debate Participation across Personality Types	Julianne Treme <i>North Carolina State University</i>
9:45am	2018-0070	Plant Conservation: What's Taught Versus What's Sought	Kevin Turner and Nick Fuhrman <i>University of Georgia</i>

INNOVATIVE TEACHING

SCHEMAN 175-179

8:45AM - 10:00AM

<u>TIME</u>	<u>ABSTRACT</u>	<u>TITLE</u>	<u>AUTHOR/AFFILIATIONS</u>
8:45am	2018-0100	Using Flipgrid© to Assess Student Reflections	Kellie Claflin and Josh Stewart <i>Oregon State University</i>
9:00am	2018-0095	Flipping a Classroom into a Congress to Incite Learning About the Policy Process	Thomas Kuzmic <i>Oklahoma State University</i>
9:15am	2018-0173	How Flipped Should a Classroom Be? Flipped-Classroom Pedagogy Impact on Student Learning	Rich Crow <i>Morningside College</i>
9:30am	2018-0017	Collaborative Flipped Classrooms: A Transformative Approach to Teaching Technical Writing	James C. Anderson II and Shannon R. Wiley <i>University of Georgia</i>
9:45am	2018-0226	Using Challenge-Based Learning Theory to Teach Basic Electricity Concepts and Skills to Youth	Roger Tormoehlen, William Vollmer, and Richard Fox <i>Purdue University</i>

ORAL PRESENTATIONS (AM)

INNOVATIVE TEACHING

SCHEMAN 260-262

8:45AM - 10:00AM

<u>TIME</u>	<u>ABSTRACT</u>	<u>TITLE</u>	<u>AUTHOR/AFFILIATIONS</u>
8:45am	2018-0196	Seeds for the Future: Workplace Readiness Skills for Tomorrow's Agricultural Workforce	Rachel Hendrix and Carley C. Morrison <i>Mississippi State University</i>
9:00am	2018-0112	Training Students to Attend a Conference: Social and Career Outcomes	Elizabeth A. Flaherty, Casey C. Day, Rachael E. Urbaneck, Darren M. Wood, Laura E. D'Acunto, Vanessa Quinn, and Patrick A. Zollner <i>Purdue University</i>
9:15am	2018-0096	Enhancing the Professional Dimension of Undergraduate Capstone Experiences	Thomas Kuzmic <i>Oklahoma State University</i>
9:30am	2018-0067	Guidelines for Developing Instructional Modules to Improve College Students' Communication Skills: Voices of Faculty and Industry	Theresa Pesl Murphrey, Holli R. Leggette, and Shannon Norris <i>Texas A&M University</i>
9:45am	2018-0130	Students' Views of Employability Skills Gained from Short-Term High Impact Experiences	Coy Westbrook and Gary Wingenbach <i>Texas A&M University</i>

INNOVATIVE TEACHING

SCHEMAN 250-252

8:45AM - 10:00AM

<u>TIME</u>	<u>ABSTRACT</u>	<u>TITLE</u>	<u>AUTHOR/AFFILIATIONS</u>
8:45am	2018-0147	Exploring Factors to Help Recruit and Retain Underrepresented Minority Students	Haley Q. Clement, Jonathan J. Velez, Penelope L. Diebel, Katie Gaebel, and Susan Rowe <i>Oregon State University</i>
9:00am	2018-0126	Exploring the Cultural Context of Agricultural Education for Military Veterans	Crystal Kyle and Kim Niewolny <i>Virginia Tech</i>
9:15am	2018-0169	Enabling Access to Nontraditional Destinations: Including Students with Disabilities on Faculty-Led Study Abroad Programs	Jan Brooks, Susann Sears, TeKisha Rice, and Cagla Giray <i>University of Illinois</i>
9:30am	2018-0231	Experiential Learning in Environmental Control of Animal Production for Minority Students	Lingying Zhao, Lingjuan Wang Li, Ralph C. Noble, Mulumebet Worku, Ann D. Christy, Xinlei Wang, and Rick Stowell <i>The Ohio State University</i>
9:45am	2018-0015	International Graduate Students' Perception of Socio-Communicative, Teaching, and Learning Style	Adeola Ogunade and Lisa K. Lundy <i>University of Florida</i>

ORAL PRESENTATIONS (AM)

INNOVATIVE TEACHING

SCHEMAN 275

8:45AM - 10:00AM

<u>TIME</u>	<u>ABSTRACT</u>	<u>TITLE</u>	<u>AUTHOR/AFFILIATIONS</u>
8:45am	2018-0073	Introductory Organic Agriculture Curriculum for Undergraduate Students in the United States	Randa Jabbour and Makenzie Pellissier <i>University of Wyoming</i>
9:00am	2018-0122	A New Model for Open-Source Development of Institution-Specific Textbooks and Laboratory Manuals	Colby J. Moorberg and David A. Crouse <i>Kansas State University</i>
9:15am	2018-0216	Video Killed the Word Document: Using Videos to Provide Electronic Feedback	Tobin Redwine, Brytann Busick, and Breanna Watkins <i>Texas A&M University</i>
9:30am	2018-0129	The Effects of Food Waste Education on Student Knowledge, Attitudes, and Plate Waste	Rebecca Busse and Rod N. Williams <i>Purdue University</i>
9:45am	2018-0246	Facilitating Baccalaureate Program Enrollment in Two-Year College Students: A Case Study	Ron Rosati, Tiffany Heng-Moss, and Doug Smith <i>Nebraska College of Technical Agriculture</i>



Iowa State University

WORKSHOPS

SCHEMAN BUILDING

10:15AM - 12:00PM

SCHEMAN 175-179

Creating an Inclusive Classroom

Laura Bestler, Sara Marcketti, and Ann Marie VanDerZanden, *Iowa State University*

Since 2016, the Iowa State University Center for Excellence in Learning and Teaching has lead an Inclusive Classroom Workshop. Participants in this approximately 2-hour training: identify their own attitudes towards inclusion and determine how it impacts teaching; enhance instructional skills that contribute to an inclusive campus environment; and learn about student support resources. In this abbreviated workshop for the NACTA conference, participants will complete many of the full workshop elements. Four short learning modules are available through CELT's (Public) Inclusive Classroom Online Modules site (<https://canvas.iastate.edu/courses/49066>).

The information will be instrumental to our face-to-face program; therefore, we encourage you to review the modules prior to the event. After completing the pre-workshop learning modules and the face-to-face program, participants will have: 1) identified discipline-based and course specific improvements to foster inclusive excellence in the classroom; 2) developed an individual action plan for promoting inclusion in the classroom; and 3) become familiar with resources that support diversity and inclusion.

SCHEMAN 250-252

Developing Intercultural Competence in Students Through Study Abroad Experiences

Mary Wiedenhoef and Shelley Taylor, *Iowa State University*

Globalization has created a demand for increased intercultural competence in college graduates who will soon enter the 21st-century workforce. During this workshop, we will introduce study abroad as a tool for providing intercultural competence, explore some tools used for assessing intercultural competence for students participating in study abroad, and work interactively to help participants apply these tools and questions to their own situations.

SCHEMAN 260-262

Intentional Learning: Maximizing Transformational Learning Experiences with Purposeful Reflection

Daniel Foster and Matt Reutlinger, *Pennsylvania State University*

"We do not learn from experience, we learn from reflecting on experience." (John Dewey)

The goal of this interactive workshop will be to utilize a three-dimensional matrix as a pedagogical tool to empower participants to consider reflection in a tactile way. Upon completion of the session, participants will be able to: 1) provide an example of four common genres of reflection; 2) plot and manipulate reflection strategies (new or familiar) on a three-dimensional matrix; 3) identify factors that dictate movement of reflection strategies around the matrix; 4) identify additional references and resources for facilitating reflection; and 5) discuss best practices for future implementation in courses and learning experiences.

WORKSHOPS

SCHEMAN BUILDING

10:15AM - 12:00PM

SCHEMAN 299

We Are All Experiential Educators - Clarifying the Role We Play in Facilitating Great Thinking Through Experience

Marshall A. Baker and Lauren Cline, *Oklahoma State University*

Experiential learning is about a holistic student learning process that includes every element of a student's college experience- from classroom to internship. And, educators play four vital roles in facilitating this experiential process for students: (a) facilitator, (b) expert, (c) evaluator/standard setter, (d) coach. In this workshop, participants will: 1) learn about the experiential learning process; 2) understand how our own learning styles impact our teaching; 3) identify the four key roles educators have in facilitating true learning; 4) take and interpret the Kolb Educator Role Profile to assess individual preferences in the four experiential teaching roles; 5) explore a conceptual model of experiential learning and identify specific strategies to make our classes more experiential.

SCHEMAN 150-154

Making Learning Come Alive: Using 360 Video, Augmented and Mixed Reality in Agriculture

OP McCubbins and Will Bird, *Tennessee Technological University*

Creating engaging learning environments can be challenging for educators at all levels. This workshop aims to empower instructors to create and implement dynamic instructional materials in their courses to make learning come alive. Instructors will learn how to capture and share 360 degree videos, design augmented reality learning objects, and leverage students' personal devices to maximize learning. Topics will assist educators in meeting the needs students who increasingly prefer technology integration in learning environments.

SCHEMAN 275

Promoting Yourself: How to Showcase SoTL in Your P&T Dossier

Tracy Hoover, *Pennsylvania State University*

Jeff Hattey, *The Ohio State University*

This workshop will focus on how the Scholarship of Teaching and Learning (SoTL) can be incorporated into promotion and/or tenure dossiers. The program will feature administrators from different institutions who will share how SoTL is evaluated in the tenure and/or promotion process. Additionally, the workshop will feature a panel discussion with newly promoted faculty from different institutions as well as the opportunity to engage through roundtable discussions.

TOURS



Hops and barley pops, vines and wines

Head out to the Department of Horticulture's Horticulture Research Station to get a first-hand look at what we are growing. Turfgrass, conventional and organic vegetable, orchards, vineyards, and hop yard are some of what you'll see. After the tour, you will head over to a local winery and brewery to sample some local craft beer or wine.



Wild Iowa

Are you interested in seeing a wilder side of Iowa? This tour will visit different sites including Doolittle Prairie and Ledges State Park to show some outstanding natural areas. Doolittle Prairie is a remnant section of virgin tallgrass prairie, which used to cover most of Iowa, while Ledges State Park is the second oldest state park in Iowa which preserves limestone canyons next to the Des Moines river.



Iowa's Industries Tour

Get behind the scenes in Iowa's agriculture industry! This tour will visit two different facilities. The Pioneer Hi-Bred headquarters in Johnston will include a tour of their state-of-the-art fully automated greenhouse facilities where corn and soybeans are bred. We will also visit the John Deere factory in Ankeny where sprayers, cotton pickers, tillage equipment, and seed drills are built.



Agriculture Technology Tour

Are you interested in seeing a more technical side of Iowa State University? Then join the agriculture technology tour! We will visit the Biocentury Farm west of campus, the first fully integrated research and demonstration facility dedicated to producing and processing biomass for fuels. We will also visit the new Sukup and Elings Halls- the home of the Department of Agriculture and Biosystems Engineering and their associated research labs.



Learning spaces and places

Unique learning environments can create opportunities for students and faculty alike, and Iowa State University tries to create these spaces. This tour is going to focus on some of the unique agriculture learning spaces on our campus, including the Hansen Agriculture Learning Center, Dairy Science Farm, and the AG 450 Farm (the only completely student-managed farm at a land-grant university).



Des Moines is Des Place!

Did you know that Des Moines is French for "the monks"? If you are interested in learning more about the State Capitol, consider getting on the bus to visit some highlights of downtown Des Moines, including the Meredith Corporation (publishers of Better Homes and Gardens) and the World Food Prize.

FRIDAY, JUNE 15

ALL FRIDAY SESSIONS START AT THE SCHEMAN BUILDING

Breakfast

7:00 - 8:30am

Scheman 220-240

Committee Meetings

7:30 - 8:30am

Journal Committee

Committee Chair, Rick Parker, College of Southern Idaho

Scheman 250-252

The Journal Committee (a) provides recommendations and assistance to the editor regarding Journal policies and content; and (b) reviews manuscripts submitted to the Journal for publication and abstracts for the annual meetings. The editor shall chair the committee. Members of the Journal Committee serve as the Editorial Board for the NACTA Journal.

Teacher Recognition Committee

Committee Chair, Wendy Warner, North Carolina State University

Scheman 260-262

The Teacher Recognition Committee: (a) establishes and publishes policies and guidelines for the teaching awards; (b) receives nomination materials; (c) determines the award recipients; and (d) posts the names of award recipients to the NACTA Teaching Awards website.

Journal Award Committee

Committee Chair, Crystal Allen, University of Illinois

Scheman 275

The Journal Award Committee: (a) establishes policies and guidelines for the journal awards; (b) evaluates articles in each volume of the Journal; and (c) determines the award recipients.

Undergraduate Experiential Learning Committee:

Committee Chair, Dana Ladner, Kansas Department of Agriculture

Committee Co-Chair, Tracy Rutherford, Texas A&M University

Scheman 175-179

The Undergraduate Experiential Learning Committee: (a) collaborates with the judging conference liaison to intentionally extend the purposes of NACTA through the Judging Conference; (b) explores creative opportunities for NACTA to enhance undergraduate experiential learning; (c) develops stronger career preparation and skill development opportunities through enhanced relationships with agricultural and environmental business leaders and companies; and (d) works with the Educational Issues and Teaching Improvement Committee to recommend programs for the annual conference focused on the implementation and assessment of experiential learning activities.

FRIDAY, JUNE 15

ALL FRIDAY SESSIONS START AT THE SCHEMAN BUILDING

Blue Ribbon Presentation, "You Still Teach?"

9:00 - 10:00am

Benton Auditorium

*Rick Parker, President of the National Agricultural Institute
Journal Editor for North American Colleges and Teachers of Agriculture (NACTA)*

Introduced by: Brian Pearson, Chair Educational Issues & Teaching Improvement Committee

Poster Session 2 (pages 33-36)

10:15am - 12:00pm

Scheman Second Floor Lobby

Posters have been assigned a location number. This information can be found on **pages 33-36**. All posters should be set up by Wednesday 8:30am and remain up until 2pm on Friday. Any posters remaining after 2pm, can be collected at the first floor registration desk. *Please be available at your poster on your assigned date/time.*

Lunch and Business Meeting

12:00 - 1:45pm

Scheman 220-240

The NACTA Annual Business meeting is held during lunch and will provide members an update on the NACTA organization overall, including officer elections, membership, and financial updates. The NACTA 2019 College of Southern Idaho organizing committee will also give a sneak peak of the 2019 Conference-Connecting to STEM.

Oral Presentations (pages 25-27)

2:00 - 4:15pm

Scheman 175-179, 250-252, 260-262, 275

During this time there are four concurrent sessions. You are welcome to move from one session to another, just remember to please exit/enter quietly in order to respect the presenters and fellow attendees.

Social Hour

5:30 - 6:30pm

Gateway Hotel and Conference Center, Prairie Ballroom

Awards Banquet and Closing Ceremony

6:30 - 8:30pm

Gateway Hotel and Conference Center, Prairie Ballroom

The Awards Banquet is the final official event of the conference. This event includes a dinner followed by an awards program to celebrate our successes as educators and recognize our outstanding teaching colleagues. There will be plenty of time for conversation and discussing plans to attend the 2019 NACTA Conference.

ORAL PRESENTATIONS (PM)

During this time there are four concurrent sessions. You are welcome to move from one session to another, just remember to please exit/enter quietly in order to respect the presenters and fellow attendees.

INNOVATIVE TEACHING

SCHEMAN 260-262

2:00PM - 4:15PM

<u>TIME</u>	<u>ABSTRACT</u>	<u>TITLE</u>	<u>AUTHOR/AFFILIATIONS</u>
2:00pm	2018-0170	Media Products as End-of-Unit Assessments	Grant L. Ermis and Josh Stewart <i>Oregon State University</i>
2:15pm	2018-0214	Dyads and Friends: Perceived Communication Competencies in Academic Advising	Tobin Redwine and Taylor Rogers <i>Texas A&M University</i>
2:30pm	2018-0215	Nexus of Food and Nutritional Security, Sustainability and Hunger Graduate Course	Ryan Kornegay, Mingla Charoenmuang, Neil Knobloch, Bhimanagouda Patil, Dilip Lalwani, and Jessica Cooperstone <i>Purdue University</i>
2:45pm	2018-0037	An Innovative Project-Based Learning Approach to Engage Undergraduate Students in Research	Shyam Nair, Danhong Chen, L.A. Wolfskill, F.D. Mills Jr. <i>Sam Houston State University</i>
3:00pm	2018-0087	Thinking Well - Scaling Research Through Critical Conversations	Marshall A. Baker, Catherine W. Shoulders, and Brian E. Myers <i>Oklahoma State University</i>
3:15pm	2018-0044	Self-Monitoring of Academic Writing: A Case Study	Wendy J. Dahl and Lincoln Zotarelli <i>University of Florida</i>
3:30pm	2018-0237	An Integrated Scientific Writing Course Supports Graduate Student Success in Research Publication	Richard C. Pratt, Michelle L. Jones, Brian J. Schutte, and Emilie E. Regnier <i>New Mexico State University</i>
3:45pm	2018-0116	Buzz Group Methodology: Setting the Hive In Your Own Classroom	Jason Headrick <i>University of Nebraska-Lincoln</i>
4:00pm	2018-0164	Sojourner and Apprentice: Graduate Student Experiences in the Agriculture and Life Sciences	Jennifer Helms Culhane <i>Virginia Tech</i>

INNOVATIVE TEACHING

SCHEMAN 175-179

2:00PM - 4:15PM

<u>TIME</u>	<u>ABSTRACT</u>	<u>TITLE</u>	<u>AUTHOR/AFFILIATIONS</u>
2:00pm	2018-0213	Strategies to Improve Experiential Learning Opportunities at a University Equine Center	Kristine Vernon <i>Clemson University</i>
2:15pm	2018-0154	Assessment of Critical Thinking Skills in the Animal Science Curriculum	Sarah Al-Mazroa , Michael Retallick, and Brad Skaar <i>Iowa State University</i>
2:30pm	2018-0217	Using an Agriculture Club to Enhance Student Learning, Engagement and Development	Dean L. Winward, Lee G. Wood, Chad L. Gasser, and Randall D. Violett <i>Southern Utah University</i>

ORAL PRESENTATIONS (PM)

INNOVATIVE TEACHING (CONTINUED)

SCHEMAN 175-179

2:00PM - 4:15PM

<u>TIME</u>	<u>ABSTRACT</u>	<u>TITLE</u>	<u>AUTHOR/AFFILIATIONS</u>
2:45pm	2018-0008	Use of Appropriate Humor to Enhance Student Engagement and Learning	D. M. Johnson <i>University of Arkansas</i>
3:00pm	2018-0046	Shock Value: Media's Momentary Influence on Perceptions of Animal Agricultural Issues	M.M. Beverly, S.F. Kelley, M.J. Anderson, and J.P. Cordova <i>Sam Houston State University</i>
3:15pm	2018-0155	Promoting Student Learning of Statistical Food Sampling Plans Using a Visual Novel	Clint Stevenson, Helen S. Joyner, and Shelly J. Schmidt <i>University of Idaho</i>
3:30pm	2018-0031	Integrating Experiential Learning into Agribusiness Entrepreneurship Education	Danhong Chen, Foy D. Mills, Jr., Shyam S. Nair, and L. A. Wolfskill <i>Sam Houston state University</i>
3:45pm	2018-0166	The Benefits of Living in an Agricultural Residential College	Betsy Garrison, Kristin Stair, Michael Kaller, and Robert Rohli <i>University of Arkansas</i>
4:00pm	2018-0249	Effectiveness of a Hands-On Learning Based Approach to Livestock Handling, Safety, and Welfare	Jennifer Bundy, Anna Johnson, Jodi Sterle, and Gregory Krahn <i>Iowa State University</i>

COMMUNICATING THE VALUE OF SCIENCE, SoTL, INNOVATIVE TECHNOLOGY

SCHEMAN 250-252

2:00PM - 4:00PM

<u>TIME</u>	<u>ABSTRACT</u>	<u>TITLE</u>	<u>AUTHOR/AFFILIATIONS</u>
2:00pm	2018-0219	Instructional Resources to Teach Science Concepts while Promoting Careers in Horticulture	Nicole Martini, Kimberly A. Williams, Gaea Hock, and Chad T. Miller <i>Kansas State University</i>
2:15pm	2018-0192	Rolling the Academic Integrity Dice: Cheating or Collaboration	Donna L. Graham and K. Jill Rucker <i>University of Arkansas</i>
2:30pm	2018-0198	Building a Community of Learners: Strategies to Enhance Student Engagement and Learning	Katherine R. VanValin and Stephanie L. Hansen <i>Iowa State University</i>
2:45pm	2018-0125	STEM, Project-Based Authenticity; More is Not Always Better	Jason D. McKibben and Timothy H. Murphy <i>West Virginia University</i>
3:00pm	2018-0152	Updating Agricultural Communications Curriculum: A Delphi Study	Taylor Kennedy, Shelly Sitton, Dwayne Cartmell, and Shane Robinson <i>Oklahoma State University</i>
3:15pm	2018-0034	A Summary of Agricultural Mechanical Competencies after High School Matriculation	Douglas D. LaVergne <i>Texas A&M University-Commerce</i>

ORAL PRESENTATIONS (PM)

COMMUNICATING THE VALUE OF SCIENCE, SoTL, INNOVATIVE TECHNOLOGY (CONTINUED)

SCHEMAN 250-252

2:00PM - 4:00PM

<u>TIME</u>	<u>ABSTRACT</u>	<u>TITLE</u>	<u>AUTHOR/AFFILIATIONS</u>
3:30pm	2018-0175	Engaging Undergraduates in Citizen Science with Pollinators to Enhance Conservation Knowledge, Biological Systems Thinking, and Community Engagement	Doug Golick, Wyatt Hoback, and Hartmut Doebel <i>University of Nebraska-Lincoln</i>
3:45pm	2018-0072	Predicting 'On-Time' Graduation of Agricultural, Food and Life Sciences Students	Donald M. Johnson, Catherine W. Shoulders, and Leslie D. Edgar <i>University of Arkansas</i>

INNOVATIVE TEACHING & SoTL

SCHEMAN 275

2:00PM - 4:00PM

<u>TIME</u>	<u>ABSTRACT</u>	<u>TITLE</u>	<u>AUTHOR/AFFILIATIONS</u>
2:00pm	2018-0176	Understanding (Dis)Engagement by Disrupting & Reversing the Experiential Learning Sequence	Ashley M. Yopp, Billy R. McKim, Yvonna S. Lincoln, and Tobin D. Redwine <i>University of Georgia</i>
2:15pm	2018-0090	Improving Student Success and Engagement in a Biochemistry Lab Course	Orla M. Hart <i>Purdue University</i>
2:30pm	2018-0035	Using Student Affective Motivation as an Assessment of Dairy E-Learning Modules	Emma C. Allen, Mark Tucker, Hui-Hui Wang, and Colleen Brady <i>Purdue University</i>
2:45pm	2018-0054	Steer-A-Year: Exposure to the Beef Industry through a Hands-On Learning Experience	Matthew Kennedy <i>Oregon State University</i>
3:00pm	2018-0056	Growing the Livestock Adventure for Youth: A Replacement Beef Heifer Development Contest	F. Dean Jousan, W. Cobie Rutherford, and Laura L. Greenhaw <i>Mississippi State University</i>
3:15pm	2018-0099	Eww, You're Eating It: Innovative Approaches to Conquering Fear of the Unknown	Macdonald Burgess <i>Montana State University</i>
3:30pm	2018-0181	A Whole New Adventure: Student Success through an Agricultural Living-Learning Community	Andrea L. Simpson, Laura L. Greenhaw, and Carley C. Morrison <i>Mississippi State University</i>
3:45pm	2018-0052	Preparing Interculturally Competent Agriculture Students	Pamala Morris and Shalyse Iseminger <i>Purdue University</i>

SATURDAY, JUNE 16

NACTA Executive Committee Meeting

9:00am - 12:00pm

Scheman Boardroom 080

POSTER LAYOUT

SCHEMAN: SECOND FLOOR

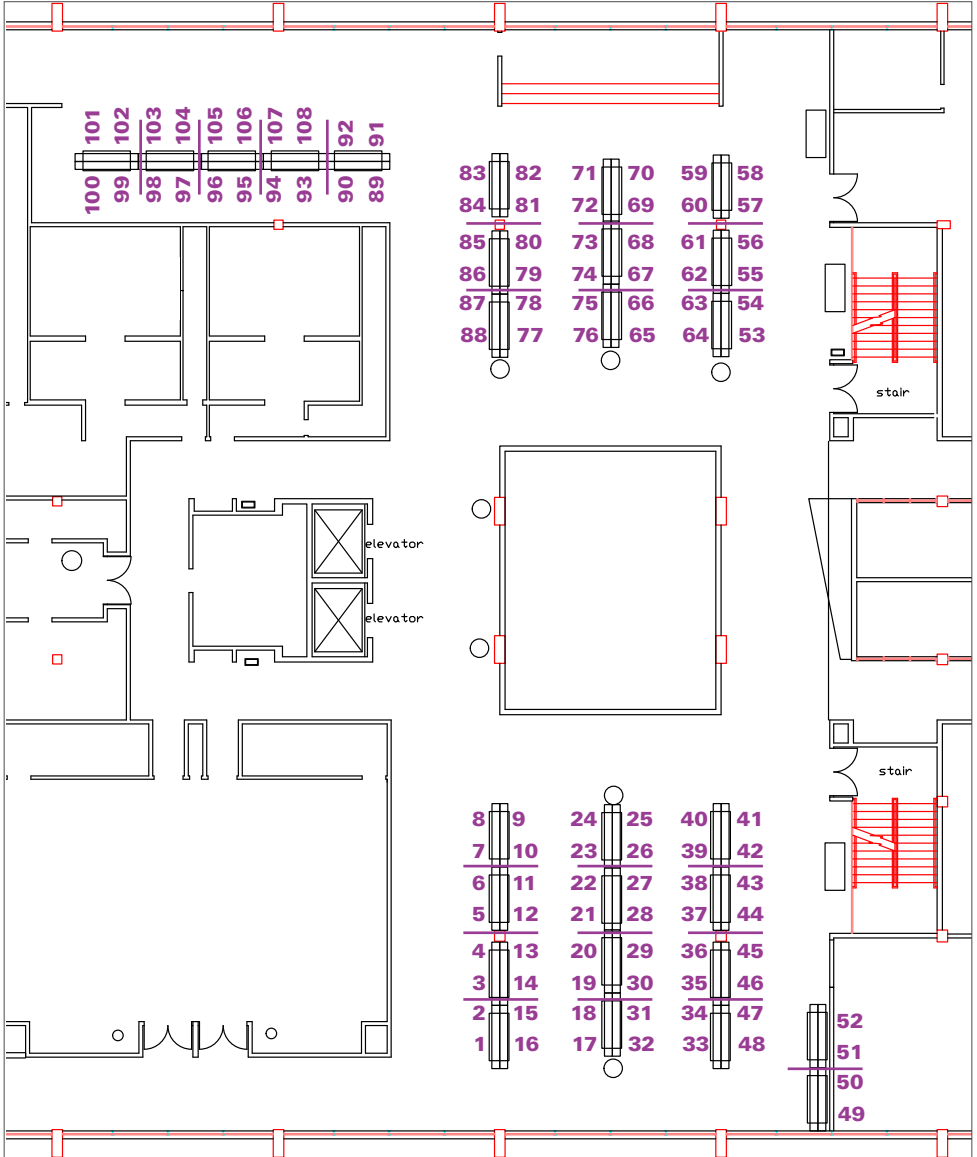

POSTER SESSION 1: WEDNESDAY

10:15AM

<u>ABSTRACT</u>	<u>TITLE</u>	<u>AUTHOR/AFFILIATIONS</u>	<u>POSTER #</u>
2018-0253	Implementation of a Bioinformatics Project in an Undergraduate Genetics Course	Gabrielle Johnson, Keenan Amundsen, Joseph Dauer, Tiffany Heng-Moss, and Donald Lee <i>University of Nebraska-Lincoln</i>	91
2018-0254	Expectations and Experience of Mentoring in an Undergraduate Summer Research Internship	Carol A. Speth, Martha Mamo, Donald J. Lee, Leah Sandall and Salvador Ramirez, Jr. <i>University of Nebraska-Lincoln</i>	89
2018-0252	Effects of Active Learning Activities on Student Engagement with Scientific Practices	Yujin Park and Diane Ebert-May <i>Michigan State University</i>	18
2018-0132	Cloverbud and Grow with Mini 4-H Camp	Dottie L. Vollmer and Levon T. Esters <i>Purdue University</i>	50
2018-0133	Cultivating Content Knowledge Through a High Impact Learning Opportunity	Gaea Hock, Brandie Disberger, Jon Ulmer, and R. Bud McKendree <i>Kansas State University</i>	84
2018-0134	The Grass is Greener: Student Perceptions of an Agronomic Experiential Learning Activity	Heather Glennon <i>University of Missouri</i>	70
2018-0136	Collaborating to Recruit the Future: Pre-College Program Development, Assessment, and Impact	Amy Jo Jones and Myron McClure <i>Purdue University</i>	64
2018-0138	Lighting the Fire: Reflection of a Prescribed Burn Experiential Learning Opportunity	Drew Ricketts and Gaea Hock <i>Kansas State University</i>	86
2018-0143	Assessing the Long-Term Benefit of International Agricultural Study Travel Courses	Mary H. Wiedenhoft, Robert Butcher, and Thomas E. Loynachan <i>Iowa State University</i>	42
2018-0146	Non-Major Student Perception of Accuracy of Content About the Loss of Pollinators Varies by Delivery Mode	W. Wyatt Hoback, Tracy Boyer, and Karthik Ramaswamy <i>Oklahoma State University</i>	93
2018-0149	Science Literacy and Public Policy: Preaching Outside the Choir	Kevin W. Curry Jr. <i>North Carolina State University</i>	58
2018-0153	An Exploration of Agricultural Extension Education Graduate Degree Programs in the U.S.	Kelsey Sands and Michael Retallick <i>Iowa State University</i>	10
2018-0156	Teachers Perspectives Regarding Effectiveness of Online Lessons in School-Based Agricultural Education (SBAE)	Rudy Tarpley, Katherine Adams, David Frazier, Wayne Atchley, and Chandra Andrew <i>Tarleton State University</i>	7
2018-0157	Problem-Based Ethical Learning in Veterinary Medicine	Heloisa M. Rutigliano and Chris L. Chapman <i>Utah State University</i>	62
2018-0158	Using Concept Maps to Promote Content Integration	Heloisa M. Rutigliano <i>Utah State University</i>	63

POSTER SESSION 1: WEDNESDAY

10:15AM

<u>ABSTRACT</u>	<u>TITLE</u>	<u>AUTHOR/AFFILIATIONS</u>	<u>POSTER #</u>
2018-0159	Improving Data Granularity in the Food & Agricultural Education Information System (FAEIS)	Andrew Meeks, Deelan Jalil, and Pete Ziegler <i>Virginia Tech</i>	59
2018-0160	Pre-Class Online Quizzes on Reading Assignments: Student Behavior and Relation with Achievement	M. A. Wattiaux, W. Wang, and P. Crump <i>University of Wisconsin-Madison</i>	24
2018-0165	Searching for Success: Rethinking Graduate Admissions	M. J. Anderson and S. S. Nair <i>Sam Houston State University</i>	51
2018-0167	Review of Historical Developments in Required Courses in a College of Agriculture	Jacie Grant, Colleen Kelly, Neil Knobloch, and Elizabeth Karcher <i>Purdue University</i>	30
2018-0168	Factors Limiting Participation by Secondary Agriculture Teachers in the World Food Prize Purdue Youth Institute	Kraig Bowers and B. Allen Talbert <i>Purdue University</i>	44
2018-0171	Using Landlabs to Ground Learning in Practice	Grant L. Ermis and Josh Stewart <i>Oregon State University</i>	95
2018-0172	STEM Academic Days: Increasing STEM Interest with Underrepresented Groups	Melissa (Voigt) Huppert and Aaron Budge <i>Minnesota State University, Mankato</i>	26
2018-0174	Real-World Learning through Engaging Students with Farmers and Extension Faculty	Kulbhushan Grover <i>New Mexico State University</i>	12
2018-0178	Teaching the Science of Nontraditional Water on Food Crops, with Animations and Interactive Media	Jeanne Gleason, Barbara Chamberlin, Pamela Martinez, Elizabeth Sohn, Amy Smith Muise, and Rachel Rosenberg Goldstein <i>New Mexico State University</i>	75
2018-0182	Perceived Changes in Intercultural Knowledge and Competence from Study Abroad	Brooklynn Morrow, Taylor Emola, Gary Wingenbach, Tobin Redwine, and Tracy Rutherford <i>Texas A&M University</i>	46
2018-0183	Growing Our Mindset: A Diversity Summit Assessment	Tiffany L. Carter and Zelia Z. Wiley <i>Kansas State University</i>	28
2018-0184	A Design Process for Multimedia Learning Tools	Pamela Martinez, Barbara Chamberlin, Jeanne Gleason, Amy Smith Muise, and April Ulery <i>New Mexico State University</i>	76
2018-0187	Farm to Fork: An Honors Course on Food Systems	Robert Williams, Chelsea Arnold, and Jennifer Lopez <i>Texas A&M-Commerce</i>	106
2018-0189	Supporting Students in Verbal Communication Courses: Insight on Reducing Speaker Apprehension	D. Adam Cletzer, Tanner L. Adkins, Sophia Mendelson, and Emily Schuckenbrock <i>University of Missouri</i>	56

POSTER SESSION 1: WEDNESDAY

10:15AM

<u>ABSTRACT</u>	<u>TITLE</u>	<u>AUTHOR/AFFILIATIONS</u>	<u>POSTER #</u>
2018-0190	A Land-Grant Model: Connecting University and High School Teachers through STEM Adventure	Mingla Charoenmuang, Hui-Hui Wang, Neil A. Knobloch, and Roger Tormoehlen <i>Purdue University</i>	33
2018-0191	PK-12 workshops Focused on Parent Engagement of Non-Traditional Students in College of Agriculture	Yujie Huang, Alex Pettigrew, and Neil Knobloch <i>Purdue University</i>	36
2018-0193	Role of Women's Empowerment in Sustainable Development Goals	Liz Alexander and Levon T. Esters <i>Purdue University</i>	47
2018-0194	Integrated STEM Learning with Stella the Great and Bruno Uptown Funk Boss	Trinity Johnson, Alexandria Pettigrew, Hui Hui Wang, and Neil Knobloch <i>Purdue University</i>	35
2018-0195	Creative Classroom Activities	Sergio Abit, Angel Riggs, and Bailey Norwood <i>Oklahoma State University</i>	81
2018-0200	Old vs. New: Comparing Performance on Two State Teacher Certification Tests in Agriculture	Dwayne Pavelock, Shyam Nair, and Doug Ullrich <i>Sam Houston State University</i>	5
2018-0201	Performance of Agriculture Teacher Candidates on a General Pedagogy State Teacher Certification Exam	Dwayne Pavelock, Shyam Nair, and Doug Ullrich <i>Sam Houston State University</i>	3
2018-0202	How to Improve Classroom Evaluation of Learning Tools	April Ulery, Amy Smith Muise, Barbara Chamberlin, Jeanne Gleason, and Kenneth Carroll <i>New Mexico State University</i>	79
2018-0204	Early College in Agriculture Education	Sharad P. Marahatta, Gigi Drent, Brandon Fujita, and Kylie K. Hashizaki <i>Kauai Community College, University of Hawaii</i>	1
2018-0205	Teaching Undergraduate Research Students the Value of Communicating Science	Amy Jo Jones, Mary Helen Halsema, and Mark Tucker <i>Purdue University</i>	54
2018-0207	A Front-End Analysis of Perceptions and Needs of Faculty Regarding Online Courses	Elise A. Lofgren, Colleen M. Brady, and Mark A. Russell <i>Purdue University</i>	77
2018-0209	Developing Global Competencies through Undergraduate Bi-National Team Activities	Gail Nonnecke, Kevin Duerfeldt, Julie Blanchong, Dorothy Masinde, and David Acker <i>Iowa State University</i>	40
2018-0211	Teaching Writing through Grant Narratives	Becky Haddad, Haley Q. Clement, and Jonathan J. Velez <i>Oregon State University</i>	66
2018-0212	What's on Your Syllabus? Preventing Student Academic Integrity Violations	K. Jill Rucker and Donna L. Graham <i>University of Arkansas</i>	71
2018-0220	Multiple Homework Attempts - A Strategy for Student Success?	Craig S. Darroch <i>University of Tennessee at Martin</i>	73

POSTER SESSION 1: WEDNESDAY 10:15AM

<u>ABSTRACT</u>	<u>TITLE</u>	<u>AUTHOR/AFFILIATIONS</u>	<u>POSTER #</u>
2018-0221	Promoting Indirect Academic Outcomes and Future Aspirations via Food and Garden Activities	Mingla Charoenmuang, Amonté L. Martin, Sr., Neil A. Knobloch, Levon T. Esters, and Sybil S. Kelley <i>Purdue University</i>	48
2018-0222	Understanding Student Dynamics Associated with Repeated Probation and Suspension	Anya Work and Pete Ziegler <i>Virginia Tech</i>	60
2018-0223	The Redesign of a Social Justice Course in Agriculture	Pamala Morris and Myron McClure <i>Purdue University</i>	53
2018-0225	A Novel Teaching Approach to Enhance Students' Understanding of Food Safety Regulations	Ravi Jadeja and Ranjith Ramanathan <i>Oklahoma State University</i>	104
2018-0228	Refining the Community Viability Indicator (CVI) Instrument: A Mixed Method Approach	Lane Woodward, Asha H. Shayo, Sarah A. Bush, Rachel Mack, and Rick Rudd <i>Virginia Tech</i>	38
2018-0238	A Student Hosted Cattle Sale as an Approach to Experiential Learning	Wade Lang, Courtney Biles, and Erin Brown <i>Stephen F. Austin State University</i>	100
2018-0245	An International Model for Building Authenticity in the Classroom	Billye Foster <i>Tennessee Tech University</i>	32
2018-0247	Instructor Experiences in Implementing ECEAP ELearning Curriculum	Richard Stowell, Lingjuan Wang-Li, and Lingying Zhao <i>University of Nebraska</i>	22
2018-0248	Ag Mashup: Blending Agricultural and Communications Students and Faculty in the Classroom to Increase Agricultural Communication and Literacy	Jason P. de Koff and Nicole Kraft <i>Tennessee State University</i>	68
2018-0250	Spreading the Word: A Qualitative Study Exploring Educational Needs on Zoonotic Disease Spread and Prevention	Mariah Bausch and Lauri Baker <i>Kansas State University</i>	98
2018-0251	Taking Advantage of a Stinky Opportunity to Promote Science	Chad T. Miller <i>Kansas State University</i>	20



YOUR ADVENTURE

NACTA 2018 • IOWA STATE UNIVERSITY • AMES, IA • JUNE 12-15, 2018

POSTER SESSION 2: FRIDAY

10:15AM

<u>ABSTRACT</u>	<u>TITLE</u>	<u>AUTHOR/AFFILIATIONS</u>	<u>POSTER #</u>
2018-0227	Summer Garden Camp for Toddlers and Their Guardians	Mingla Charoenmuang <i>Purdue University</i>	49
2017-0500	Health Solutions: Promoting Interdisciplinary Thinking	P.E. Shuler <i>Fort Lewis College, Durango CO</i>	99
2018-0002	A Decade Review of an Agricultural Residential College	M. E. Betsy Garrison, Kristin S. Stair, Michael Kaller, and Robert V. Rohli <i>University of Arkansas</i>	107
2018-0501	Evaluation of Undergraduate Student Critical Thinking in Animal and Food Sciences	Cassandra Jones and Gaea Hock <i>Kansas State University</i>	87
2018-0003	Integration and Success of Study Abroad Program for Animal-Related Majors at UC Davis	Kathryn A. Jackson <i>UC Davis</i>	41
2018-0004	The Food Literacy of College Students	Betsy Garrison and Leslie Edgar <i>University of Arkansas</i>	105
2018-0006	How Do Antibiotics Actually Work? A Combined Wet-Lab and In-Silico Activity	Tahl Zimmerman <i>North Carolina A & T State University</i>	103
2018-0007	Yogurt as the Bridge Between Biochemistry, Microbiology, and Food Science	Tahl Zimmerman <i>North Carolina A & T State University</i>	101
2018-0012	Advancing Your Market Project	Wendy Becker, Josie Evenson, Dustin K. Perry, and Carl G. Igo <i>Montana State University</i>	72
2018-0014	A Team Approach: Pairing up with Industry to offer Effective Professional Development	Dustin K. Perry and Shannon K. Arnold <i>Montana State University</i>	92
2018-0018	Do Student Goals, Motivation, and Confidence Predict Exam Scores?	Catherine W. Shoulders, Rob N. Wiedenmann, and Donald M. Johnson <i>University of Arkansas</i>	29
2018-0020	Exploring the Influence of Course Elements on Students' Approaches to Learning	Debra S. Korte and Shelly J. Schmidt <i>University of Illinois at Urbana-Champaign</i>	31
2018-0021	Assessment of a Learning Community in Agribusiness Education	Michael Gunderson and Ryan Musselman <i>Purdue University</i>	9
2018-0022	Student Perceptions of an Ireland Study Abroad Experience	Mikaela L. Hermstedt, John Ewing, Tracy Hoover, and Dennis R. Decoteau <i>Penn State University</i>	43
2018-0025	Kansas Youth Dream Careers as They Relate to State Workforce Needs	Dana J. Ladner, Russell Plaschka, Kerry Wefald, and Caitlyn Maloney <i>Kansas Department of Agriculture</i>	90

POSTER SESSION 2: FRIDAY

10:15AM

<u>ABSTRACT</u>	<u>TITLE</u>	<u>AUTHOR/AFFILIATIONS</u>	<u>POSTER #</u>
2018-0026	Waterfowl and Watercolors: Enhancing Undergraduate Students' Waterfowl Identification Skills	Adam A. Ahlers <i>Kansas State University</i>	94
2018-0028	NACTA Teaching Tips Promote Participatory Learning	Charles Francis, Jeremy Hummel, Geir Lieblein, Tor Arvid Breland, Anna Marie Nicolaysen, Suzanne Morse, Mary Wiedenhoft, Robert Dehaan, Paul Porter, and Lennart Salomonsson <i>University of Nebraska - Lincoln</i>	85
2018-0032	Scholarship Interviews: Worthless, or Worth It?	Jason Emmert, Debra Korte, and Prasanta Kalita <i>University of Illinois</i>	61
2018-0033	An Innovative Approach to STEM Integrated Environmental Education	Miranda Furrer, Hui-Hui Wang, and Neil Knobloch <i>Purdue University</i>	55
2018-0042	An Immersive Recruitment Event for Agricultural Degree Programs	Hailey R. Gates and Catherine W. Shoulders <i>University of Arkansas</i>	27
2018-0047	Hands-On Activities for Teaching Turf and Landscape Irrigation	Donald M. Johnson <i>University of Arkansas</i>	97
2018-0049	Experiences of Undergraduate Animal Science Researchers: A Preliminary Investigation	Ben Weikert, Leigha LaTourette, and Makayla Fowler <i>SUNY Cobleskill</i>	78
2018-0050	Innovations for Agriculture: Prototyping Solutions to Sustainability Challenges	Sam E. Wortman and David Lambe <i>University of Nebraska - Lincoln</i>	17
2018-0051	Developing a Holistic Framework for Learning Outcomes Assessment in Plant Propagation	Sam E. Wortman and Martha Mamo <i>University of Nebraska - Lincoln</i>	19
2018-0055	Science Integration and Inquiry- Based Learning in Agriscience Teacher Preparation	Nathan W. Conner, Christine G. Cooper, Katelynn Ness, Jamie Loizzo, and Christopher T. Stripling <i>University of Nebraska-Lincoln</i>	4
2018-0065	Great Expectations or Pride and Prejudice: A Survey of Student Perception	M. J. Anderson, M. M. Beverly, S. F. Kelley, and K. J. Stutts <i>Sam Houston State University</i>	57
2018-0066	Evaluation of Student Performance Based on Instructional Technology: PowerPoint v. Traditional Chalkboard	Aditi Angirasa, Douglas Morrish, and Isaac Sitienei <i>Texas State University</i>	83
2018-0069	Social Media: A Useful Tool for Advertising a Cattle Sale?	Courtney Biles, Jasmine Nellums, Candis Carraway, and Erin G. Brown <i>Stephen F. Austin State University</i>	74
2018-0074	Agripharmatech Program Certificates: Transfer and Workforce Pathways from High School to Associate and Bachelor's Degrees	Ingelia White, Hongwei Li, Teena Michael, and Charlene Akina <i>Windward Community College</i>	88
2018-0076	Tarleton State University Graduate Students' Perceptions of Genetically Modified Organisms	Taylor Nichols, Sandy Graham, Wayne Atchley, and Chandra Andrew <i>Tarleton State University</i>	52

POSTER SESSION 2: FRIDAY

10:15AM

<u>ABSTRACT</u>	<u>TITLE</u>	<u>AUTHOR/AFFILIATIONS</u>	<u>POSTER #</u>
2018-0077	How Using Scenarios Can Create a Dynamic Learning Environment	Nicole Stedman, Amy Harder, Grady Roberts, Lisa Lundy, Robert Strong, Kim Dooley, Jimmy Lindner, and Christopher Stripling <i>University of Florida</i>	69
2018-0080	Using Pre- and Post-Course Assessments to Evaluate Student Learning in Animal Welfare Assessment Courses	Carly I. O'Malley and Janice M. Siegford <i>Michigan State University</i>	21
2018-0082	Everything but the Kitchen Sink: Teaching Urban Ecosystem Services without Lectures	Michael L. Mashtare Jr. <i>Purdue University</i>	82
2018-0083	Snap to the Future: Developing Career-Ready Skills in Entry-Level Employees	Shannon Norris and Tracy Rutherford <i>Texas A&M University</i>	8
2018-0085	Nurturing Engagement: Conducting Formative Assessments of Student Learning with Plickers	Gaea Hock, Courtney Meyers, and Jeremy Falk <i>Kansas State University</i>	23
2018-0089	Flipping Apparel Construction Class Inside Out	Devona L. Dixon, <i>North Carolina A&T State University</i>	102
2018-0091	From the Field to the Forest: Engaging Students in a Discussion about Soils	Michael L. Mashtare Jr. and John G. Graveel <i>Purdue University</i>	80
2018-0092	Supplementing Official Course Evaluations	Quisto Settle and T.J. Bradford <i>University of Florida</i>	25
2018-0093	Applying Cognitive Task Analysis to Professional Horse Judging Practices	Paige Arehart, Kathryn Orvis, Colleen Brady, and Sean Brophy <i>Purdue University</i>	67
2018-0101	A Novel Approach for Student Debates on Controversial Topics in Agriculture	J.L. Ghezzi <i>Ball State University</i>	65
2018-0103	A Longitudinal Analysis of Recruitment Trends Following University Summer Programs in Agriculture for High School Scholars	Will Bird and Joey Mehlhorn <i>University of Tennessee at Martin</i>	39
2018-0106	Does It Matter Where You Come From?: A Qualitative Comparison of Effects on Tennessee Governor's School for the Agricultural Sciences Participants of Varying Demographic Backgrounds	William Singer, Will Bird, and Joey Mehlhorn, <i>University of Tennessee at Martin</i>	37
2018-0107	Assessing Professional Development Needs: Improving Teaching and Learning in Agricultural Education	Laura Rice, John Ewing, and Daniel Foster <i>University of Kentucky</i>	2
2018-0110	Secondary Agricultural Teacher Preparation in U.S. Higher Education: Historical Perspectives on Capacity and Production	Daniel Foster, Rebecca Lawver, and Amy Smith <i>Penn State University</i>	14

POSTER SESSION 2: FRIDAY

10:15AM

<u>ABSTRACT</u>	<u>TITLE</u>	<u>AUTHOR/AFFILIATIONS</u>	<u>POSTER #</u>
2018-0111	Revisiting a Project: #TeachAgChat's Growth Since 2015	George Dietrich and Daniel Foster <i>Penn State University</i>	15
2018-0113	#TeachAgTalks: Fighting Email Deluge with Podcasts	Hunter Kaufman and Daniel Foster <i>Penn State University</i>	16
2018-0115	Exploring the Applicability of Academic Advising through a Lens of Leadership & Mindset	Jason Headrick and Hannah Sunderman <i>University of Nebraska-Lincoln</i>	96
2018-0118	Agricultural Students' Perceptions of Being Taught with Curriculum for Agricultural Science and Education (CASE)	Scott Smalley and Kelsey Sands, <i>Iowa State University</i>	13
2018-0120	State Wide Self-Assessment of General Program Standards for Agricultural Education	Kelsey Sands, Adam Sacquitne, Scott Smalley and Michael Retallick, <i>Iowa State University</i>	11
2018-0124	Integrating Service Learning into the Agriculture Classroom	Stephen Edwards, Heather Glennon, and Sandra Maddox <i>University of Mount Olive</i>	45
2018-0131	Strategies to Developing Graduate Student Career Preparation for the Academy and Beyond	Torrie A. Cropps, Brandon C. Allen, Quintana M. Clark, and Levon T. Esters <i>Purdue University</i>	6

NACTA
2019



MAPS

SCHEMAN BUILDING, REIMAN GARDENS, AND GATEWAY HOTEL & CONFERENCE CENTER

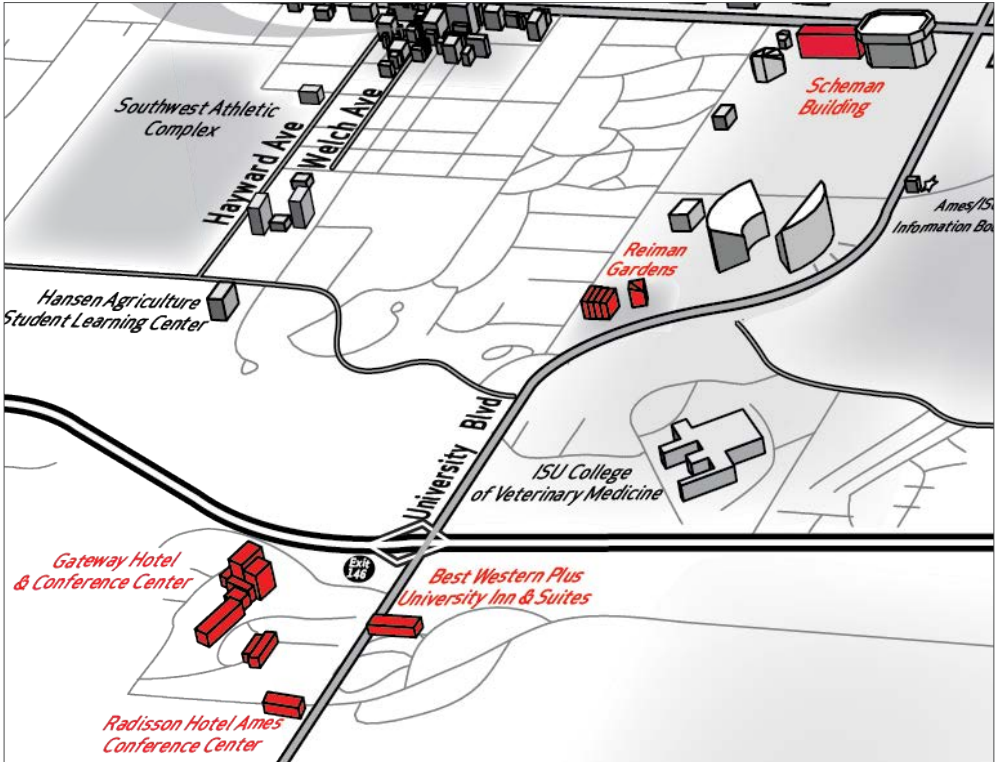

SCHEMAN BUILDING AND DUBLIN BAY IRISH PUB & GRILL

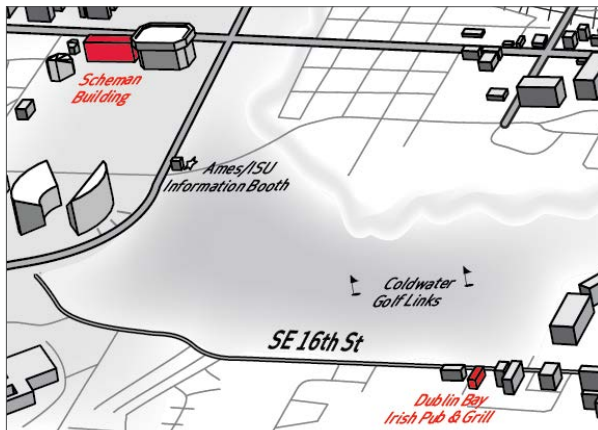

MAPS

SCHEMAN BUILDING: INTERIOR

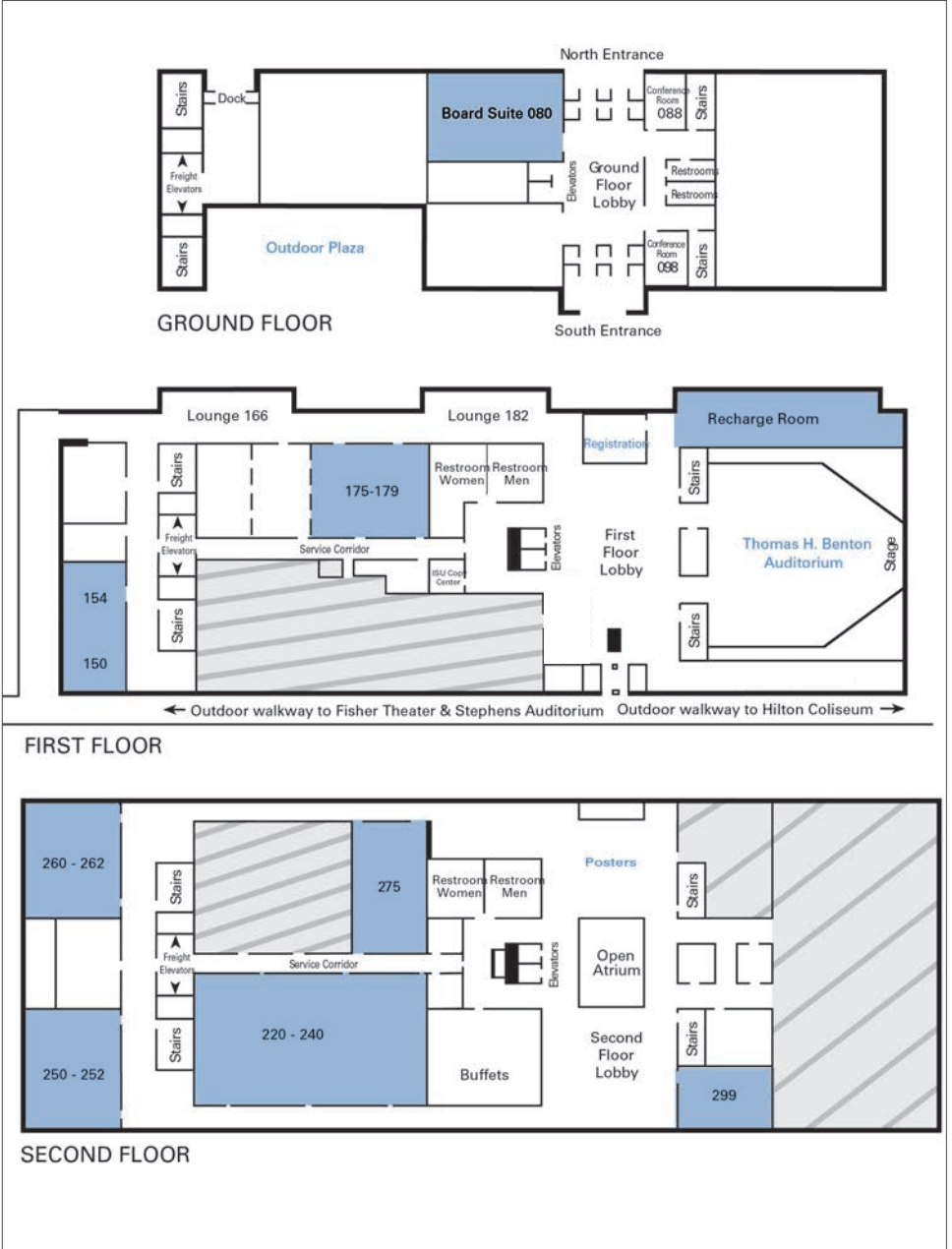

MAPS

SCHEMAN BUILDING: EXTERIOR PARKING

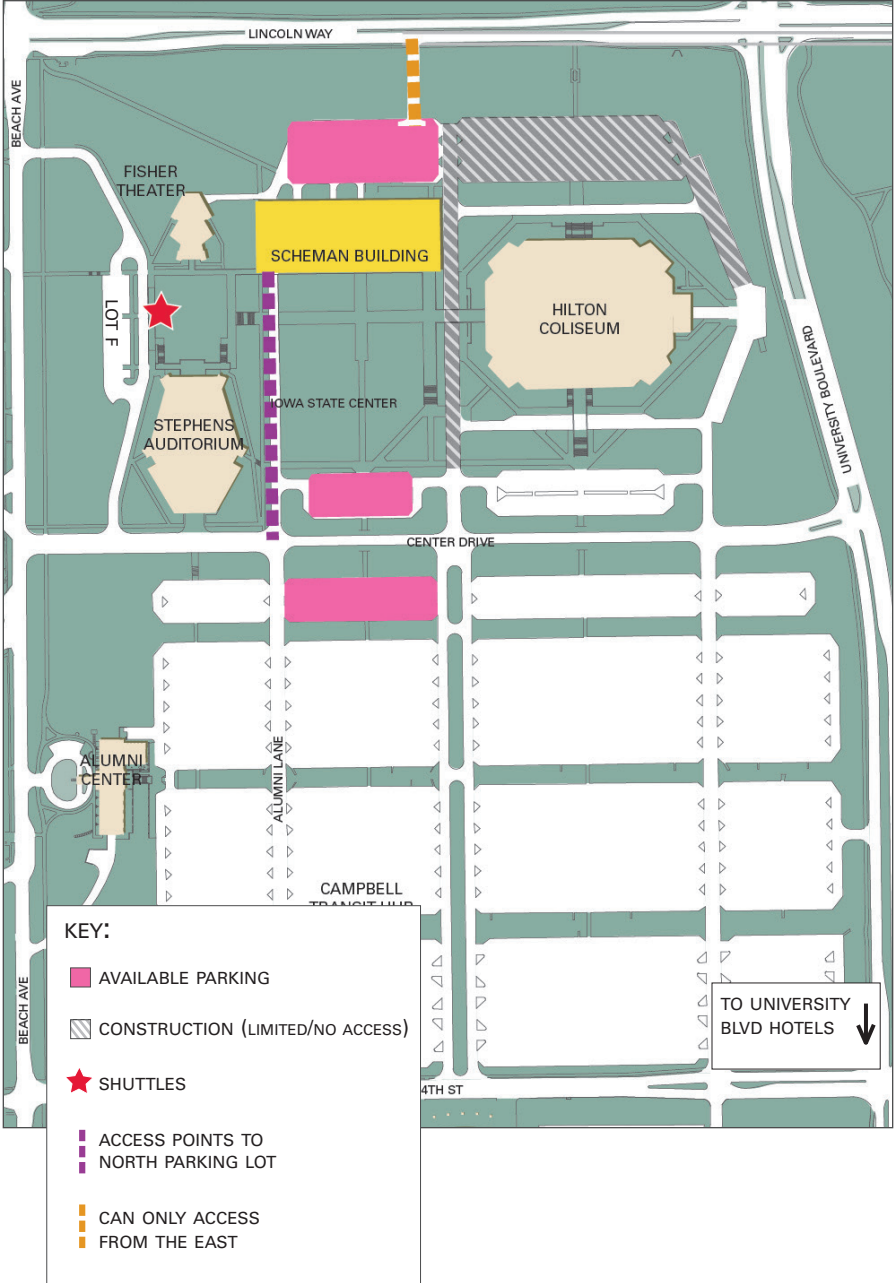

MAPS

REIMAN GARDENS: ENTRANCE AND PARKING



MAPS

UNIVERSITY BOULEVARD HOTELS

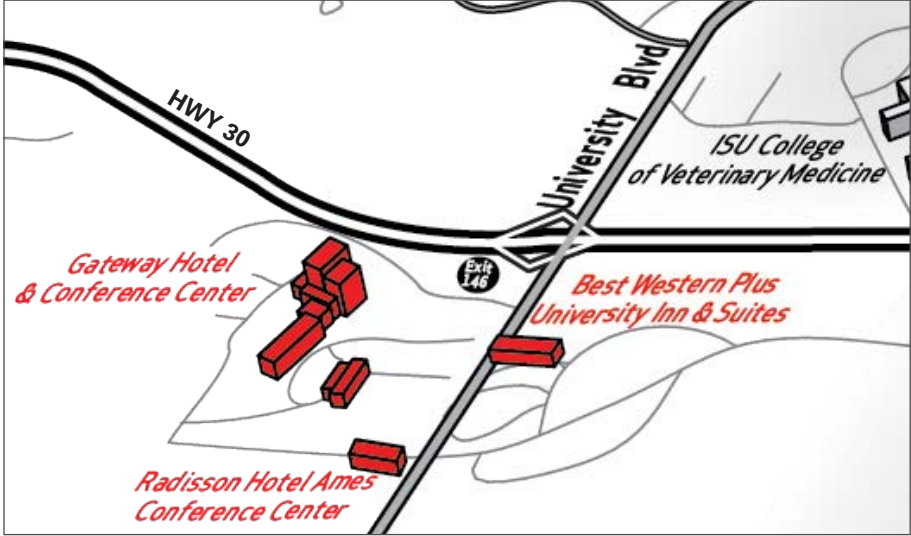

GATEWAY HOTEL & CONFERENCE CENTER

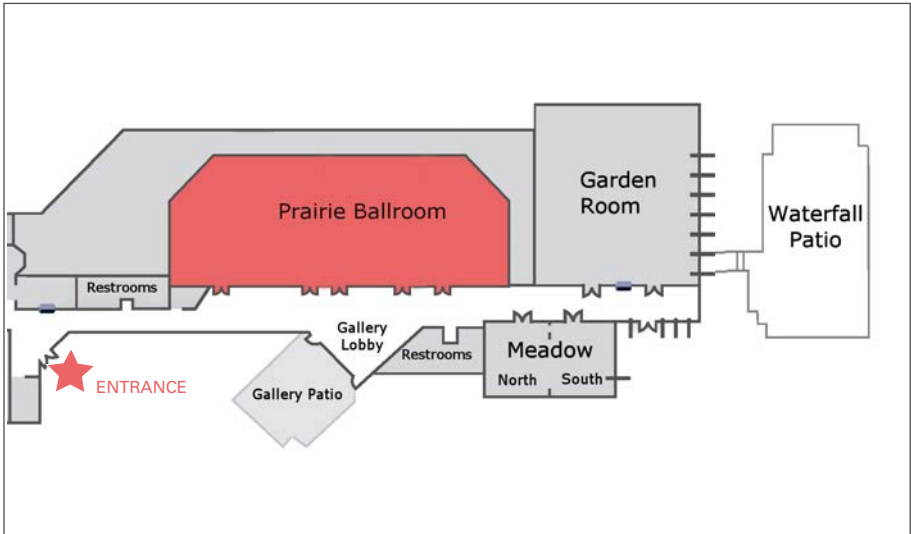

NOTES

NOTES

NOTES

NOTES

SCHEDULE AT-A-GLANCE

Tuesday, June 12, 2018

- Noon - 4:00pm NACTA Executive Committee Meeting, *Boardroom 080*
- Noon - 7:00pm Registration, *Scheman First Floor Lobby*
- 6:00 - 6:30pm Welcome Reception for First Time Attendees, *Scheman Outdoor Plaza*
- 6:30 - 8:30pm Welcome Reception for Everyone, *Scheman Outdoor Plaza*

Wednesday, June 13, 2018

- 7:00 - 8:00am Breakfast, *220-240*
- 8:30 - 10:00am Welcome and Keynote Speaker, *Benton Auditorium*
- 10:15am - 12:00pm Poster Session 1, *Second Floor Lobby*
- 12:00 - 1:00pm Lunch, *220-240*
- 1:00 - 2:30pm Oral Presentations, *150-154, 175-179, 250-252, 260-262, 275*
- 2:30 - 3:00pm Break, *First Floor Lobby*
- 3:00 - 4:30pm Oral Presentations, *150-154, 175-179, 250-252, 260-262, 275*
- 5:30 - 6:15pm Iowa State University Alumni Reception, *Reiman Gardens*
- 6:15 - 9:15pm Dinner at *Reiman Gardens*

Thursday, June 14, 2018

- 7:00 - 8:30am Breakfast, *220-240*
- 7:30 - 8:30am Committee Meetings, *250-252, 260-262, 275*
- 8:45 - 10:00am Oral Presentations, *150-154, 175-179, 250-252, 260-262, 275*
- 10:00 - 10:15am Midmorning Break, *First Floor Lobby*
- 10:15am - 12:00pm Workshops, *150-154, 175-179, 250-252, 260-262, 275, 299*
- 11:45am - 12:30pm Boxed Lunch, *First Floor Lobby*
- 12:15 - 12:30pm Tour Departure, *Lot F, Between CY Stephens and Fisher*
- 5:30pm Dinner on Your Own
- 6:00 - 8:00pm Graduate Student Reception, *Dublin Bay Irish Pub & Grill*

Friday, June 15, 2018

- 7:00 - 8:30am Breakfast, *220-240*
- 7:30 - 8:30am Committee Meetings, *175-179, 250-252, 260-262, 275*
- 9:00 - 10:00am Blue Ribbon Presentation, *Benton Auditorium*
- 10:15am - 12:00pm Poster Session 2, *Second Floor Lobby*
- 12:00 - 1:45pm Lunch & Business Meeting, *220-240*
- 2:00 - 4:15pm Oral Presentations, *175-179, 250-252, 260-262, 275*
- 5:30 - 6:30pm Social Hour, *Gateway Hotel and Conference Center, Prairie Ballroom*
- 6:30 - 8:30pm Awards Banquet & Closing Ceremony, *Gateway Hotel and Conference Center, Prairie Ballroom*

Saturday, June 16, 2018

- 9:00am - 12:00pm NACTA Executive Committee Meeting, *Boardroom 080*