



NACTA

north american colleges and teachers of agriculture
connect | develop | achieve

CONFERENCE PROGRAM



59th Annual NACTA Conference

Crossing Disciplinary Boundaries

June 25-29, 2013

The Inn at Virginia Tech and
Skelton Conference Center
Blacksburg, Virginia

 VirginiaTech
Invent the Future®

College of Agriculture and Life Sciences

NACTA Executive Committee 2012-2013

President
Rick Rudd
 Virginia Tech

President-Elect
Jeff Hattey
 Ohio State University

Immediate Past President
Jeannette Moore
 North Carolina State University

Secretary/Treasurer
Marilyn Parker

Journal Editor
Rick Parker

Historian
Kevin Donnelly
 Kansas State University

Membership Director
Ron Hanson
 University of Nebraska

Canadian Regional Director
Martin Zuidhof
 University of Alberta

Canadian Regional Director-elect
Kent Mullinix
 Kwantlen Polytechnic University

Central Regional Director
Kevin Bacon
 Western Illinois University

Central Regional Director-elect
Ann Marie VanderZanden
 Iowa State University

Eastern Regional Director
Mark Russell
 Purdue University

Western Regional Director
Brenda Seevers
 New Mexico State University

Southern Regional Director
Jean Bertrand
 University of Georgia

Virginia Tech Steering Committee

Susan Clark
 Jennifer Helms
 Jim McKenna
 Pavli Mykerezi
 Rick Rudd
 Susan Sumner

NACTA Committee Chairs & Liaisons

Journal Committee/ Editorial Board
Rick Parker

Journal Awards Committee
Neil Douglas
 (2012-2014)
 [3rd Term]
 Berea College

Membership & Public Relations Committee
Ron Hanson
 University of Nebraska

Educational Issues & Teaching Improvement Committee
Kimberly Moore
 (2012-2014)
 [1st Term]
 University of Florida

Teacher Recognition Committee
Nick Fuhrman
 (2011-2013)
 [1st Term]
 University of Georgia

International Committee
Chris Morgan
 (2013-2014)
 [Finishing term for Mark Russell]
 University of Georgia

Nominating/Distinguished Educator/Foundation Advisory Committee
Jeannette Moore
 North Carolina State University

Murray Brown Award Committee
Jeff Hattey
 Ohio State University

Delta Tau Alpha Liaison
Jean Gleichsner
 Fort Hays State University

NACTA Foundation Chair
Tom Lindahl

Interim NACTA Foundation Chairman
Kevin Donnelly
 Kansas State University

Judging Conference Liaison
Lyle Westrom
 University of MN-Crookston

APLU/CRERR/APS Liaison
Jean Bertrand
 University of Georgia

AASCARR Liaison
Billye Foster
 Tennessee Tech University

CFAVM & CADAP Liaison
Kent Mullinix
 Kwantlen Polytechnic University

CAPICU Liaison
Ed Brokaw
 Abilene Christian University

Program Chairs & Host Site Committee – 2012
Bonnie Walters
Tim Buttles
 University of Wisconsin

Program Chairs & Host Site Committee – 2013
Pavli Mykerezi
Jim McKenna
 Virginia Tech

Program Chair & Host Site Committee – 2014
Tracy Dougher
 Montana State University

Welcome Letter 4
Sponsors 4
Campus Map 5
Map of the Conference Center 6
Schedule 7
Oral Presentation Titles and Authors
 Wednesday 10
 Thursday 17
 Friday 20
Poster Session Titles and Authors
 Wednesday 22
 Thursday 29
 Friday 32
2013 NACTA Participant List 36
Notes 47
Schedule-at-a-Glance Back Cover

Welcome to Virginia Tech



On behalf of the faculty, staff and students of the College of Agriculture and Life Sciences, we welcome you to Blacksburg, Virginia. We are pleased to host the 59th Annual NACTA conference on the Virginia Tech campus in beautiful southwest Virginia. While you are here, you will have the opportunity to share pedagogy ideas, network with colleagues and make some new friends.

Since we last hosted the NACTA conference in 1999, Virginia Tech, like many institutions, has dramatically changed our curriculum and the majors we offer to the students on our campus. We come together in June 2013 for everyone to share how we have made these transformations and learn from each other.

Thank you for your commitment to enhancing educational scholarship on your campus.

Alan Grant
Dean

Susan Sumner
Associate Dean and
Director of Academic Programs

Thank you to our sponsors



College of
Agriculture and Life Sciences

Agricultural & Extension Education

CALS Office of Academic Programs

Center for Instructional Development and
Educational Research

Civic Agriculture & Food Systems Program

Department of Horticulture



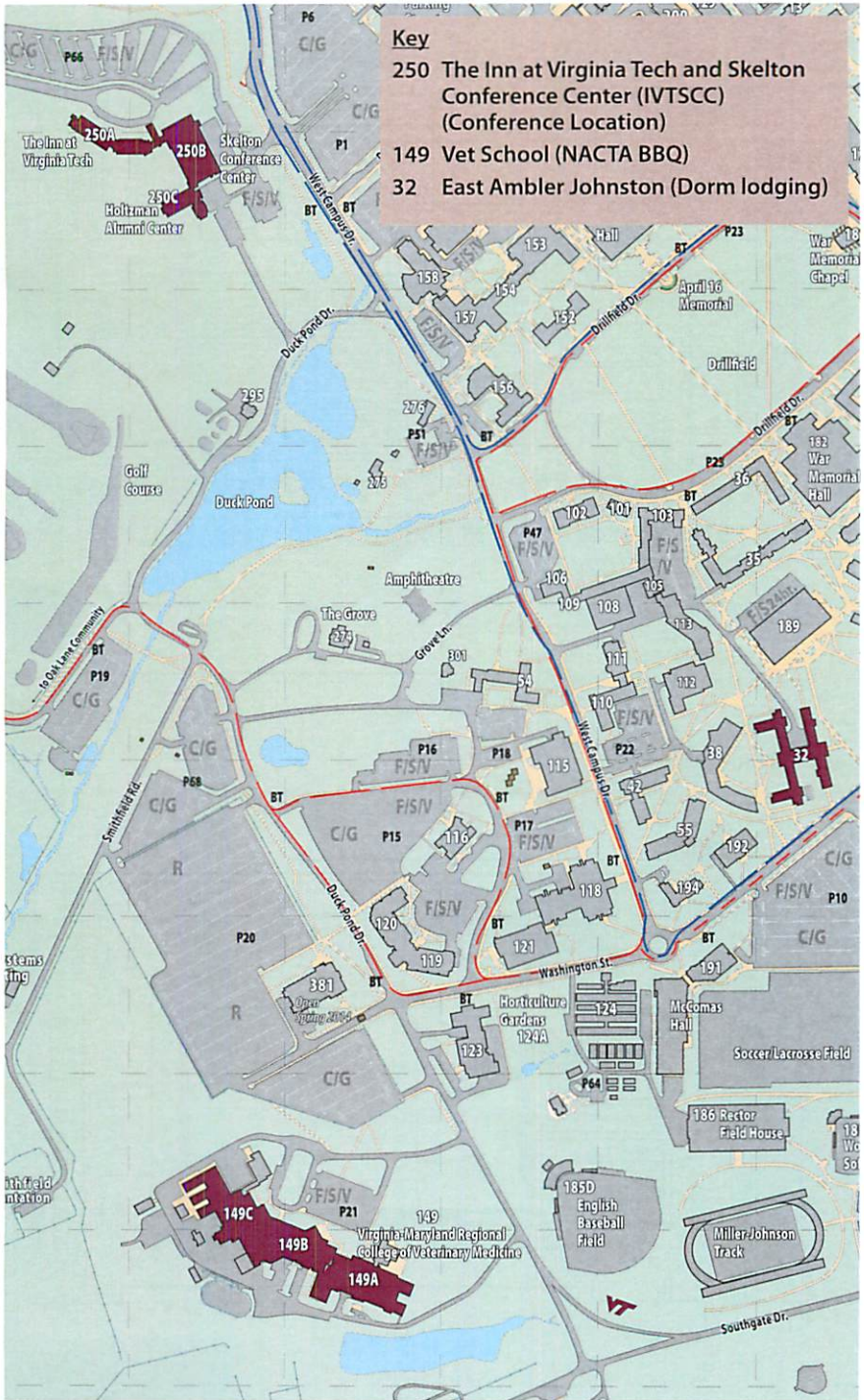

First Floor

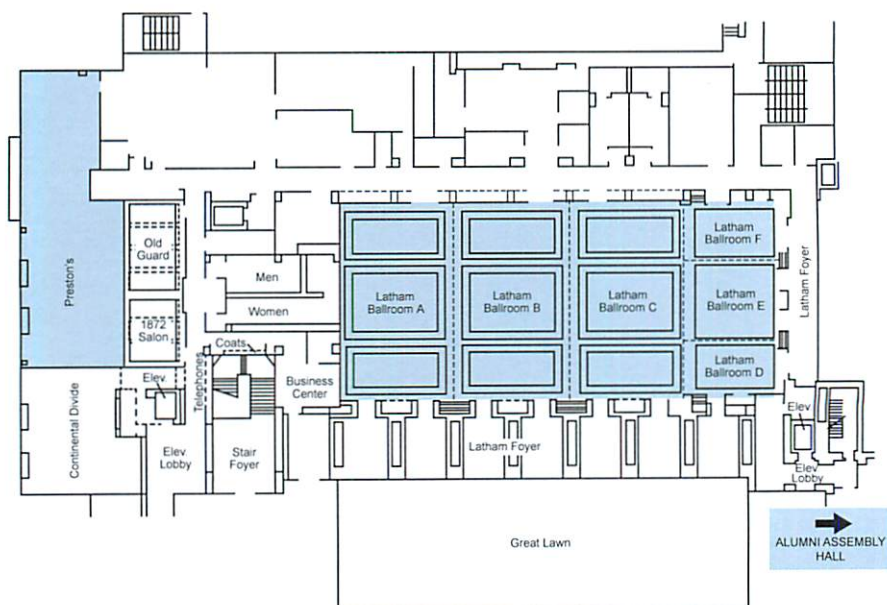

Second Floor

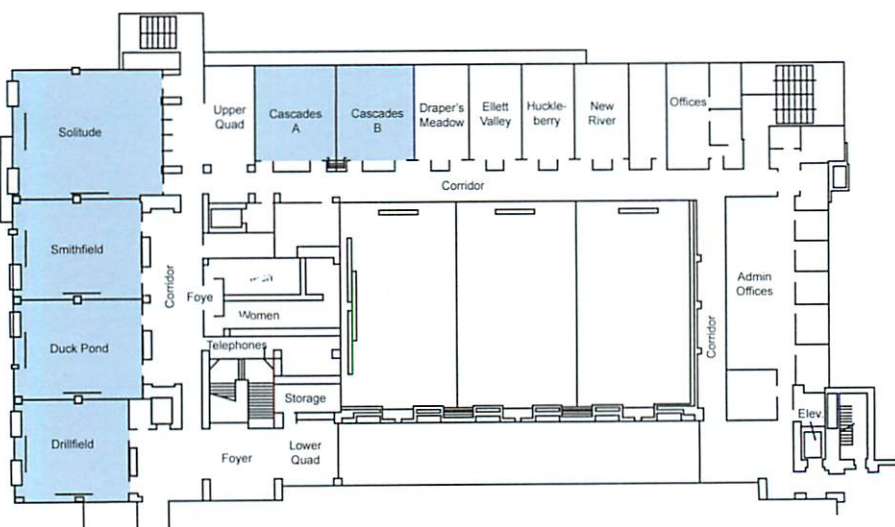

Tuesday, June 25, 2013

- 12:00 – 7:00 p.m. Registration Open, **Latham Ballroom Foyer**
- 1:00 – 4:00 p.m. NACTA Executive Committee Meeting, **Smithfield Room**
 NIFA/DOCE Meeting, **Duckpond Room**
 Pre-Conference Professional Development Experience:
 Assessing Outcomes of Teaching and Learning Experiences,
Solitude Room
- 6:00 – 9:00 p.m. Opening Reception, **Latham Ballroom, Salons A & B**

Wednesday, June 26, 2013

Book Auction and College Showcase will be held in the **Lower Quad** area at the top of the main staircase.

- 7:00 – 10:00 a.m. Registration Open, **Latham Ballroom Foyer**
- 7:30 – 8:00 a.m. Continental Breakfast, **Latham Ballroom Foyer**
- 8:00 – 9:30 a.m. Welcome and Keynote, **Latham Ballroom, Salons A-C**
 Welcoming Remarks: *Alan Grant, Dean, Virginia Tech College of Agriculture and Life Sciences*
 Keynote: *Michael Mullen, Vice Chancellor, North Carolina State University*
- 9:30 – 10:30 a.m. Poster Session and Break, **Latham Ballroom, Salons D-F**
Refreshments are available in the ballroom foyer. See page 22 for a list of posters and authors.
- 10:30 a.m. – 12:00 p.m. Concurrent Sessions
 Career, **Smithfield Room**
 Civic Agriculture and Food Systems, **Assembly Hall**
 Crossing Disciplinary Boundaries, **Cascades Room**
 Distance Education, **Drillfield Room**
 Diversity and Cultural, **Solitude Room**
 Pedagogy Strategies, **Duckpond Room**
- 12:00 – 1:30 p.m. Lunch, **Latham Ballroom, Salons A-C**
 Speaker: *Peter Doolittle, Director, Virginia Tech Center for Instructional Development and Educational Research*
- 2:00 – 3:30 p.m. Concurrent Sessions
 Crossing Disciplinary Boundaries, **Assembly Hall**
 Experiential Partnerships, **Smithfield Room**
 Technology, **Drillfield Room**
 Recruitment/Retention, **Cascades Room**
 Pedagogy Strategies, **Solitude Room**
 Pedagogy Strategies and Technology, **Duckpond Room**

Wednesday, June 26, 2013 *(continued)*

- 3:30 – 4:30 p.m. **Poster Session and Break, Latham Ballroom, Salons D-F**
Refreshments are available in the ballroom foyer. See page 22 for a list of posters and authors.
- 5:30 – 8:00 p.m. **BBQ at “The Grove” VA-MD Regional College of Veterinary Medicine (see map on page 5)**

Join us for a delicious local BBQ dinner and live bluegrass music from the Clover Hollow Boys. The BBQ is included for all conference participants, however, pre-registration is required. There will be a continuous shuttle from the Inn at Virginia Tech to The Vet School. Pick up location will be at the main entrance to the hotel, near the front desk area.

Thursday, June 27, 2013

Book Auction and College Showcase will be held in the **Lower Quad** area at the top of the main staircase.

- 7:00 a.m. – Noon **Registration Open, Latham Ballroom Foyer**
- 7:30 – 8:00 a.m. **Continental Breakfast, Latham Ballroom Foyer**
- 8:00 – 9:30 a.m. **Blue Ribbon Presentation, Latham Ballroom, Salons A-C**
Susie Whittington, Professor, Ohio State University
- 9:30 – 10:30 a.m. **Poster Session and Break, Latham Ballroom, Salons D-F**
Refreshments are available in the ballroom foyer. See page 22 for a list of posters and authors.
- 10:30 a.m. – 12:00 p.m. **Concurrent Sessions**
 Crossing Disciplinary Boundaries, Assembly Hall
 Diversity and Cultural, Smithfield Room
 Leadership, Drillfield Room
 Pedagogy Strategies I, Cascades Room
 Pedagogy Strategies II, Solitude Room
 Technology, Duckpond Room
- 11:45 – 12:15 p.m. **Pick up boxed lunches in the Latham Ballroom Foyer and proceed to your designated tour bus in front of the main entrance of the Inn at Virginia Tech (buses depart at 12:15 p.m.), Latham Ballroom Foyer**
- 12:00 – 12:15 p.m. **Board buses for tours, departing at 12:15 p.m.**
- 12:15 – 5:15 p.m. **Tours**
 Historic Blacksburg Tour
 New River Valley Farm Tour
 Civic Agriculture and Food Systems Tour
 Floyd County Sustainable Community Tour
- 5:15 p.m. **Dinner on your own**

Friday, June 28, 2013

Book Auction and College Showcase will be held in the Lower Quad area at the top of the main staircase.

- 7:00 – 9:00 a.m. Registration Open, Latham Ballroom Foyer
- 7:30 – 8:00 a.m. Continental Breakfast, Latham Ballroom Foyer
- 8:30 – 9:30 a.m. Committee Meetings, Latham Ballroom, Salons A-C
- 9:30 – 10:30 a.m. Poster Session and Break, Latham Ballroom, Salons D-F
Refreshments are available in the ballroom foyer. See page 22 for a list of posters and authors.
- 10:30 a.m. – 12:00 p.m. Concurrent Sessions
 University Leadership, Assembly Hall
 Experiential Study Abroad, Smithfield Room
 Pedagogy Strategies, Drillfield Room
- 12:00 – 2:00 p.m. Lunch & Business Meeting, Latham Ballroom, Salons A-C
- 2:00 – 4:00 p.m. Workshops
 Creating a coalition of farmers, ranchers, service providers, and educators to serve new farmers and ranchers
 Kim Niewolny, Donna Westfall-Rudd, Althea Whittier Cummings, and Sarah McKay, Virginia Tech
 Assembly Hall
- Interdisciplinary two-year associate degree programs in agriculture: A case study at Virginia Tech
 Pavli Mykerezi, Jim McKenna, Joe Guthrie, Sam Doak
 Smithfield Room
- Interdisciplinary programs to serve limited resource farmers
 Jewel Hairston, Virginia State University
 Drillfield Room
- Interdisciplinary programs serving international agriculture
 Kurt Richter, Tom Hammet, Virginia Tech Office of International Research and Development
 Cascades Room
- 5:30 – 6:30 p.m. Registration Open, Latham Ballroom Foyer
- 6:00 – 9:00 p.m. Banquet, Latham Ballroom, Salons A-C (included for all conference participants and paid guests)

Saturday, June 29, 2013

- 7:00 – 8:00 a.m. NACTA Executive Committee Breakfast, Preston's Restaurant
- 8:00 – 11:00 a.m. NACTA Executive Committee Meeting, Duckpond Room

Wednesday, June 26, 2013 • 10:30 a.m. – Noon

Civic Agriculture and Food Systems

Assembly Hall

Time	Submission ID	Title and Author(s)
10:30 a.m.	2013-0074	Growing a Civically Engaged Curriculum: The Evolving Story of the Civic Agriculture and Food Systems Minor Susan Clark and Kim Niewolny
10:35 a.m.	2013-0102	Companion Planting: The Reciprocity of Community-University Partnerships in Civic Agriculture and Food Systems Minor Jenny Schwanke, Rial Tombes, Sally Walker and Susan Clark
10:45 a.m.	2013-0134	Separating The Wheat From The Chaff: Negotiating Contested Terms In Agriculture Education Jacob N. Barney, Peter E. Ziegler, Steven C. Hodges, Cynthia M. Wood, Thomas P. Kuhar and Johanna Cricenti
10:55 a.m.	2013-0100	Cultivating Opportunity: Community Action Projects in the Civic Agriculture and Food Systems Minor CAPstone Course Susan Clark and Jenny Schwanke
11:05 a.m.	2013-0162	Assessing Civically Engaged Curriculum: Civic Agriculture and Food Systems Minor at Virginia Tech Jennifer Helms and Susan Clark
11:15 a.m.	2013-0163	Crossing Disciplinary Boundaries: Exploring Current and Future Roles of Graduate Students as Knowledge Producers and Educators in Higher Education Jennifer Helms, Sarah Misyak and Johanna Cricenti
11:25 a.m.	2013-0199	Co-learning in a Graduate-Level Food Systems Course: Interdisciplinary Perspectives on Course-Based Action Research Rachael Kennedy, Kim Niewolny, Sarah Ciamillo, Philip D-Adamo-Damery, Sarah Jonson, Lorien MacAuley, Havva Savran Al-Haik and Alexander Trutko
11:35 a.m.	2013-0174	Mapping the Campus Food System: Assessing Consumer Awareness of VT Dining Services Garden at Kentland Farm Johanna Z. Cricenti, Susan Clark, Holly Scoggins and J. Roger Harris

Career

Smithfield Room

Time	Submission ID	Title and Author(s)
10:30 a.m.	2013-0068	A Pipeline Model for Careers in Agriculture, Environmental and Life Sciences Linda L. Okiror, Usman Adamu, Rita Conley and Greg Madden
10:45 a.m.	2013-0006	Promoting Career Pathways within the New York State Food and Agricultural Sector Robert N. King
11:00 a.m.	2013-0126	Interactive Learning Assessment: Simulating Professional Practices Elizabeth Yakes, Andrea Cantarero, Tabitha McKay, Vanessa Svihla, Tim Castillo, Isaac Valdez and Justin Hertel
11:15 a.m.	2013-0168	Developing a Pipeline of Agriculture Students: Starting and Nurturing a Two-Year Agribusiness Program Dixie Watts Dalton
11:30 a.m.	2013-0219	Graduates of Agricultural Programs Attitudes Regarding Basic Employability Skills: A Pilot Study Ronald Heimler and Peter Kilduff

Distance Education

Drillfield Room

Time	Submission ID	Title and Author(s)
10:30 a.m.	2013-0049	Professional Development Needs of Swine Science Distance Education Instructors Brent Bjelland, Maggie Sprecher and Greg Miller
10:45 a.m.	2013-0061	Student Conceptions of the Nature of Science: Implications for Agricultural Education Hannah H. Scherer, Courtney Vengrin and Aaron Bond
11:00 a.m.	2013-0112	Integrating Quantitative Genetics and Genomics in Online Graduate Education Ronald M. Lewis, Gabriela C. Márquez and Barbara B. Lockee
11:15 a.m.	2013-0131	Developing a Distance Education Lab Course in Plant Biology Chad Jordan, James Mickle and Donna Wright
11:30 a.m.	2013-0138	Innovative Program Development in Agriculture Through Distance Education in the Insular Areas Christy L. Vineyard
11:45 a.m.	2013-0198	Experiential Learning in Quantitative Genetics Online: CyberSheep Ronald M. Lewis, Oddbjørn Hestnes, Eric Gilmore, Jackie Meese, Todd Ogle and Barbara B. Lockee

Wednesday, June 26, 2013 • 10:30 a.m. – Noon *(continued)*

Crossing Disciplinary Boundaries

Cascades Room

Times	Submission ID	Title and Author(s)
10:30 a.m.	2013-0023	Understanding Disciplinary Boundaries within Colleges of Agriculture: Implications for Graduate Student Development Caitlin Foley, Rama Radhakrishna and Mark Brennan
10:45 a.m.	2013-0041	Crossing Disciplines, Crossing Borders; Assessing Teacher Clarity in an International Setting R. Kirby Barrick and Seung Il Na
11:00 a.m.	2013-0062	Crossing International and Disciplinary Borders in Graduate Education Melanie Miller Foster, Thomas Gill and Daniel Foster
11:15 a.m.	2013-0121	Center for Education and Training in Agriculture and Related Sciences (CETARS): An Interdisciplinary Approach from K-12 to PhD to Work in Problems Facing Agriculture Félix R. Román, Marco de Jesus, Martha L. López, Oscar Perales-Perez and Winston Dela Torre
11:30 a.m.	2013-0172	Student Motivation and Learning Preferences in an Interdisciplinary Online Master's Degree Bradley Burbaugh, Tiffany Drape and Donna Westfall-Rudd
11:45 a.m.	2013-0229	Transdisciplinary Knowledge Transformation by Graduate Students Engaged in an Outreach Experience Melissa L. Welsh and Neil A. Knobloch

Diversity and Cultural

Solitude Room

Time	Submission ID	Title and Author(s)
10:30 a.m.	2013-0017	Toward Cultural Proficiency: How Much Confidence Can be Gained and what Benchmarks and Standards Can be Met in a College Course? Nicole Steinmetz, Suzie McMullen and M. Susie Whittington
10:45 a.m.	2013-0021	The Science Behind Traditional Knowledge: An In-Field Medicinal Plants Bioassay Method Boosts Science Engagement Of American Indian and Alaskan Native High School Students Barry Croom, Joshua Kellogg, Brittany Graf, Ilya Raskin, Nathalie Plundrich and Mary Ann Lila
11:00 a.m.	2013-0119	Pre-Health Collection: Resources to Enhance Your Instruction Martie Gillen

Time	Submission ID	Title and Author(s)
11:15 a.m.	2013-0124	Fed Beef Industry Employers' Expectations of Employees with Graduate Degrees Kevin Williams, Amanda Deal, Tanner Robertson and Lance Kieth
11:30 a.m.	2013-0242	Increasing Retention of Underrepresented Students through Peer Mentoring Brielle S. Wright, Jacquelyn R. Thomas, Ray Lewis and Curtis R. Friedel
11:45 a.m.	2013-0256	Student Preferences for M-learning Casey T. Meadows, Billy McKim and Tracy Rutherford

Pedagogy Strategies

Duckpond Room

Time	Submission ID	Title and Author(s)
10:30 a.m.	2013-0095	Impacts of the EARTH Program on Student Perceptions of Sustainability Kevin Duerfeldt and Cynthia Haynes
10:45 a.m.	2013-0217	Using Guided Discovery to Teach Students Feedstuff Identification in a Swine Production Course Brian D. Whitaker
11:00 a.m.	2013-0243	Effect of Background Experience on Student Perceptions of Ethical Issues in Animal Science Shannon M. Wyatt, Mark J. Anderson, Stanley F. Kelley, Marcy M. Beverly, Kyle J. Stutts and Jessica L. Lucia
11:15 a.m.	2013-0255	Undergraduate Students' Critical Thinking Dispositions and Trust in Sources of Information about Food Risks Darnell Towns, John C. Ricketts and Enefiok Ekanem

Wednesday, June 26, 2013 • 2:00 – 3:30 p.m.

Crossing Disciplinary Boundaries

Assembly Hall

Time	Submission ID	Title and Author(s)
2:00 p.m.	2013-0141	Trials and Triumphs of Delivering an Interdisciplinary Program: Spanish for the Agricultural Sciences Melanie Miller Foster and Alex Skucek
2:15 p.m.	2013-0142	Crossing Discipline Boundaries: The Role of Gamma Sigma Delta Honor Society of Agriculture: Past, Present and Future? Dennis Brink, Charlene Wolf-Hall, John B. Riley, Mike Brugger, Navam Hettiarachchy and Ed Rister

Wednesday, June 26, 2013 • 2:00 – 3:30 p.m. (continued)

Time	Submission ID	Title and Author(s)
2:30 p.m.	2013-0169	Sharing What Works: Best Practices of Collegiate Agricultural Student Organizations Kristopher M. Elliott and Misty D. Lambert
2:45 p.m.	2013-0201	Interdisciplinary Soft Skills: A Model for Integrating Public Speaking into Science-based Courses to Reduce Public Speaking Anxiety Chris Morgan, Nick Fuhrman, Milton Newberry and Sarah DeLoach
3:00 p.m.	2013-0236	Using Visuals to Facilitate Interdisciplinary Learning Maria Navarro
3:15 p.m.	2013-0274	Crossing Disciplinary Boundaries with Industry and University Students Chelsea Geiger, Dana Penrice, Craig Wilkinson and Martin Zuidhof

Experiential Partnerships

Smithfield Room

Time	Submission ID	Title and Author(s)
2:00 p.m.	2013-0020	Post-Graduation Community Engagement Habits of Service-learning Course Participants D. Knauff, S. Brackmann, S. Wilder and D. Berle
2:15 p.m.	2013-0031	Scientists in the Schools: Engaging Alaska Students in Marine Science Through an Innovative Teacher-Scientist Partnership Jance M. Straley
2:30 p.m.	2013-0069	Application of Service-Learning in two Courses for a Hands-on, Minds-in, and Hearts-felt Educational Experience Julie Grossman, Michelle Schroeder-Moreno, K. S. U Jayaratne and Sarah Smith
2:45 p.m.	2013-0133	Challenges and Opportunities in Developing the Student Farm as an Educational Resource: A Nationwide Delphi Study on Student Farms Stephen Ratasky, Michelle Schroeder-Moreno and K.S.U. Jayaratne
3:00 p.m.	2013-0188	Service Learning: An Avenue for Outreach, Recruitment and Training Stacey Darling-Novak and Jay Jones
3:15 p.m.	2013-0275	Community: In and Outside the Classroom Airell G.C. DesLauriers, Martin J. Zuidhof and Frank E. Robinson

Technology

Drillfield Room

Time	Submission ID	Title and Author(s)
2:00 p.m.	2013-0005	Creating Digital Learning Objects Using iPads to Enhance Traditional Courses Jeremy M. D'Antoni, Joseph E. Mehlhorn, Scott Parrott and Sandy Mehlhorn
2:15 p.m.	2013-0063	Twitter in the Classroom: A Comparative Case Study Melanie Miller Foster, Kortney Sherbine and Daniel Foster
2:30 p.m.	2013-0139	Smart Pens for Group Discussions and Assignments Tracy A.O. Dougher
2:45 p.m.	2013-0203	College Students' perceptions of Foodborne Illness Related Tweet Credibility Based on Features and Sources Caroline K. Black, Tracy Rutherford and Lori Moore
3:00 p.m.	2013-0249	A Pinteresting Possibility: Using Social Bookmarking To Promote Student Learning Courtney Gibson, Chelsey Ahrens and Erica Irlbeck
3:15 p.m.	2013-0273	Can I "Friend" You? Social Media Uses by Students in an Agricultural Student Orientation Course Cody Cramer and Shelly Peper Sitton

Recruitment/Retention

Cascades Room

Time	Submission ID	Title and Author(s)
2:00 p.m.	2013-0007	Progression of Undergraduate Student Advising Needs Caryn Filson and Susie Whittington
2:15 p.m.	2013-0147	The Relationship of Professor/Student Rapport with Undergraduate Students' Change in Motivation and Engagement Christopher M. Estep and T. Grady Roberts
2:30 p.m.	2013-0179	Examining College Transfer Student Integration: A Case Study Approach Adam A. Marx and Jon C. Simonsen
2:45 p.m.	2013-0224	The Necessary Social Dynamic Needed in Student Recruitment Marcus Pollard and Nicholas E. Fuhrman
3:00 p.m.	2013-0254	Impact of a STEM Program on Retention and Success of High Potential, High Performing Underrepresented Students Pamala V. Morris and John Patterson

Wednesday, June 26, 2013 • 2:00 – 3:30 p.m. (continued)

Pedagogy Strategies

Solitude Room

Time	Submission ID	Title and Author(s)
2:00 p.m.	2013-0004	Mitigating the Misery: Using an Application and Reflection Sequence to Reduce Student Anxiety in a Graduate-Level Applied Statistics Course Alyx M. Shultz
2:15 p.m.	2013-0087	Comparing Multiple Intelligences of College Instructors and Their Students C.A. Allen and W.L. Hurley
2:30 p.m.	2013-0118	An Examination of Student Learning: Test Preparation and Test Anxiety Martie Gillen
2:45 p.m.	2013-0125	Innovative Classroom Strategies that Prepare Graduates for Success in the Workplace Richard J. Rateau, Eric K. Kaufman and D. Adam Cletzer
3:00 p.m.	2013-0145	The Development of Best Practices in Mentoring Undergraduate Research Christopher M. Estep, Byron C. Housewright and Mary R. Bennett
3:15 p.m.	2013-0164	Preparing to Teach Agricultural Education: An Examination of Student Teachers' Instructional Plans and Planning Wendy J. Warner and Joy M. Marshall

Pedagogy Strategies and Technology

Duckpond Room

Time	Submission ID	Title and Author(s)
2:00 p.m.	2013-0001	An Analysis of Technologically Enhanced Learning Environments in the Agricultural Sciences Jaron Jones, Antoine Alston, Chastity W. English and Godfrey Gayle
2:15 p.m.	2013-0091	Precision Agriculture Technology Troubleshooting Curriculum Development: Cooperation and Collaboration with the Agricultural Equipment Industry Royce Hatch, Michael L. Pate, Bruce Miller and Richard Beard
2:30 p.m.	2013-0225	The Relationship between Socialization, Persistence to Complete and Campus or Online Program Type of College of Agriculture Master's Students Danielle E. Hammond and Candice A. Shoemaker

Thursday, June 27, 2013 • 10:30 a.m. – Noon

Crossing Disciplinary Boundaries

Assembly Hall

Time	Submission ID	Title and Author(s)
10:30 a.m.	2013-0008	GoFarm Hawaii: Multi-campus, Interdisciplinary Farmer Training with Public/Private Support Steven Chiang
10:45 a.m.	2013-0089	Crossing Disciplinary Boundaries: Getting Small Groups to Actually Work in the Classroom Gary Moore
11:00 a.m.	2013-0159	Bringing Disciplines Together: Using the PERT Model to Reinforce Transdisciplinary Concepts during an Intensive Student Camp Experience Matthew J. Shultz and W. Wade Miller
11:15 a.m.	2013-0193	Models for Teaching Interdisciplinary Biofuels Science: A Multi-pronged Approach Kateel Shetty, Nina De La Rosa, Krishnaswamy Jayachandran and Mahadev Bhat
11:30 a.m.	2013-0230	Extending the teaching mission of a land grant university: Incorporating an interdisciplinary capstone experience with an Extension program S. Dee Jepsen and Andrew J. Mann
11:45 a.m.	2013-0251	Crossing Disciplinary Boundaries: The Case of the Honors Interdisciplinary Studies Major Maria Navarro

Diversity and Cultural

Smithfield Room

Time	Submission ID	Title and Author(s)
10:30 a.m.	2013-0015	Exploring Educational Attainment of Undergraduate Minority Students in Land-Grant Institutions Lisa S. Hightower, Hao Lu, Mary A. Marchant, Eric Vance, William Richardson, Eric Smith and Tim P. Mack
10:45 a.m.	2013-0050	Use of Multimedia to Increase Comprehension in an Introductory STEM Course Tim G. Rozell, Ashley E. Rhodes and Jessica G. Winkler
11:00 a.m.	2013-0037	Chinese Students, American Classrooms: Lessons Learned from a Teaching and Learning Circle at Iowa State University Ann Marie VanDerZanden, Jay Newell and Aili Mu
11:15 a.m.	2013-0054	Comprehensive Oral Final Exams Improve Student Learning Through Social Constructivism Tim G. Rozell, Ashley E. Rhodes and Jessica G. Winkler

Thursday, June 27, 2013 • 10:30 a.m. – Noon *(continued)*

Time	Submission ID	Title and Author(s)
11:30 a.m.	2013-0090	Nuts and Bolts of Freshman Orientation: Preparation for Life for Generation iY. Dana J. Minihan and Kevin J. Donnelly
11:45 a.m.	2013-0093	Assessment of the Multicultural Scholars Program at [State] State University Aaron J. McKim, Kate Field, Wanda Crannell, Larry Curtis, Dave Stone and Jonathan J. Velez

Leadership

Drillfield Room

Time	Submission ID	Title and Author(s)
10:30 a.m.	2013-0010	Building Capacity in Virginia 4-H State Cabinet Leaders Tonya T. Price and Billie Jean Elmer
10:45 a.m.	2013-0028	A Framework for Leadership Development Curricula for Ag Advocates in the College of Agricultural Sciences at [State] University Rebecca Heilman, John Ewing, Rama Radhakrishna and Mark Threeton
11:00 a.m.	2013-0076	ILFI-Wheel: An Innovative Leadership Assessment Aaron McKim, Jonathan J. Velez, Jon C. Simonsen and Robert J. Birkenholz
11:15 a.m.	2013-0077	Identifying the Needs in a Leadership Development Program Aaron J. McKim, Jonathan J. Velez and Jon C. Simonsen
11:30 a.m.	2013-0084	Leadership Academy: A Model for Meeting the Leadership Needs of College of Agriculture Students Tyson Sorensen, Kellie Strawn, Aaron McKim and Jonathan Velez
11:45 a.m.	2013-0183	The Benefits of Structured Reflection as Part of Adult Leadership Programming Avery Culbertson and Hannah Carter

Pedagogy Strategies I

Cascades Room

Time	Submission ID	Title and Author(s)
10:30 a.m.	2013-0013	Science & Religion: Friends or Foes? Michael J. Ellerbrock
10:45 a.m.	2013-0040	Rethinking Course Structure: Student Perceptions of Flipping a Classroom Nathan W. Conner, Christopher T. Stripling, Jessica Blythe, T. Grady Roberts and Nicole L. P. Stedman

Time	Submission ID	Title and Author(s)
11:00 a.m.	2013-0158	Teaching the Unknown Through Flipped Classroom Techniques Emily Buck and Jeff Hattey
11:15 a.m.	2013-0180	Flip It or Flop It: Semi-flipping Classes to Promote Student Engagement Courtney Gibson and Erica Irlbeck
11:30 a.m.	2013-0231	The Paradox of Structure: What is the Appropriate Amount of Structure for Course Assignments with Regard to Students' Problem-Solving Styles? Curtis R. Friedel and Megan M. Seibel
11:45 a.m.	2013-0250	High School Students Learn about GMOs Using an Inquiry-driven Case Study Melissa L. Welsh, Anne V. Brown, Elisabeth Svedin and Neil A. Knobloch

Pedagogy Strategies II

Solitude Room

Time	Submission ID	Title and Author(s)
10:30 a.m.	2013-0071	Outcomes/Reflections of Student Poster Presentations at National and International Scientific Conferences Ingelia White
10:45 a.m.	2013-0181	College Student Disengagement based on Motivation and Values Toward an Education Adam A. Marx and Jon C. Simonsen
11:00 a.m.	2013-0235	Behaviorism and Constructivism in Animal Science Laboratory Classes; Evaluated by Skill Performance, Student Confidence, and Heart Rate A.E. Lowrey, J.A. West, K.K. Turner, D.W. Duncan, N.E. Fuhrman and C.R. Dove
11:15 a.m.	2013-0237	Factors Impacting Female Students' Decision to Enroll in an Agricultural College E.J. Carter, D.W. Duncan, N.E. Fuhrman and K.J. Rucker
11:30 a.m.	2013-0261	Cross Disciplinary Boundaries by Hosting the NACTA Conference Bonnie Walters and Tim Buttles

Technology

Duckpond Room

Time	Submission ID	Title and Author(s)
10:30 a.m.	2013-0014	Integrating Web-based Student Response Systems in the Classroom: Krystal Drysdale and Orlen Grunewald

Thursday, June 27, 2013 • 10:30 a.m. – Noon *(continued)*

Time	Submission ID	Title and Author(s)
10:45 a.m.	2013-0127	Developing Reflective Practitioners through VoiceThread Technology Laura L. Sankey Rice and Daniel D. Foster
11:00 a.m.	2013-0157	Google Hangouts: Keeping Connected through Technology Caroline A. Sheffield, Wendy J. Warner and D. Barry Croom
11:15 a.m.	2013-0241	Assessment of Students' Crisis Communications Skill Increase based on Classroom Instruction and Second Life™ Training Leslie D. Edgar, Don W. Edgar, Jessica England, Tracy Rutherford, David Doerfert and Theresa Pesl Murphrey
11:30 a.m.	2013-0195	Usability of a Virtual World for Education: Implications for Teaching in Colleges of Agriculture Theresa Pesl Murphrey, Tracy A. Rutherford, David L. Doerfert, Leslie D. Edgar and Don W. Edgar

Friday, June 28, 2013 • 10:30 a.m. – Noon

University Leadership

Assembly Hall

Time	Submission ID	Title and Author(s)
10:30 a.m.	2013-0003	Campus-Wide Participatory Planning: Moving Quickly from Thought to Action Blake H. Thomas and Roslynn Brain
10:45 a.m.	2013-0218	Climate for Teaching in Participating APLU Institutions Jeremy M. Falk, Kattlyn J. Wolf, Shannon Blickenstaff, Daniel D. Foster, Laura Sanky-Rice and John Foltz
11:00 a.m.	2013-0220	Partnerships in Fisheries Technology: Building Our Leaders of Tomorrow in Fisheries and Ocean Sciences Through Collaboration Between Industry, Management and Academia Jeffrey M. Johnston, Kate Sullivan and Jim Seeland
11:15 a.m.	2013-0227	A Strategic Planning Process to Increase Student Engagement Michelle Mullins Santiago, Foy D. Mills Jr. and L.A. Wolfskill
11:30 a.m.	2013-0248	Developing a New College Mission Statement Kelsey Hall, Camille Kalkman and Rebecca Lawver

Time Submission ID Title and Author(s)

Experiential Study Abroad

Smithfield Room

Time Submission ID Title and Author(s)

10:30 a.m.	2013-0137	Cultural Adaptation: Study Abroad in Swaziland Nathan W. Conner and T. Grady Roberts
10:45 a.m.	2013-0171	Students Speak Out: How Should Universities Prepare Students for Study Abroad Experiences? Sarah DeLoach, Nicholas Fuhrman, Dennis Duncan and Marta Hartmann
11:00 a.m.	2013-0173	Collaborative Online International Learning Matt Spindler and Florence Obiageli Ifeanieze
11:15 a.m.	2013-0216	Project Imuris: An International Microteaching Experience Edward A. Franklin
11:30 a.m.	2013-0232	Joys and Discomforts of Multi-institutional Collaborative Global Education Daniel D. Foster, R. Kirby Barrick and Melanie J. Foster

Pedagogy Strategies

Drillfield Room

Time Submission ID Title and Author(s)

10:30 a.m.	2013-0024	Is there a Relationship Between Test Review, Sample Test, and Test Performance? Rama Radhakrishna, Brad Olson and John Ewing
10:45 a.m.	2013-0156	Predicting the Quality of an Undergraduate Course Using the IDEA Survey Mark Anderson, Kyle Stutts, Marcy Beverly and Stanley Kelley
11:00 a.m.	2013-0175	Managing Individualized Capstone Experiences in a Large Department C. M. Wood, D. M. Denbow, D. E. Eversole, M. A. McCann, A. P. McElroy, R. S. Splan and N. M. Tamim
11:15 a.m.	2013-0177	A Picture is Worth a Thousand Words: Low Stakes Assessments David Jones
11:30 a.m.	2013-0226	Integrating Experiential Learning and its Assessment to enhance Student Learning Kulbhushan Grover and Shelly Stovall
11:45 a.m.	2013-0258	Speed Selling as an Oral Exercise in Evaluation Classes J. S. McCann

Wednesday, June 26, 2013 • 9:30 – 10:30 a.m.
Crossing Disciplinary Boundaries

Latham Ballroom D, E, F

Poster	Submission ID	Category	Title and Author(s)
1	2013-0046	1	How Do Graduate Students Perceive their Graduate Advisor at Razi University Kiumars Zarafshani and Mahsa Sadvandi
2	2013-0029	1	Providing Underrepresented Agriculture Students a STEP UP to USDA Career Success Shad D. Nelson, Randy Stanko, Tanner Machado and Greta Schuster
3	2013-0039	1	Growing a “Canoe Plant” Garden for 4th Grade Learner Centered Instruction in Social Studies and for College Ag Club Connection with Community Keiki Aleysia Kaha, Norman Arancon, Russell Shiohita, Marcia Sakai, William S. Sakai, Pattie Andrade-Spencer and Debra Cheever-Follett
4	2013-0044	1	Crossing Disciplines: AG-STEM Education Research Lab R. Kirby Barrick, Brian E. Myers and Andrew C. Thoron
5	2013-0058	1	Assessing Student Learning Outcomes Across Disciplines: Time Series Grade Distributions for Agricultural Core Courses Within a Small State University Program of Agriculture C.R. Stark, Jr., P.B. Francis, W.A. Whitworth and K.J. Bryant
6	2013-0059	1	The Impact of Corrected Exams (Regrades) on Final Exam Score Jessica Winkler, Andrea Sexton, Ashley Rhodes and Tim Rozell
7	2013-0075	1	Purdue Arboretum: Scan, Link, and Learn Paul C. Siciliano, Kirby Kalbaugh and Andrea Brennan
8	2013-0083	1	Teaching, Research, and Extension in the 21st Century Land Grant System: Implications for Graduate Education Anil Kumar Chaudhary, Rama Radhakrishna and Mark Brennan
9	2013-0086	1	Assisting Students in Need of Academic Action Rebecca G. Lawver, Taylor Adams, Lisa Allen and Janet B. Anderson

Poster	Submission ID	Category	Title and Author(s)
10	2013-0096	1	Developing Growth Mindsets and Emphasizing Effort: Faculty and Student Development. Cynthia Haynes, Suzanne Hendrich, Jan Thompson, Barb Licklider and Jan Wiersema
11	2013-0097	1	Factors Influencing Student Choice of Major Christina Leard, Thomas Dobbins, Kendall Kirk and Dale Layfield
12	2013-0103	1	Master's International Program Facilitating Student Empowerment: Implications for Educators Tegan J. Walker, James R. Lindner and Cathryn A. Clement
13	2013-0107	1	Animal Science 101: Back to the Basics Dan Stein, Trent Hughes, Clint Mefford, Blake Bloomberg, Rachel E. Thornburg and Jon W. Ramsey
14	2013-0113	1	The Inclusion of an International Agricultural Education Course at the Post- Secondary Level Thomas Kingery
15	2013-0129	1	The Role of Student Farm on Interdisciplinary Agroecology and Environmental Studies Curriculum, Research and Outreach Miles Medina, Mahadev Bhat and Krishnaswamy Jayachandran
16	2013-0143	1	Critical Thinking and Cognitive Skills in Large Lecture Classes Effects of Body Weight and Exercise Level Angela Anderson, Deborah J. Good, Matthew Komelsky and Craig Brians
17	2013-0161	1	Preparing Hispanics for Leadership in the Applied Statistics Field Jesus Cuellar-Fuentes
18	2013-0192	1	Understanding Agricultural Scientists' Information Delivery Behavior and Farmers' Information Receiving Preferences for Educating Farmers K. S. U. Jayaratne
19	2013-0206	1	Using a Pumpkin Patch to Engage Native Hawaiian K-5 Students in Agricultural Sciences. Ann Emmsley, Gwen Moringa-Kama, William Jacintho, Mach Fukada and Cynthia Nazario-Leary

Wednesday, June 26, 2013 • 9:30 – 10:30 a.m. (continued)

Poster	Submission ID	Category	Title and Author(s)
20	2013-0209	1	Interdisciplinary Service Learning: Strategies for success Sarah K. Hanks and Nicholas A. Clegorne
21	2013-0210	1	Art Appreciation vs. Craft: A New Approach to Floral Design as a Creative Arts Course Dwayne Pavelock, Sharon Frey, Stanley Kelley and Marsha Harman
22	2013-0240	1	Developing a New College Name Through Faculty and Stakeholder Input Rebecca G. Lawver and Kelsey Hall
23	2013-0244	1	Mentoring Student Interns in Farm-to-Fork Opportunities Kelsey Hall, Jennifer Reeve and Tamara Steinitz
24	2013-0252	1	Addressing Opportunities in Forestry and Natural Resources at an 1890 Land Grant Institution Christopher Catanzaro and Greg Frey
25	2013-0263	1	Agricultural Literacy in the U.S. Althea Whitter-Cummings and Rick Rudd
26	2013-0270	1	Inspiring 7 to 12 Graders by Connecting A-STEM Nanotechnology to Virginia SOLs and Society Godwin O. Mbagwu, Grace M. Ndip, Daniel T. Stoelting, Hua Shen, Stephanie Ellis and Bree Taylor
27	2013-0272	1	The VT/IALR Molecular Plant Science Summer Camp; Hands-on Research and Residential Experiences for Rising Seniors in Southside Virginia Scott Lowman, Jerzy Nowak, Stephanie Hudson and Bingyu Zhao
28	2013-0182	1,2	A Multidisciplinary Approach to Improve Critical Thinking and Scientific Writing in an Introductory Environmental Science Class Jessica Braswell and Greg D. Pillar
29	2013-0245	1,2	Integrating Outputs of the Poultry and Egg Education Project (PEEP) into a Program Development and Evaluation Course John C. Ricketts, Sandria Godwin, Edgar Chambers and Sheryl C. Cates
30	2013-0178	1,2,3	Who Let the Dogs Out? The Influence of Guide Dogs on the Teaching and Learning Experience of Students and Faculty Jason Ro, John Lee and Nicholas E. Fuhrman

Poster	Submission ID	Category	Title and Author(s)
31	2013-0211	1,3,5	Engaging Community Stakeholders in Multidisciplinary Agricultural Education Program Delivery Jeremy Falk, Douglas Masser and Daniel Foster
32	2013-0052	6, 1	Soils, Land Use and Climate Change: A New Baccalaureate Concentration which Crosses Disciplinary Boundaries M. Francesca Cotrufo, Meena Balgopal, Rich Conant, Steve Ogle and Keith Paustian.
33	2013-0019	5, 1	Incorporating Multi-Disciplinary Cooperation Through Student Research Projects Sandy Mehlhorn, Jason Roberts and Chris Karmosky
34	2013-0202	2,5	College Students' use of Twitter and Perceptions of Credibility Features Caroline K. Black, Tracy Rutherford and Lori Moore
35	2013-0293	2	Club de Agro-Microbios: An Interdisciplinary Effort to Promote Agricultural Microbiology at Public Schools of Puerto Rico Lydia I. Rivera Vargas, Patricia Ortiz Bermudez, Merari Feliciano and Leyda Ponce de León

Wednesday, June 26, 2013 • 3:30 – 4:30 p.m.

Innovative Teaching Approaches

Latham Ballroom D, E, F

Poster	Submission ID	Category	Title and Author(s)
1	2013-0009	2	Using Student Teams for Experiential Learning Opportunities Sandy A. Mehlhorn and Joey Mehlhorn
2	2013-0012	2	Enhancing Civic Engagement Through International Agricultural Travel Study S.A. Mehlhorn and J.E. Mehlhorn
3	2013-0018	2	Faculty and Undergraduate Education: Teaching Interdisciplinary Research Through the Fellows Research Program Jeremy M. D'Antoni, Sandy Mehlhorn, Timothy N. Burcham and Jason Roberts
4	2013-0025	2	Using Video Modules to Help Students Solve Agronomic Calculations Samantha Ambrose and Sarah Lancaster
5	2013-0026	2	A Day in the Life of a Manager: An Experiential Learning Project Maud Roucan-Kane, L. A. Wolfskill and Julie Cooper

Wednesday, June 26, 2013 • 3:30 – 4:30 p.m. (continued)

Poster	Submission ID	Category	Title and Author(s)
6	2013-0027	2	The Evolution of Teaching Technology in Graduate Online Programs J.E. Mehlhorn, T.N. Burcham, S.A. Mehlhorn and S.Parrott
7	2013-0033	2	Engaging Students in Service Learning Through a Landscape Development Project Michael R. Mohney, Martin R. McGann and Dan T. Stearns
8	2013-0038	2	ThinkSpace 2.0: An Online Teaching and Learning Platform for Case Based Learning Ann Marie VanDerZanden
9	2013-0042	2	Retaining Students and Supporting Instruction in Science-Intensive Undergraduate Programs through Innovative Media April Ulery, Barbara Chamberlin and Jeanne Gleason
10	2013-0043	2	A Virtual Coffee Shop as a Catalyst for Providing Agricultural Extension Education for Tennessee Landowners Solomon Haile and Latif Lighari
11	2013-0047	2	Increasing Students' Attendance at Career Fairs Maud Roucan-Kane, L. A. Wolfskill and Julie Cooper
12	2013-0048	2	The Welcome to Class Speech: The Doe's and Don'ts according to university students Maud Roucan-Kane, L. A. Wolfskill and Julie Cooper
13	2013-0056	2	Hybrid Learning in the Food Science Curriculum Through the Use of an In-Class Assessment Tool Drs. Paul J. Sarnoski and Maurice R. Marshall
14	2013-0060	2	Educational Projects as an Strategy to Innovate Teaching at National Agrarian University La Molina, Peru Carlos Gomez, Silvia Morarles and Jan Elen
15	2013-0072	2	SWIPE Out Hungers Service-Learning Project Jean Gleichsner
16	2013-0080	2	Theory to Practice: Boot Camp – A Unique Capstone Course for Pre Service Agriculture Teachers Prior to Student Teaching A. A. Granata, P. M. Favel, S. G. Lawrence and T. R. Dobbins

Poster	Submission ID	Category	Title and Author(s)
17	2013-0081	2	Food Safety and Agroterrorism Training: Educating Our Future Workforce Doug Morrish, P. Ryan Saucier and Nora Garza
18	2013-0082	2	Is There a Significant Difference? A Comparison of Student Learning Outcomes in Face-to-Face and Online Courses K. S. U. Jayaratne and Gary Moore
19	2013-0085	2	Agriculture Faculty Mentoring: Serving the Leadership Needs of Undergraduate Students Tyson Sorensen, Kellie Strawn, Aaron McKim and Jonathan Velez
20	2013-0088	2	Reaching the Unreached: An Innovative Approach to Recruiting Students Tyson Sorensen
21	2013-0092	2	Crossing Disciplinary Boundaries Using a BRIDGE: Building Research Interest and Developing Global Engagement. Kimberly D. Gwinn, Joanne Logan, Aggy Vanderpool and CaulaA. Beyl
22	2013-0098	2	Food Safety in Agritourism – From Seed to Table Janice Branson and Melinda Anderson
23	2013-0104	2	Increasing Horticulture Based Outreach and Extension Program Activities by Delaware Cooperative Extension Rose Ogutu, Andy Wetherill, Troy Darden, John Clendaniel and Maggie Moor-Orth
24	2013-0109	2	Virtual Nursery Field Trips to Improve Instruction in Nursery Production Amy Wright, Jim Robbins and Mengmeng Gu
25	2013-0115	2	An Evaluation of Undergraduate Engagement in Structured Nutrition Research Activities Amanda L. Ford and Wendy J. Dahl
26	2013-0117	2	Using Reflective Journals to Gain Insight into an Agricultural Communication Intensive Study Tour Amanda Northfell, Leslie D. Edgar and Jefferson D. Miller
27	2013-0120	2	Activities for Teaching Undergraduate Social Science Research Methods Martie Gillen
28	2013-0128	2	Preparing for the Transformative Learning Experience: Teacher Candidate Summative Reflection Presentations Daniel D. Foster, Laura L. Sankey Rice and John C. Ewing

Wednesday, June 26, 2013 • 3:30 – 4:30 p.m. (continued)

Poster	Submission ID	Category	Title and Author(s)
29	2013-0130	2	Will Work for Food: Utilizing Graduate Students in Advising Undergraduate Student Organizations Caryn Filson and Julie Robinson
30	2013-0136	2	Interdisciplinary Intramural Practice: Instrumental in the Development of Entrepreneurship and Transferable Skills for Students of Agricultural Sciences Gladys M. Gonzalez and Angel L. Gonzalez
31	2013-0140	2	Promoting Language Acquisition in a Contextually Relevant Undergraduate Course via Microblogging Melanie Miller Foster
32	2013-0144	2	Experiential-Based Learning For Beef Production: Internships To Build Case Studies Dennis Brink, Dennis Burson, Tom Field, Dann Husmann, Bryan Reiling, Walter Schacht and Matt Spangler
33	2013-0146	2	Teaching Soft Skills to Undergraduate Agriculture Students Makenna Lange and Erica Irlbeck
34	2013-0106	5, 4	Cutting Final Cut: Replacing Discontinued Software for a Video Editing Lab Amanda Garcia and Erica Irlbeck
35	2013-0154		Understanding Alumni at [University] for Increased Alumni Association Membership and Involvement Faith Jurek, Robert Jones, Chancy Price, Brent Aiken and Erica Irlbeck
36	2013-0148	2	Fostering Critical Thinking Skills through Use of Reflections in an Undergraduate Agricultural Issues Course Christopher M. Estep
37	2013-0149	2	In-Class Team Application Exercises and their Impact on Information Retention Lisa Orgler
38	2013-0215	2	College of Agriculture and Life Sciences Graduate Teaching Scholars Program Opens New Doors for Future Faculty Candidates Courtney Vengrin, Gabrielle Fundaro, Mara Grossman, Matt Schroeder, Jason Smith, Dan Tekiela, Liyun Ye and Donna Westfall-Rudd

Thursday, June 27, 2013 • 9:30 – 10:30 a.m.

Learning Outcomes Assessment

Latham Ballroom D, E, F

Poster	Submission ID	Category	Title and Author(s)
1	2013-0185	2,3	Comparison of Student Blogs at the Beginning and End of an International Experience Jennifer Minick Bormann, Teresa L. Douthit, and Scott L. Schaake
2	2013-0186	2,3	Bloggng as a Tool for Assessment during an International Experience Teresa Douthit, Jennifer Bormann and Scott Schaake
3	2013-0011	3	Student Perceptions of Varied Assignments in an Online Greenhouse Production Class Kimberly Moore
4	2013-0065	3	Students' Perception of their Decision to Enroll in Agricultural Education Katrina Ann Swinehart
5	2013-0078	3	Evaluating Student Learning Using Traditional Testing or Daily Quizzes Laura M. White
6	2013-0079	3	Crossing Disciplinary Boundaries by Sharing Learning Objects Carol Speth and Donald Lee
7	2013-0105	3	Student Perceptions of a Plus/Minus Grading System Donna L. Graham, Donald M. Johnson, Leslie D. Edgar and Bruce L. Dixon
8	2013-0123	3	Undergraduate Research Experiences in Sustainable Agriculture: Students and Mentors Perceptions of Interns' Skills L. E. Marsh, F. M. Hashem, C. P. Cotton and A. L. Allen.
9	2013-0151	3	Investigating Student Learning and Leadership Development Outcomes in an Undergraduate Leadership Theory Course. Lisa Burgoon, David Rosch and Kari Keating
10	2013-0155	3	Predicting Instructor Quality in Undergraduate Courses Using the IDEA Survey Mark Anderson, Kyle Stutts, Marcy Beverly and Stanley Kelley

Thursday, June 27, 2013 • 9:30 – 10:30 a.m. (continued)

Poster	Submission ID	Category	Title and Author(s)
11	2013-0165	3	Teacher Perceptions of Quality of University-level Pre-service Agricultural Mechanics Instruction Matthew J. Shultz, Ryan G. Anderson and Thomas H. Paulsen
12	2013-0208	3	Comparison of Final Course Grades and Absenteeism in Short and Long Semester Undergraduate Animal Science Courses K. J. Stutts, M. M. Beverly and S. F. Kelley
13	2013-0246	3	Diversifying Student Enrollment in Colleges of Agriculture through the Recruitment of Latino Students Joy M. Marshall and Wendy J. Warner
14	2013-0266	3	Selecting Assessment Modalities for a Short-term Study Abroad Course on Indian Wildlife Shweta Trivedi
15	2013-0212	5, 3	Comparing Academic Achievement of Agriculture Majors With and Without Teaching Certification Dwayne Pavelock and Doug Ullrich
16	2013-0214	5, 3	Professional Development Needs Assessment of Texas' Agriculture, Food, and Natural Resources Teachers Casey Page, Haley Vrazel, Zachary Nowak, Doug Ullrich and Dwayne Pavelock
17	2013-0278	5, 3	Improving Student Success Through Professional Development Opportunities K. McCuiston, D. Kinkel, S. Lukefahr, M. Garcia, S. Henke, T. Machado and R. Stanko
18	2013-0045	6, 3	How Do Graduate Students Perceive their Graduate Advisor at Razi University Kiumars Zarafshani and Mahsa Sadvandi
19	2013-0094	6, 3	Impact of the EARTH Program on Student Development of Personal and Professional Skills Cynthia Haynes and Kevin Duerfeldt
20	2013-0189	6, 3	The USDA-HSI Program Fosters Professional Development and Research Skills in Undergraduates at the University of La Verne: A Student Perspective Roshan N. Gamage, Lila J. Luna and Stacey Darling-Novak

Poster	Submission ID	Category	Title and Author(s)
21	2013-0190	6, 3	Strengthening the Pipeline of Undergraduate Students into the Food Science and Technology Master's Program: A Successful Intervention in a Hispanic Serving Institution dna Negron, Mildred Chaparro and Luisa Guillemard
22	2013-0205	6,3	Application of Hispanic Culture to Food and Nutrition Curriculum Projects Promotes Self-Identity while Disseminating to Wider Audience Judith Beto, Katherine Montalbano, Nancy Rivera and Krista Silverman
23	2013-0282	6, 3	Diversity in Two Year Post Secondary Agricultural Programs Melissa Hendrickson and Elizabeth Wilson
24	2013-0114	5, 3	An Evaluation of Teaching Abroad at Hawassa University, Ethiopia Wendy J. Dahl and Amanda L Ford
25	2013-0150	2	Assessment of Student Attitudes for Hybrid (Traditional and Online) Taught Courses Marcy Beverly, Stanley Kelley and Joe Muller
26	2013-0152	2	Enhancing Cross-cultural Awareness and Critical Thinking through Reflection of Weekly Agribusiness Travel Seminars in a Semester-long Study Abroad Ashley N. Sutton, Dale Layfield, Curt Friedel and Thomas Dobbins
27	2013-0153	2	In the Spotlight: Experiential Learning through a Graduate Student Association Research Conference Julie Robinson and Caryn Filson
28	2013-0160	2	Using a Modified Nominal Group Technique as a Model for Formative Course Evaluation Matthew J. Shultz
29	2013-0166	2	Financial Impact of the VRTEX 360: Is Virtual Reality a Cost-effective Solution in the Agricultural Mechanics Laboratory? Alex P. Byrd, Ryan G. Anderson and Matthew J. Shultz
30	2013-0167	2	Using Mobile Media Pilot Projects to Enhance Student Learning Tammy Bennett
31	2013-0176	2	Student Satisfaction with Dairy Quiz Bowl Review Strategy Jeremy Falk, Douglas Masser and Amin Ahmadzadeh

Thursday, June 27, 2013 • 9:30 – 10:30 a.m. (continued)

Poster	Submission ID	Category	Title and Author(s)
32	2013-0187	2	It's for the Birds: Building "Classroom Community" one Tweet at a Time. David Jones
33	2013-0194	2	Student Response to Clicker Use in Medium-Size Horticulture Class Mara Grossman, Courtney Vengrin, J. Roger Harris and Donna Westfall-Rudd
34	2013-0213	2	New Mexico Highlands University, Geospatial Applications in Natural Science (GAINS) Lab Petronis, M.S., Lindline, J. and Zebrowski, P.J

Friday, June 28, 2013 • 9:30 – 10:30 a.m.**Scholarly Approach to Teaching**

Latham Ballroom D, E, F

Poster	Submission ID	Category	Title and Author(s)
1	2013-0016	4	Roadblocks to Undergraduate Success Caryn Filson and Susie Whittington
2	2013-0030	4	Relationships of Learning Styles and Educational Preferences Mary Lehman
3	2013-0067	4	Graduate Teaching Assistants' Teaching Efficacy Christopher T. Stripling, Jessica Poore, Carrie A. Stephens, Christopher M. Estep
4	2013-0070	4	Evaluation of Student Exam Performance in Relation to Strengths-based Leadership Domain Deborah L. VanOverbeke and Amy R. Gazaway
5	2013-0111	4	Making Climate Change a Functioning Thread in the Baccalaureate Curriculum: Transforming Fiber, Textiles, and Clothing Education Melody LeHew, Cosette Armstrong, Kim Hiller, Gwendolyn Hustvedt and Barbara Anderson
6	2013-0132	4	Enhancing Student Learning with Hands-On Laboratory Exercises and Research Projects in Animal Biotechnology Mahipal SINGH, Xiaoling Ma, Charles Okonkwo, Nagender Degala, Oberziner White, Pushpa Yadav, Eugene Amoah, Will Getz and Curtis Borne

Poster	Submission ID	Category	Title and Author(s)
7	2013-0135	4	Test Question Order Effects on Test Taking Time and Score Robert Dove and Kari Turner
8	2013-0204	4	Examining Reflection Among Preservice Agriculture Teachers Wendy J. Warner
9	2013-0238	4	The Impact of 4-H and FFA Member Involvement on College Recruitment Strategies at a Land Grant University E.J. Carter, D.W. Duncan, N.E. Fuhrman and K.J. Rucker
10	2013-0268	4	How to Recruit the Next Generation of Leaders in Food Safety: Understanding Perceptions of High School Students in Rural North Carolina Clinton Stevenson and Caitlin Alberts
11	2013-0269	5, 4	Modes of Faculty Engagement and Collaboration in a Senegal Higher Education Agriculture Capacity Building Project Ozzie Abaye, Patrick Guilbaud and Fatou Gueye
12	2013-0002	6, 4	Advancing Undergraduate Bioscience Engagement Track (A-UBET): High School Grads Interning in ARS Labs & Growing a Diverse Agricultural Workforce Marshall Logvin, Elysia Jennett and James Dalton
13	2013-0022	6, 4	Development and Implementation of a National Center of Excellence in Dairy Production Medicine Education for Veterinarians John Fetrow
14	2013-0066	6, 4	Bundling of Food, Culinary, Nutrition and Packaging Science Cross-Training to Meet Children's Needs Through Emerging Food and Ag Products M. Condrasky, D. Darby, J. Sharp, J. Cooper and A. Weeks
15	2013-0099	6, 4	Bioinformatics Education for Agricultural Science Ming-Ying Leung, Kyle L. Johnson and Felix Guerrero
16	2013-0101	6, 4	Agriculture Out of Bounds Brenda Anderson
17	2013-0055	5, 4	Management of Plant Parasitic and Beneficial Nematodes with Tropical Cover Crops Valerie H. Henmi and Sharadchandra P. Marahatta

Friday, June 28, 2013 • 9:30 – 10:30 a.m. (continued)

Poster	Submission ID	Category	Title and Author(s)
18	2013-0057	5,4	Can Strawberry Guava, Psidium Cattleianum, Leaves be Used for Weed Management in Hawai'i? Jni-Wah Lau and Sharadchandra P. Marahatta
19	2013--0110	5,4	Training and Development of Research-Savvy Undergraduate Student through the Multiplex Real-Time PCR Assay Jung-Lim Lee
20	2013-0285	5,4	Yield and Environmental Effects of Organic and Inorganic Fertilizer Applications on Mixed-Season Perennial Forages Laban K. Rutto, Ngowari Jaja, Eton Codling, Michael Brandt, Adnan Yousuf
21	2013-0073	5, 4	Multidimensional Scaling for Agricultural Students' Perception towards Cheating Behavior: A case from Iran Lida Sharafi- Amirhossein Alibaygi
22	2013-0108	5, 4	Participation of Agricultural Education Students in Dual Enrollment Programs in Tennessee B. Darroch, B. Piatt and J. Mehlhorn
23	2013-0116	5, 4	Creating Agricultural Communication Curriculum in Secondary Agricultural Education Classrooms: An Assessment of Students' Perceptions Carley Calico, Leslie D. Edgar and Don W. Edgar
24	2013-0259	5, 4	Seeking Out Perceptions of College Stakeholders to Help Write a Mission Statement Kelsey Hall, Rebecca Lawver and Camille Kalkman
25	2013-0265	5, 4	Extending Information to Small and Niche Market Flock Owners Through the Development of the Center for Small Flock Research and Innovation Brigid A. McCrea
26	2013-0222	2	Experiential Learning Activities to Enhance Plant Materials Courses C.T. Miller
27	2013-0223	2	Incorporating Digital Plant Walks Using Google Maps™ in Plant Materials Courses M.S. Wilson and C.T. Miller
28	2013-0233	2	Student Response to Equine Laboratory Activities Utilizing Constructivism A.E. Lowrey, J.A. West, K.K. Turner, D.W. Duncan, N.E. Fuhrman and C.R. Dove

Poster	Submission ID	Category	Title and Author(s)
29	2013-0247	2	Student Experiences with Cooperative Online Learning Matt Spindler
30	2013-0253	2	What Reflective Papers Reveal about Experiential Learning on University Athletic Fields Samuel Doak, Rick Rudd and Curtis R. Friedel
31	2013-0264	2	Student Use of Electronic Data and Communication Venues in College Courses John M. Galbraith and Jennifer Sparrow
32	2013-0267	2	Connecting the Dots: Food + Culture = Agriculture Ozzie Abaye, Gregory Welbaum and Kang Xia
33	2013-0276	2	The U.S. & China Collaborated REU Program to Promote Undergraduate Research Experiences Sha Li, Derrick Davis and Yujian Fu
34	2013-0200	2,5	Effective Communication Strategies Outside the Classroom: A Case Study Tobin Redwine, Christine Arnold, Landry Lockett and Tracy Rutherford
35	2013-0292	5	Growing Rural Iowa's Bioenergy Workforce Chuck Crabtree

Participant List

Ozzie Abaye

Virginia Tech
Professor
245 Smyth Hall
Blacksburg, VA 24061

Amr Abd-Elrahman

University of Florida
Assistant Professor
1200 N Park Rd
Plant City, FL 33563

Taylor Adams

Utah State University
Academic Advisor
2300 Old Main Hill
Logan, UT 84322

Amin Ahmadzadeh

University of Idaho
Professor
Mail Stop 2330
875 Perimeter Drive
Moscow, ID 83844-4244

Douglas Airhart

School of Agriculture
Professor of Horticulture
P.O. Box 5034
Cookeville, TN 38505

Caitlin Alberts

5149 Nicholas Creek Circle
Wilmington, NC 28409

Arthur Allen

University of Maryland Eastern
Shore
Professor
30921 Martin Court
Princess Anne, MD 21853

Crystal Allen

1658 E 1150 North Road
Homer, IL 61849

Antoine Alston

140 Pine Needles Road
Reidsville, NC 27320

Samantha Ambrose

Oklahoma State University
Graduate Student
368 Agricultural Hall
Stillwater, OK 74078

Angela Anderson

1326 Mockingbird Drive
Blacksburg, VA 24060

Mark Anderson

Sam Houston State University
Dr. Sam Houston State
University
Dept. of Agricultural and
Industrial Science
Box 2088
Huntsville, TX 77341-2088

Michael Andreu

University of Florida
Associate Professor
P.O. Box 110410
Gainesville, FL 32611

Gary Appgar

Southern Illinois University
Associate Professor
Agriculture Sciences MC 4417
Agriculture 123
Carbondale, IL 62901

Shannon Arnold

Montana State University
Assistant Professor
Division of Ag Education
230 Linfield Hall
Bozeman, MT 59717

Donald Auger

South Dakota State University
Associate Professor
Dept. Biology-Microbiology
SNP 251A
Brookings, SD 57007

Jim Baier

School of Agriculture
Assistant Professor of Ag
Engineering
P.O. Box 5034
Cookeville, TN 38505

Wayne Banwart

3201 Sandhill Lane
Chamapign, IL 61822

Richard Barczewski

Delaware State University
Chair Dept of Ag & Nat Res
1200 North DuPont Highway
Dover, DE 19901-2275

Jacob Barney

Virginia Tech
Assistant Professor
435 Old Glade Road 0330
Blacksburg, VA 24061

Kirby Barrick

University of Florida
Professor
220 Rolfs Hall
P.O. Box 110540
Gainesville, FL 32611-0540

Kelli Batch

West Virginia State University
R&D Corp.
Program Leader
603 Curtis Complex
P.O. Box 1000
Institute, WV 25112

Richard Beard

Utah State University
Professor
ASTE Dept.
2300 Old Main Hill
Logan, UT 84322-2300

Anton Bekkerman

Montana State University
205 Linfield Hall
P.O. Box 172920
Bozeman, MT 59717-2920

Kimberly Bellah

Hutson School of Agriculture
Associate Professor
103 S 16th Applied Science
Murray, KY 42071

Tammy Bennett

Penn State University
Academic Advisor
119 Ag Admin
University Park, PA 16802

Erin Berg

USDA National Institute of
Food and Agriculture
Education Program Specialist
800 9TH ST SW
Washington, DC 20024

Jean Bertrand

University of Georgia
CAES Assistant Dean of
Academic Affairs
102 Conner Hall
Athens, GA 30602

Marcy Beverly

Sam Houston State University
Associate Professor
Box 2088
Huntsville, TX 77341-2088

Mahadev Bhat

Florida International University
Professor
Earth and Environment Dept
MM Campus, ECS 346
Miami, FL 33199

Brent Bjelland

Iowa State University
Graduate Assistant
201 Curtiss Hall
Ames, IA 50011

Caroline Black

Texas A&M University
Graduate Assistant
2116 TAMU
College Station, TX 77843

Jenny Bormann

Kansas State University
Associate Professor
131 Weber Hall
Manhattan, KS 66506

Stephen Boyles

Ohio State University
2027 Coffey Rd
Plumb Hall
Columbus, OH 43210

Marianne Bracke

918 Highland Ave
Lafayette, IN 47905

Janice Branson

School of Agriculture
Assoc. Professor of Agronomy
P.O. Box 5034
Cookeville, TN 38505

Jessica Braswell

Queens University of
Charlotte
Associate Professor of
Environmental Sci
1900 Selwyn Ave
Charlotte, NC 28274

Dennis Brink

University of Nebraska-
Lincoln
Professor
P.O. Box 830908
C220 Animal Science Bldg
Lincoln, NE 68583

Ed Brokaw

Abilene Christian University
Professor
ACU Box 27986
Administration BLDG, Rm 131
Abilene, TX 79699-7986

Anne Brown

Purdue University
Department of Agronomy
915 W. State St
West Lafayette, IN 47907

Bradley Burbaugh

Virginia Tech
Graduate Student
2270 Litton-Reaves Hall (0343)
Blacksburg, VA 24061

Lisa Burgoon

University of Illinois
Coordinator- Leadership
Studies
1401 W. Green
Suite 290
Illini Union
Urbana, IL 61801

Tim Buttles

UW -River Falls
Professor
410 South Third Street
River Falls, WI 54022

Elizabeth Carter

University of Georgia
Graduate Assistant
400 River Road
Athens, GA 30602

Chris Catanzaro

VSU
Agriculture, Box 9416
Petersburg, VA 23806

Steven Chiang

Agribusiness Incubator
Program
Director
3050 Maile Way
Gilmore 115
Honolulu, HI 96822

Nik Clegorne

Virginia Tech
Assistant Professor
2270 Litton-Reaves Hall (0343)
Blacksburg, VA 24061

Adam Cletzer

Virginia Tech
Graduate Student
2270 Litton-Reaves Hall (0343)
Blacksburg, VA 24061

Margaret Condrasky

1004 Calumet Ct
Piedmont, SC 29673

Rita Conley

Univ of AR - Pine Bluff
Instructor
1200 N. University Drive MS
4913
Pine Bluff, AR 71601

Nathan Conner

8401 NW 13th Street Lot 83
Gainesville, FL 32653

Chuck Crabtree

52558 235th trl
Chariton, IA 50049

Cody Cramer

1015 W 5th Ave
Stillwater, OK 74074

Johanna Cricenti

309 Graves Ave
Blacksburg, VA 24060

Barry Croom

NC State University
Professor
Box 7607
Raleigh, NC 27695-7607

Jesus Cuellar Fuentes

523 Rockhill Dr.
San Antonio, TX 78209

Avery Culbertson

5008 NW 44th Lane, Apt. 106
Gainesville, FL 32606

Wendy Dahl

University of Florida
Assistant Professor
359 FSHN Building Newell
Drive
Gainesville, FL 32611

Dixie Dalton

10114 South Hill Road
Kenbridge, VA 23944

James Dalton

1036 South Daley
Mesa, AZ 85204

Stacey Darling-Novak

University of La Verne
Professor of Biology
1950 3rd Street
La Verne, CA 91750

Barb Darroch

University of Tennessee at
Martin
Instructor
256 Brehm Hall
Martin, TN 38238

Participant List

Winston de la Torre

P.O. Box 3264
Mayaguez, PR 00681

Sarah DeLoach

University of Georgia
Graduate Assistant
400 River Road
Athens, GA 30602

Airell DesLauriers

22 54006 Range Road 261
Sturgeon County, AB T8T 0C1

Robert Dixon

Box 3231
Vermilion, AB T9X 2B2

Sam Doak

Virginia Tech
AT Program
1330 Litton-Reaves Hall (0334)
Blacksburg, VA 24061

Thomas Dobbins

102 Brooks Drive
Townville, SC 29689

Elizabeth Domby

Texas Tech University
Box 42141
Lubbock, TX 79407

Kevin Donnelly

325 N 17th ST
Manhattan, KS 66502

Tracy Dougher

Montana State University
Professor
P.O. Box 173140
314 Leon Johnson Hall
Bozeman, MT 59717-3140

G. Neil Douglas

Berea College
CPO 1862
Berea, KY 40404

Teresa Douthit

Kansas State University
Assistant Professor
129 Weber Hall
Manhattan, KS 66506

Robert Dove

University of Georgia
425 River Road
Department of Animal and
Dairy Science, room 248
Athens, GA 30602

Krystal Drysdale

114 S. Manhattan Ave
Manhattan, KS 66502

Kevin Duerfeldt

Department of Horticulture
106 Horticulture Hall
Iowa State University
Ames, IA 50011

Dennis Duncan

University of Georgia
Professor
141 Four Towers
Athens, GA 30602

Don Edgar

University of Arkansas
Assistant Professor
1140 W. Maple
AGRI 205
Fayetteville, AR 72701

Leslie Edgar

University of Arkansas
Associate Professor
1140 W. Maple
AGRI 205
Fayetteville, AR 72701

Billie Jean Elmer

Virginia Cooperative
Extension
Sr Extension Agent 4-H Youth
Development
P.O. Box 205
Surry, VA 23883

Ann Emmsley

University of Hawaii Maui
College
310 W. Kaahumanu Ave
Kahului, HI 96732

Chastity English

North Carolina A&T State
University
1601 E. Market Street
242-A Carver Hall
Greensboro, NC 27411

Christopher Estep

Sul Ross State University
Assistant Professor
Box C-11
Alpine, TX 79832

John Ewing

Penn State University
Assistant Professor
215 Ferguson Building
University Park, PA 16802

Jeremy Falk

University of Idaho
875 Perimeter Drive
Mailstop 2040
Agricultural Education
Moscow, ID 83844

William Farmer

9900 Kennebec Church Rd.
Angier, NC 27501

Paula Faulkner

North Carolina A&T State
University
Assistant Professor
1601 E. Market Street
A-21 CH Moore Ag Research
Facility
Greensboro, NC 27411

Dennis Fennewald

School of Agriculture
Asst. Professor of Animal
Science
P.O. Box 5034
Cookeville, TN 38505

Caryn Filson

Ohio State University
Student
2120 Fyffe Road
Columbus, OH 43210

Jim Flowers

NC State University
Professor
Box 7607
Raleigh, NC 27695-7607

Caitlin Foley

831 Jacks Mill Drive
Boalsburg, PA 16827

Amanda Ford

University of Florida
Graduate Student
359 FSHN Building Newell Dr.
Gainesville, FL 32611

Billie Foster

School of Agriculture
715 Quadrangle, South Hall,
Room 145
P.O. Box 5034
Cookeville, TN 38505

Unice Foster

Michigan State University
Professor
Plant, Soil, and Microbial
Sciences PSSB
1066 Bogue Street
East Lansing, MI 48824

Edward Franklin

1127 W. Placita Camillia
Tucson, AZ 85714

Curt Friedel

Virginia Tech
Assistant Professor
2270 Litton-Reaves Hall (0343)
Blacksburg, VA 24061

Nick Fuhrman

University of Georgia
Associate Professor
139 Four Towers
Athens, GA 30602

Gabrielle Fundaro

1654 Providence Blvd.
Christiansburg, VA 24073

John Galbraith

1206 Glade Road
Blacksburg, VA 24060

Roshan Gamage

1434 Cambridge Avenue
Upland, CA 91786

Adrian Garcia

Hartnell College
Ag Student
411 Central Avenue
Salinas, CA 93901

Chad Gasser

Southern Utah University
Associate Professor
351 W University Blvd
Cedar City, UT 84720

Chelsea Geiger

Box 35
Tawatinaw, AB T0G 2E0

Courtney Gibson

Texas Tech University
Research Assistant
Box 42131
Lubbock, TX 79409-2131

Barbara Gilbert

471 Almshouse Road
Doylestown, PA 18901

Rodney Gilbert

471 Almshouse Road
Doylestown, PA 18901

Martie Gillen

University of Florida
Assistant Professor
P.O. Box 110310
Gainesville, FL 32611

Jean Gleichsner

Fort Hays State University
600 Park St
Agriculture Department
Hays, KS 67601

Carlos Gomez

una la molina
av universidad sn
La Molina lima
AP456

Angel Gonzalez

University of Puerto Rico
Professor of Entomology
P.O. Box 9000
Mayaguez, PR 00681

Gladys Gonzalez

University of Puerto Rico
Professor of Agricultural
Economics
P.O. Box 9000
Mayaguez, PR 00681

Deborah Good

Virginia Tech
Associate Professor
1981 Kraft Drive 0913
Human Nutrition Foods and
Exercise
Blacksburg, VA 24061

Ashley Granata

133 Costa Lotta Dr
Pickens, SC 29671

Alan Grant

Virginia Tech
Dean, CALS
104 Hutcheson Hall (0402)
Blacksburg, VA 24061

Julie Grossman

8 Blue Bottle Ln
Durham, NC 27705

Mara Grossman

2814 Tall Oaks Drive
Blacksburg, VA 24060

Orlen Grunewald

2324 Bailey Drive
Manhattan, KS 66502-2733

Joe Guthrie

6626 Aaron Lane
Dublin, VA 24084

Kimberly Gwinn

University of Tennessee
Associate Professor
370 Plant Biotech Building
2505 EJ Chapman Drive
Knoxville, TN 37996-4560

Kelsey Hall

Utah State University
Assistant Professor
2300 Old Main Hill
Logan, UT 84322

Danielle Hammond

KSU HFRR
2021 Throckmorton Plnt Sci
Cntr
Manhattan, KS 66506

Sarah Hanks

Virginia Tech
Graduate Student
2270 Litton-Reaves Hall (0343)
Blacksburg, VA 24061

Gail Hansen

2603 NW 104th Court
Gainesville, FL 32606

Ron Hanson

8130 Dorset Drive
Lincoln, NE 68510

Pauline Harvey

UAF/Chukchi Campus
Director
P.O. Box 297
Kotzebue, AK 99752

Fawzy Hashem

University of Maryland
Eastern Shore
Associate Professor
30921 Martin Court
Princess Anne, MD 21853

Jeffrey Hattey

The Ohio State University
100 Agric. Admin.
2120 Fyffe Rd
Columbus, OH 43210

Cynthia Haynes

Iowa State University
Associate Professor
Department of Horticulture
131 Horticulture Hall
Ames, IA 50011

Ron Heimler

Cal Poly Pomona
Lecturer
Apparel Merchandising and
Management Dept.
3801 W Temple Ave
Pomona CA, CA 91768

Jennifer Helms

315 Reynolds Street Apt A
Blacksburg, VA 24060

Participant List

Melissa Hendrickson

184 Berry Patch Road
Hampstead, NC 28443

Valerie Henmi

Kauai Community College
3-1909 Kaunualii Highway
Lihue, HI 96766

Lisa Hightower

Virginia Tech
Research Specialist
400 Turner Suite 102
Blacksburg, VA 24060

Bill Hoch

Montana State University
Associate Professor
409 Leon Johnson Hall
Bozeman, MT 59717

Tracy Hoover

101 AG Admin
University Park, PA 16802

Brittany Howell

304 Oak St.
La Crosse, KS 67548

Trent Hughes

1307 East Dryden
Stillwater, OK 74074

William P. Hunter

Pratt Community College
Agriculture Instructor
348 NE State Road 61
Pratt, KS 67124

Katharyn Ingerson

4910 Dana Dr.
Apt. 9M
Raleigh, NC 27606

Erica Irlbeck

Texas Tech University
Assistant Professor
Ag Ed & Com
Box 42131
Lubbock, TX 79409

Anna Isserow

Virginia Tech
Student
880 Patrick Henry Drive
Blacksburg, VA 24060

Lee Ivy

NC State University
Lecturer
Campus Box 7609
Kilgore Hall 124
Raleigh, NC 27695

Juan Jauregui

HC 69 Box 7
Sapello, NM 87745

Krish Jayachandran

Florida International
University
Professor
11200 SW 8 Street
University Park, FL 33199

KSU Jayaratne

NC State University
Associate Professor
Box 7607
Raleigh, NC 27695-7607

David Jones

North Carolina State
University
Associate Professor
Campus Box 7607
Raleigh, NC 27695

Chad Jordan

North Carolina State
University
Undergraduate Coordinator
Department of Plant Biology
2115 Gardner Hall
Box 7612
Raleigh, NC 27695-7612

Prasanta Kalita

University of Illinois
1301 W Gregory Drive
Urbana, IL 61801

Eric Kaufman

Virginia Tech
Assistant Professor
2270 Litton-Reaves Hall (0343)
Blacksburg, VA 24061

Stanley Kelley

Sam Houston State University
Professor and Chair
Box 2088
Huntsville, TX 77341-2088

Josh Kellogg

North Carolina State
University
600 Laureate Way
Kannapolis, NC 28081

Rachael Kennedy

Virginia Tech
Graduate Student
2270 Litton-Reaves Hall (0343)
Blacksburg, VA 24061

William Kern

University of Florida
Associate Professor
3205 College Ave.
Ft. Lauderdale R. E. C.
Davie, FL 33314

Peter Kilduff

Cal Poly Pomona
Professor
3801 W Temple Ave
Pomona, CA 90768

Robert King

Monroe Community College
Sr Agriculture Specialist
1000 E Henrietta Road
Rochester, NY 14623

Thomas Kingery

Western Kentucky University
1906 College Heights Blvd.
41066
Bowling Green, KY 42101-1066

David Knauff

University of Georgia
1111 Miller Plant Sciences
Bldg.
Athens, GA 30602

Anil Kumar Chaudhary

The Pennsylvania State
University
Graduate Assistant
009, Ferguson Building
University Park, PA 16802

Misty Lambert

Oregon State University
Assistant Professor
112 Strand Ag Hall
Corvallis, OR 97331

Robert Lane

Sam Houston State University
Professor
Dept of Agricultural and
Industrial Sci
Huntsville, TX 77341-2088

Teri Lau

Kauai Community College
3-1901 Kaunualii Highway
Lihue, HI 96766

Dale Layfield

Clemson University
Associate Professor
132 Long Hall
Clemson, SC 29634

Christi Leard

Clemson University
Student Service Program
Coordinator
244 McAdams Hall
Clemson, SC 29634

John Lee

University of Georgia
Undergraduate Honors
Student
139 Four Towers Bldg
Athens, GA 30602

Jung-lim Lee

Delaware State University
Assistant Professor
1200 N. Dupont Hwy.
Department of Human
Ecology.
Dover, DE 19901

Melody LeHew

Kansas State University
Associate Professor
324 Justin Hall
Apparel, Textiles, & Interior
Design
Manhattan, KS 66506

Mary Lehman

Longwood University
Professor of Biology
201 High St
Farmville, VA 23909

Ming-Ying Leung

The University of Texas at El
Paso
Professor
500 W University Avenue
El Paso, TX 79968

Molly Lewis

Hartnell College
Dir. Community
Collaboratives
411 Central Ave
Salinas, CA 93901

Ronald Lewis

Virginia Tech
Professor
Department of Animal &
Poultry Sciences
3100 Litton-Reaves Hall (0306)
Blacksburg, VA 24061

Sha Li

2518 Hamilton Dr. SE
Huntsville, AL 35803

Mary Ann Lila

Plants for Human Health
Institute, NCSU
Director
North Carolina Research
Campus
600 Laureate Way
Kannapolis, NC 28081

Josue Lopez

National Institute of Food and
Agriculture
Program Specialist
800 9th Street, SW
Washington, DC 20024

Horacio Lopez-Nicora

Ohio State University
Student
248 Kottman Hall
2021 Coffey Road
Columbus, OH 43210

Aubrey Lowrey

9921 Montauk Ave
Bethesda, MD 20817

Lila Luna

850 Hillside Street
La Habra, CA 90631

Tanner Machado

Texas A&M University-
Kingsville
Assistant Professor
1150 Engineering Ave.
MSC 228 Kleberg Ag 133
Kingsville, TX 78363

Greg Madden

Southeast Arkansas College
Department Co-Chair General
Studies
1900 S. Hazel St.
Pine Bluff, AR 71603

Dewey Mann

The Ohio State University
590 Woody Hayes Dr
Columbus, OH 43210

Sharadchandra Marahatta

Kauai Community College
University of Hawaii
3-1909 Kaunualii Highway
Lihue, HI 96766

Lurline Marsh

University of Maryland
Eastern Shore
Professor
30921 Martin Court
Princess Anne, MD 21853

Joy Marshall

NC State University
Graduate Student
Box 7607
Raleigh, NC 27695-7607

Tom Martin

712 Third Street
Radford, VA 24141
Adam Marx
3206 Blue Grouse Drive
Columbia, MO 65202

Douglas Masser

University of Idaho
Graduate Associate
875 Perimeter Drive MS 2040
Moscow, ID 83844-2040

Godwin Mbagwu

Virginia State University
P.O. Box 9078
Virginia State University, VA
23806

Jim McConnell

Box 5275 UOG Station
Mangilao, GU 96923

Brigid McCrea

Delaware State University
Poultry Specialist
Cooperative Extension
1200 N. Dupont Hwy.
Dover, DE 19901

Kim McCuiston

Texas A&M University-
Kingsville
Associate Professor
700 University Blvd, MSC 137
Kingsville, TX 78363

Pauline McFall

American Samoa Community
College
CNR Instructional Coordinator
P.O. Box 5319
Pago Pago, AS 96799

James McKenna

Virginia Tech
Instructor
1060 Litton-Reaves Hall (0334)
Blacksburg, VA 24061

Aaron McKim

Oregon State University
GTA
112 Strand Ag Hall
Corvallis, OR 97331

Participant List

Suzie McMullen

Ohio State University
Student
2120 Fyffe Road
Columbus, OH 43210

Casey Meadows

Texas A&M University
Student
2116 TAMU
College Station, TX 77843-2116

John Michael Mehaffey

16745 Highway 59 North
Nacogdoches, TX 75946

Joey Mehlhorn

UT Martin
Professor
Brehm Hall 254
Martin, TN 38238

Sandy Mehlhorn

University of Tennessee at
Martin
Assistant Professor
256 Brehm Hall
Martin, TN 38238

Priscilla Millen

94-585 Lumiauau St.
Waipahu, HI 96797

Chad Miller

Kansas State University
Assistant Professor
2607 Throckmorton Plant
Sciences
Manhattan, KS 66506

David Miller

4508 Doverbrook
Champaign, IL 61822

Melanie Miller Foster

144 Aikens Place
State College, PA 16801

Foy Mills Jr

Sam Houston State University
Professor and Program Leader
P.O. Box 2088
Huntsville, TX 77341-2088

Dana Minihan

K-State University Agronomy
Dept
Instructor
1022 Throckmorton Hall
Manhattan, KS 66506

Sarah Misyak

1230 Tranquility Via
Christiansburg, VA 24073

Michael Mohney

The Pennsylvania State
University
Instructor of Landscape
Contracting
302 Tyson Building
University Park, PA 16802

Donna Moore

Virginia Tech
Assistant Professor
AEE
284 Litton-Reaves Hall (0343)
Blacksburg, VA 24061

Gary Moore

316 Coorsdale Drive
Cary, NC 27511

Jeannette Moore

North Carolina State
University
Professor
NCSU Box 7621
Raleigh, NC 27695-7621

Kimberly Moore

University of Florida
Professor
3205 College Ave
Davie, FL 33314

Mackenzie Moore

Virginia Tech
Student
4074 Pearman Road
Blacksburg, VA 24060

Chris Morgan

University of Georgia
Assistant Professor
130 Four Towers
Athens, GA 30602

Douglas Morrish

Ag Dept Texas State
University
Assoc Professor
601 University Drive
San Marcos, TX 78666

Michael Mullen

North Carolina State
University
Vice Chancellor
Academic and Student Affairs
1F Holladay Hall, Box 7301
Raleigh, NC 27695-7301

Brian Myers

University of Florida
Associate Professor and
Associate Chair
305 Rolfs Hall
P.O. Box 110540
Gainesville, FL 32611

Pavli Mykerezzi

903 Turner Street NE
Blacksburg, VA 24060

Maria Navarro

University of Georgia
Associate Professor
133 Four Towers
Athens, GA 30602

Edna Negron

University of Puerto Rico
Food Science and Technology
Coordinator
259 N Alfonso Valdez Blvd
Ave. LAs Marias
Alfredo Ramirez de Arellano
Rosell Bld
Mayaguez, PR 00680

Michael Nicodemus

Abilene Christian University
ACU Box 27986
Abilene, TX 79699

Kim Niewolny

Virginia Tech
Assistant Professor
2270 Litton-Reaves Hall (0343)
Blacksburg, VA 24061

Rose Ogotu

1700 North Dupont Highway
Apt. H 202
Dover, DE 19901

Linda Okiror

University of Arkansas at Pine
Bluff
Associate Dean
1200 North University
Mail Slot 4990
Pine Bluff, AR 71601

Michael Olexa

University of Florida
Professor
P.O. Box 110240
Gainesville, FL 32611

Lisa Orgler

Iowa State University
Lecturer
Department of Horticulture
129 Horticulture Hall
Ames, IA 50124

Emilio Ortiz

Cal Poly Pomona
MS Student Still Lab
3801 W Temple Avenue
Bldg 2
Pomona, CA 91768

Miriah Pace

National Agricultural Institute
NAI Assistant
151 West 100 South
Rupert, ID 83350

Joe Parcell

University of Missouri-
Columbia
Professor
142 Mumford Hall
Columbia, MO 65211

Marilyn Parker

NACTA
NACTA Editor
151 West 100 South
Rupert, ID 83350

Rick Parker

NACTA
NACTA Editor
151 West 100 South
Rupert, ID 83350

John Patterson

Purdue University
Associate Professor
Dept. of Animal Sciences
125 S. Russell St., Rm 115
West Lafayette, IN 47907-
2042

Dwayne Pavelock

Sam Houston State University
Associate Professor
Box 2088
Huntsville, TX 77341

Michael Petronis

New Mexico Highlands
University
Associate Professor
Ivan Hilton Science Center
Las Vegas, NM 87508

Nataliya Plesha

1479B Stafford Rd, Apt.B
Storrs-Mansfield, CT 06268

Marcus Pollard

University of Georgia
Graduate Assistant
Four Towers Bldg
Athens, GA 30602

Tonya Price

Virginia Tech
Asst. Professor and Extension
Specialist
2322 Blue Stone Hills Drive,
Suite 140
Harrisonburg, VA 22801

Wayne Pryor

Virginia Farm Bureau
President
12580 West Creek Parkway
Richmond, VA 23238

Tracy Quinton

Lakeland College
Instructor
5707 College Drive
Vermilion, AB T9X 1K5

Laura Ramos

California State University at
Fresno
Program Coordinator
5370 N. Chestnut
Fresno, CA 39740

Stephen Ratasky

8 St. Mary's Street
Apartment 1
Raleigh, NC 27695

Richard Rateau

825 West Water Street
Bellefonte, PA 16823

Tobin Redwine

Texas A&M University
Academic Adviser
600 John Kimbrough Blvd
TAMU 2116
College Station, TX 77843-
2116

Pamela Reed

Delaware Valley College
Associate Professor of Animal
Science
700 E. Butler Ave.
Doylestown, PA 18901

Ashley Rhodes

5435 Macy Place
Wamego, KS 66547

Bruce Richards

Delaware Valley College
Assistant Professor
700 E. Butler Ave
Doylestown, PA 18901

John Ricketts

Tennessee State University
3500 John A. Merritt Blvd.
Nashville, TN 37209

Aimee Rickman

204 W. California
Urbana, IL 61801

David Ringuette

48-440 Waihole Valley
Kaneohe, HI 96744

Lydia I. Rivera

UPR-Mayaguez Campus
Professor
Laurel Ave. Annexus to Pinero
Bldg.
Plant Pathology Lab. AP-102
Office B
Mayaguez, PR 00681

Julie Robinson

7110 Elmbrook Ct.
Reynoldsburg, OH 43068

Tim Rozell

2500 Marion Ave.
Manhattan, KS 66502

Rick Rudd

Virginia Tech
2270 Litton-Reaves Hall (0343)
Blacksburg, VA 24061

Mark Russell

Purdue University
Professor of Animal Sciences
125 S. Russell Street
POUL Bldg, Room 111
West Lafayette, IN 47907

Laban Rutto

Virginia State University
Assistant Professor
246 M.T. Carter Ag. Research
Center
P.O. Box 9061
Petersburg, VA 23806

Marcia Sakai

University of Hawaii at Hilo
Vice Chancellor
200 W. Kawili Street
Hilo, HI 96720

William S. Sakai

University of Hawaii at Hilo
Professor of Horticulture
200 W. Kawili St.
Hilo, HI 96720

Participant List

Laura Sankey

3830 Goshen Road
Clearfield, PA 16830

Paul Sarnoski

University of Florida
Food Science and Human
Nutrition
P.O. Box 110370
Gainesville, FL 32611

Havva Savran Al-Haik

Virginia Tech
Graduate Student
2270 Litton-Reaves Hall (0343)
Blacksburg, VA 24061

Scott Schaake

Kansas State University
Associate Professor
127 Weber Hall
Manhattan, KS 66506

Hannah Scherer

Virginia Tech
Research Assistant Professor
2270 Litton-Reaves Hall (0343)
Blacksburg, VA 24061

Alicia Schneider

203 Village Park Way
Savoy, IL 61874

Katherine Schury

5329 S. Newland
Chicago, IL 60638

Greta Schuster

Texas A&M University -
Kingsville
Professor
Kleberg Ag. Bldg., Rm 113
Kingsville, TX 78363

Jenny Schwanke

YMCA
Hale-Y Community Garden
Coord
1000 N. Main Street
Blacksburg, VA 24060

Megan Seibel

Virginia Tech
VALOR Director
264 Litton-Reaves Hall (0343)
Mail Code 0343
Blacksburg, VA 24060

Caroline Sheffield

NC State University
Graduate Student
Box 7607
Raleigh, NC 27695-7607

Kateel Shetty

Florida International
University
Assistant Res. Professor
11200 SW 8th Street
ECS-347, Earth & Environ.
Dept.
Miami, FL 33199

Candice Shoemaker

Kansas State University
Professor
KSU HFRR
2021 Throckmorton Plnt Sci
Cntr
Manhattan, KS 66506

Alyx Shultz

Hutson School of Agriculture
Assistant Professor
103 S 16th
Murray, KY 42071

Matthew Shultz

679 Adair Road
Mayfield, KY 42066

Krista Silverman

3279 Cool Springs Court
Naperville, IL 60564

Jon Simonsen

University of Missouri
Assistant Professor
125 a Gentry Hall
Columbia, MO 65211

Mahipal Singh

Fort Valley State University
Associate Professor of Animal
Science
1005 state University Drive
Fort Valley, GA 31030

Ray Smith

Abraham Baldwin Agricultural
College
Associate Professor
ABAC 6, 2802 Moore Hwy
Tifton, GA 31794

Tyson Sorensen

Oregon State University
GTA - Instructor
112 Strand Ag Hall
Corvallis, OR 97331

Annie Specht

3727 Bair Rd NW
Dover, OH 44622

Carol Speth

University of Nebraska-
Lincoln
Education Assessment
Specialist
1875 N. 38th Street
Lincoln, NE 68583-0915

Matt Spindler

Virginia Tech
Assistant Professor
204 Litton-Reaves Hall
Blacksburg, VA 24061

Rebecca Splan

Virginia Tech
Associate Professor
5527 Sullivans Mill Road
Middleburg, VA 20117

William Staniar

Penn State
Assistant Professor
324 W. L. Henning Building
University Park, PA 16802

Randy Stanko

Texas A&M University
Kingsville
Dept of Animal Science
700 University Boulevard
Kieberg AG Room 111 MSC
228
Kingsville, TX 78363

C. Robert Stark Jr

University of Arkansas
Monticello
Agricultural Economist
P.O. Box 3468
Monticello, AR 71656

Dan Stein

10909 North Western Road
Stillwater, OK 74075

Nicole Steinmetz

Ohio State University
Student
2120 Fyffe Road
Columbus, OH 43210

Robert Stephenson

3313 Willow Street
Hays, KS 67601

Clint Stevenson

North Carolina State
University
Assistant Professor
116 Schaub Hall
Campus Box 7624
Raleigh, NC 27695

David Still

Cal Poly Pomona
Professor
3801 W Temple Avenue
Bldg 2
Pomona, CA 91768

Jan Straley

University of Alaska Southeast
Associate Professor of Biology
1332 Seward Ave
Sitka, AK 99835

Christopher Stripling

University of Tennessee
Assistant Professor
2621 Morgan Circle
320B Morgan Hall
Knoxville, TN 37996

Peter Stuhmiller

Hartnell College
Ag Student
411 Central Avenue
Salinas, CA 93901

Kyle Stutts

Sam Houston State University
Assistant Professor
Box 2088
Huntsville, TX 77341-2088

Susan Sumner

Virginia Tech
Associate Dean and Director
1060 Litton-Reaves Hall (0334)
Blacksburg, VA 24061

Cory Suski

University of Illinois
Assistant Professor
1102 S. Goodwin Avenue
W401C Turner Hall
Urbana, IL 61801

Ashley Sutton

106 Canterbury Rd.
Pendleton, SC 29670

Katrina Swinehart

Ohio State University
Student
2120 Fyffe Road
Columbus, OH 43210

Ronald Takahashi

Kapiolani Community College
Department Chair - Culinary
Arts
4303 Diamond Head Road
Ohelo 101A
Honolulu, HI 96816

Royce Thornton

Ohio State ATI
1328 Dover Road
Wooster, OH 44691

Stacy Tomas

School of Agriculture
Assistant Professor of
Agritourism
P.O. Box 5034
Cookeville, TN 38505

Rial Tombes

Virginia Tech
Sustainability Coordinator
Dining Services Southgate
Blacksburg, VA 24061

Shweta Trivedi

Assistant Professor
123 Polk Hall
Department of Animal
Science
NC State University
Raleigh, NC 27695

Jessica Tussing

Virginia Tech
Equine Programming
Associate
388 Litton-Reaves Hall (0306)
Blacksburg, VA 24061

April Ulery

New Mexico State University
Professor
P.O. Box 30003, MSC 3Q
Las Cruces, NM 88003

Ann Marie VanDerZanden

Iowa State University
Professor
106 Horticulture Hall
Ames, IA 50011

Martha Vargas

University Transfer Center
1530 W. 17th Street S-110
Santa Ana, CA 92706

William Vencill

University of Georgia
Professor
3111 Miller Plant Sciences
120 Carlton Street
Athens, GA 30602

Courtney Vengrin

6208 Schooler Hill Drive
Apt 48
Radford, VA 24141

Randall Violet

Southern Utah University
Assistant Professor
351 West Univ Blvd
Cedar City, UT 84720

Melissa Voigt

Purdue University
Graduate Research Assistant
615 West State Street
West Lafayette, IN 47907-
2053

Tegan Walker

130 Circle Drive
Fairmont, WV 26554

Bonnie Walters

783 Hwy 128
Wilson, WI 54027

Xinlei Wang

University of Illinois at
Urbana-Champaign
Associate Professor
1304 W Pennsylvania Ave
332C AESB
Urbana, IL 61801

Wendy Warner

105 Rosenberry Hills Drive
Cary, NC 27513

Stuart Watts

1700 N Manhattan Ave
Apt 301
Manhattan, KS 66502

Melissa Welsh

Purdue University
Graduate Student
615 West State Street
West Lafayette, IN 47907-
2053

Brian Whitaker

University of Findlay
Professor
1000 North Main Street
Findlay, OH 45840

Ingelia White

Windward Community
College
Professor
45 - 720 Keaahala Road
Kaneohe, HI 96744

Laura White

New Mexico State University
Assistant Professor
MSC 3-I
Las Cruces, NM 88003

Participant List

Susie Whittington

Ohio State University
Professor
2120 Fyffe Road
Columbus, OH 43210

Jerry Williams

Virginia Tech
Professor
Horticulture 0327
Blacksburg, VA 24061

Kevin Williams

West Texas A&M
Assistant Professor of Ag.
Education
WTAMU Box 60998
Canyon, TX 79016

David Willoughby

Ohio State University ATI
Associate Professor
1328 Dover Road
Wooster, OH 44691

Elizabeth Wilson

NCSU
Professor
Box 7607
Raleigh, NC 27695

Jessica Winkler

210 N. 4th St. Apt. 305
Manhattan, KS 66502

Dean Winward

Southern Utah University
Associate Professor
351 W University Blvd
Cedar City, UT 84720

Ferdinand Wirth

Saint Joseph's University
Assoc Professor of Food
Marketing
5600 City Avenue
Philadelphia, PA 19131-1395

Lawrence Wolfskill

Sam Houston State University
Assistant Professor
1831 University Ave Thom 222
Box 2088
Huntsville, TX 77341-2088

Cindy Wood

Virginia Tech
Associate Professor
Animal and Poultry Sciences
Blacksburg, VA 24061

Lee Wood

Southern Utah University
Associate Professor
351 W University Blvd
Cedar City, UT 84720

Amy Wright

Auburn University
Associate Professor
Department of Horticulture
Auburn University
Auburn, AL 36849

Brielle Wright

Virginia Tech
Graduate Student
2270 Litton-Reaves Hall (0343)
Blacksburg, VA 24061

Allen Wysocki

12205 SW 9th Ave
Newberry, FL 32611

Elizabeth Yakes

University of New Mexico
Assistant Professor of
Nutrition
MSC05 3040
1 University of New Mexico
Albuquerque, NM 87131

Liyun Ye

2721 Chelsea Court
Blacksburg, VA 24060

Sarah Young

Delaware Valley College
Assistant Professor of Large
Animal Sci.
700 E. Butler Avenue
Doylestown, PA 18901

Pete Ziegler

Virginia Tech
Research Assistant Professor
1060 Litton-Reaves Hall (0334)
Blacksburg, VA 24061

Martin Zuidhof

University of Alberta
Associate Professor
410 Agric/Forestry Centre
Edmonton, AB T6G 2P5

Tuesday, June 25, 2013

12:00 – 7:00 p.m.	Registration Open
1:00 – 4:00 p.m.	NACTA Executive Committee Meeting NIFA/DOCE Meeting Pre-Conference Professional Development Experience
6:00 – 9:00 p.m.	Taste of Virginia Opening Reception

Wednesday, June 26, 2013

7:00 – 10:00 a.m.	Registration Open
7:30 – 8:00 a.m.	Continental Breakfast
8:00 – 9:30 a.m.	Welcome and Keynote
9:30 – 10:30 a.m.	Poster Session and Break
10:30 a.m. – 12:00 p.m.	Concurrent Sessions
12:00 – 1:30 p.m.	Lunch
2:00 – 3:30 p.m.	Concurrent Sessions
3:30 – 4:30 p.m.	Poster Session and Break
5:30 – 8:00 p.m.	BBQ at "The Grove"

Thursday, June 27, 2013

7:00 a.m. – Noon	Registration Open
7:30 – 8:00 a.m.	Continental Breakfast
8:00 – 9:30 a.m.	Blue Ribbon Presentation
9:30 – 10:30 a.m.	Poster Session and Break
10:30 a.m. – 12:00 p.m.	Concurrent Sessions
11:45 – 12:15 p.m.	Lunch
12:00 – 12:15 p.m.	Board buses for tours, departing at 12:15 p.m.
12:15 – 5:15 p.m.	Tours
5:15 p.m.	Dinner on your own

Friday, June 28, 2013

7:00 – 9:00 a.m.	Registration Open
7:30 – 8:00 a.m.	Continental Breakfast
8:30 – 9:30 a.m.	Committee Meetings
9:30 – 10:30 a.m.	Poster Session and Break
10:30 a.m. – 12:00 p.m.	Concurrent Sessions
12:00 – 2:00 p.m.	Lunch & Business Meeting
2:00 – 4:00 p.m.	Workshops
5:30 – 6:30 p.m.	Registration Open
6:00 – 9:00 p.m.	Banquet

Saturday, June 29, 2013

7:00 – 8:00 a.m.	NACTA Executive Committee Breakfast
8:00 – 11:00 a.m.	NACTA Executive Committee Meeting

Please deliver a jump drive with oral presentations to the registration desk on Tuesday, June 25 (Noon to 7:00 p.m.). Presentations will be pre-loaded onto your session's laptop.