

Amazing Orientation

Dr. K. Jogan & Dr. K. Johnson

NACTA 2015



UNIVERSITY OF
ARKANSAS®

Benefits of Orientation

- Orientation Strongly linked to **retention**
- Awareness of services increases **retention**
- Sense of belonging increases satisfaction & **retention**
- Forum to meet other students increases chances of **success**
- Connections with department, campus, community

Departmental Level Must do MORE

Creative Orientation increases participation in departmental activities and organizations leading to **RETENTION**

Connections



Objective

- ▶ Design and implement a departmental *amazing orientation* game.



Population/ Methodology

- ▶ IRB approved
- ▶ 94 undergraduates
- ▶ Randomly assigned

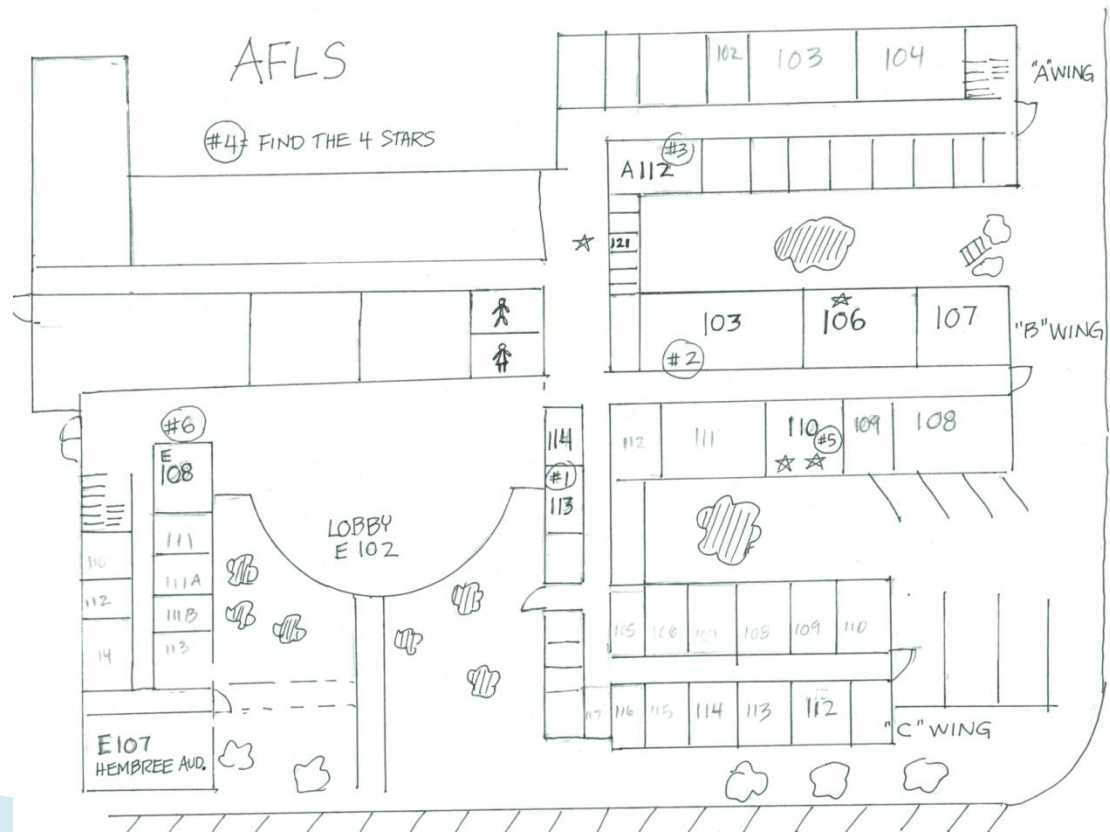

Implementation

- ▶ Classroom
- ▶ List of destination specific tasks







Tools for Educators - free printable word search maker
www.toolsforeducators.com

Word Search

Tools For Educators

ODRLZNHADLEY
 BXPLINDAOKBF
 GVFNNGQOATHNF
 TJJEANIEJAVS
 HZARWCRHCLFJ
 ZUYEAZEWFIJA
 CVGPDPCJTJSJ
 DTEOVADOWAXY
 GNEOISOHNMA
 INRLFSKIONQV
 LDKUMNNRJOIV
 FLANNAIDBTQE

Dr. Looper's Administrative Assistant First name of Secretary in B-103 First name of Secretary in B-110 Accountant

In charge of Information Desk Dean of AFLS ANSC Dept. Head First name of Secretary in B-106

Tools For Educators - Free Worksheets For Educators

<http://www.toolsforeducators.com/wordsearch/getResult.php>

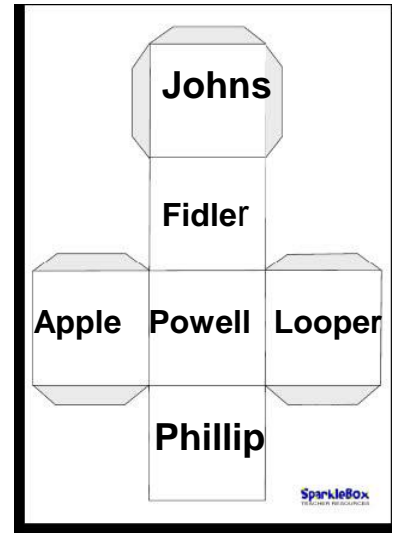

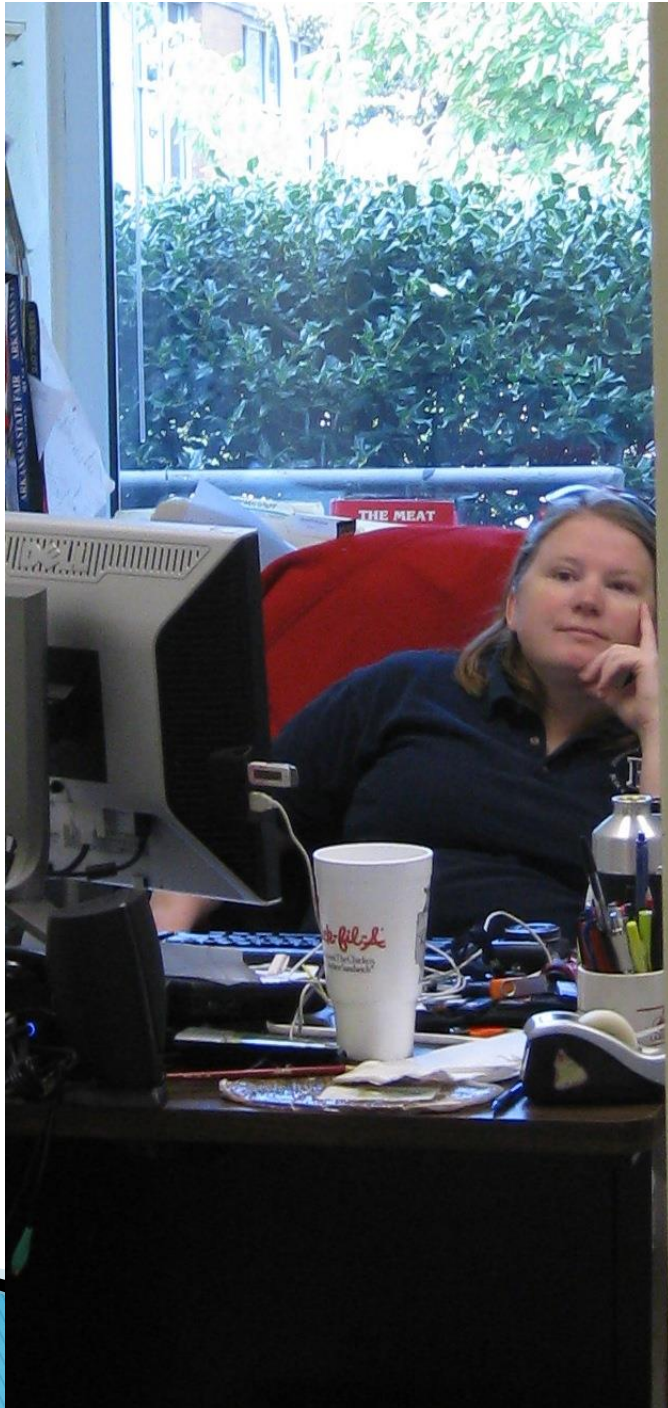

- Meet new people
- Travel to professional 'meat'ing in North Dakota

Informational 'meat'ing

Friday, Dec 9

12:00 Noon

AFLS B111 Conference Room

PIZZA

Or Contact Janeal Yancey 575-4115

jws09@uark.edu

ANSC Lab

#4: Take one of the white stars
below and put it by Dr.
Yancey's name

(B&B advisor/Meats Quiz Bowl)

One-minute activities recorded

Name: Wynn

Stop # 1 Student Lounge

Part 1: Answer the following

1. Is there a microwave in the lounge? Yes
2. What does AFLS stand for? Animal Food & Life Science
3. Is there a place that I can sit down and study with my friends? Yes

Part 2: Take a picture of your group in front of Pepsi machine and text to 479-236-4768

*** Stop # 2: Faculty and research interest:**

Go to B-103. Read the handout, ask Linda Jones for next task. Fill in your answer below:

Professor: Coffee Area of Expertise: Ruminant Nutrition

Stop # 3: Departmental (AFLS) webpage

Go to the computer lab and print a copy of the first page of the AFLS website. Bring it with you!

Stop # 4: Club Advisors:

(1) Fill in the Advisor's names for the various clubs/groups below:

(2) Go to their office doors, and follow directions.

Pre-Vet (B110-C): Powell Block and Bridle (B-110E): Kesley

Meats Quiz Bowl (B-121): Yancy Judging Team Coach (B-106-B): Katz

Stop # 5:

Go B-110. Ask Kahlisa Kitz for next assignment. When completed, have Khalisa sign it. Bring it with you.

Dean's office. Pick up a piece of candy from the fishbowl, get an

Area: Bumper's College Deans Office:
Major: ANSC Major or Minor
Hours: 9:00-5:00

Lounge? Yes
Animal Food Life Science
own and study with my friends? Yes
front of Pepsi machine and text to 479-236-4768

Part 2:

1. Jones for next task. Fill in your answer

Area of Expertise: Forage Nutrition

1st page of the AFLS website.

clubs/groups below:

Block and Bridle (B-110E): Beth Kegley

Team Coach (B-106-B): Bryan Katz

When completed, have Khalisa sign it.

fishbowl, get an

Pre-test Post-test

Rate pre/post familiarity (knowledge) on a scale of 1–7, where 1=I don't have a clue; 4=neutral and 7=I am very sure.

Statement	Pre	Post
Location of student lounge and vending areas	3.11	6.77
Faculty office locations	3.60	6.21
Departmental webpage/ computer lab	4.73	6.39
Faculty research areas/ expertise	2.63	5.49
Departmental personnel and functions	2.41	5.45
Student organizations point person	3.05	6.31

Paired *t*-test revealed that post-race average responses were significantly higher than pre-race responses across all questions.

Sample post activity questions

Rated on a 1–7 Likert scale

Statements	Rate 1–7
Enjoyed <i>amazing orientation</i>	6.03
Met new people as a result of activity	6.20
Recommend use in future classes	6.36
Increased comfort level in ANSC post activity	6.27
Better idea of faculty research interests because of activity	5.88

Conclusions

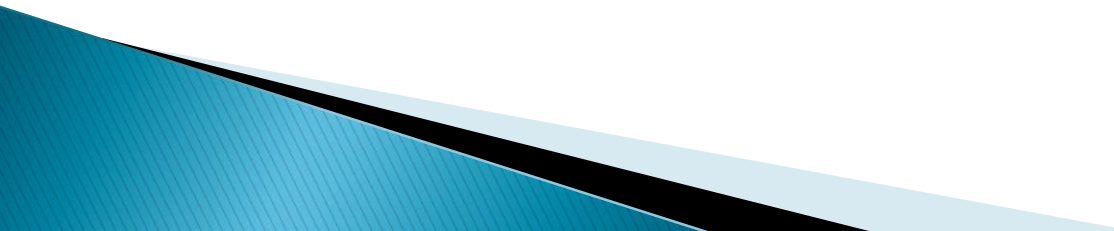
- ▶ Paired t -test revealed that post-race average responses were significantly higher than pre-race responses across all questions.
 - ▶ Students enjoyed activity
 - ▶ Forum to meet other students
 - ▶ Awareness of services, sense of belonging increased
- 

Questions?



Selected References

- ▶ Derby, D. C., & Smith, T. (2004). An orientation course and community college retention. *Community College Journal of Research and Practice*, 28, 763–773
- ▶ Hausmann, L. R., Schofield, J. W., & Woods, R. L. (2012). Sense of belonging as a predictor of intentions to persist among African American and white first year college students. *Research in Higher Education*, 48(7). doi:10.1007/s11162-007-9052-9
- ▶ Lau, L. K. (2003). Institutional factors affecting student retention. *Education*, 124(1), 126–136.
- ▶ O'Gara, L., Karp, M., & Hughes, K. L. (2009). An Exploratory Study of Student Perspectives. *Community College Review*, 36(3), 195–218.